

MPF PRODUCTS INC.

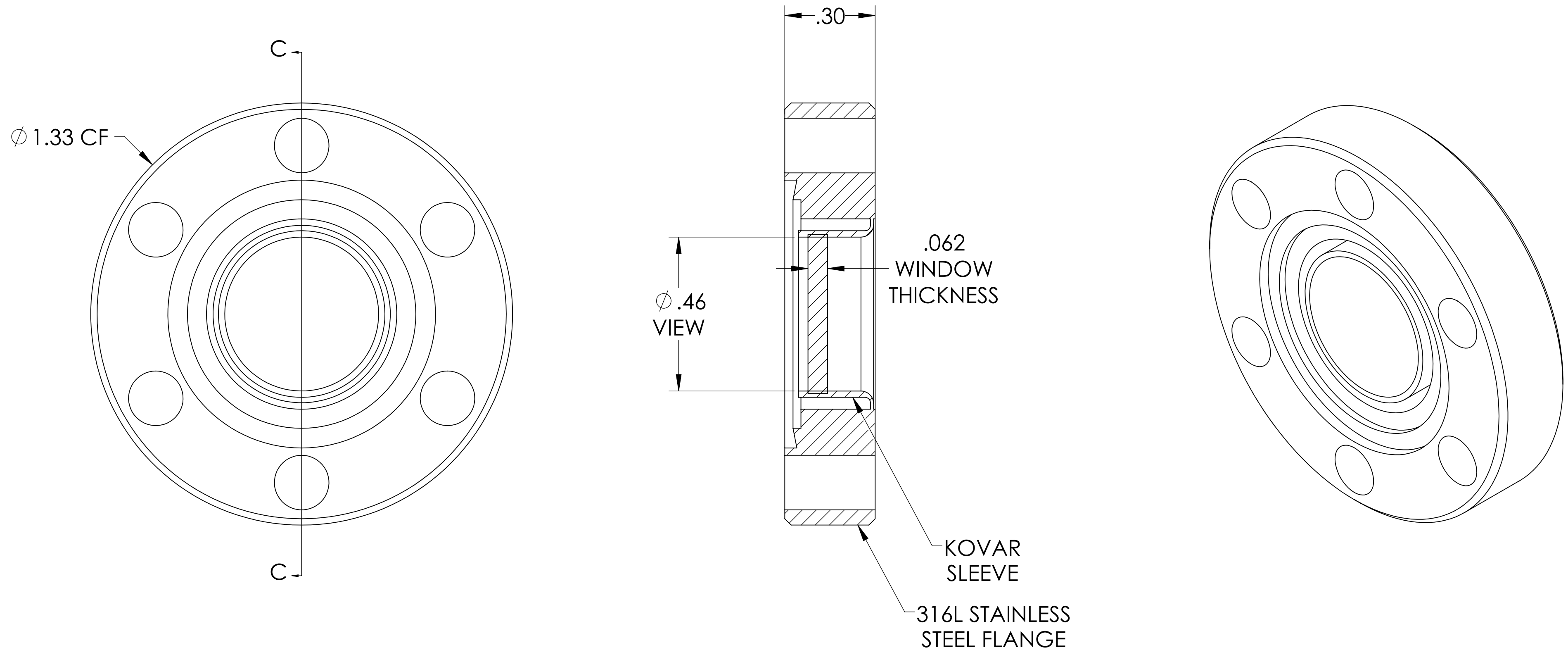

SPECIFICATIONS:

1. MATERIAL: SAPPHIRE
2. TWD <math>< 8\lambda</math> @ 632nm (PEAK TO VALLEY)
3. PARALLELISM <math>< 3</math> ARC-MINUTES
4. SURFACE FINISH: 50-20 SCRATCH-DIG
5. THERMAL RANGE: -100 °C TO 450 °C
6. ORIENTATION: RANDOM
7. LEAK RATE <math>< 1 \times 10^{-9}</math> ATM CC/SEC HE

UV Grade Sapphire Viewport, 0.46" View Dia, 1.33" Conflat Flange

UNLESS OTHERWISE SPECIFIED:		QUOTATION #		N/A	
DIMENSIONS ARE IN INCHES TOLERANCES:		DRAWN	WJ	DATE	9/11/2015
ANGULAR: MACH ± 1/2°		CHECKED	WJ	DATE	9/11/2015
TWO PLACE DECIMAL ± .030		ENG APPR.	WJ	DATE	9/11/2015
THREE PLACE DECIMAL ± .015		THIRD ANGLE:			
MATERIAL					
FINISH		APPLICATION			
PLATING		NEXT ASSY USED ON			
SURFACE FINISH: 63 OR BETTER		TITLE:			
UNLESS OTHERWISE SPECIFIED:		VIEWPORT, SAPPHIRE, UV, 0.5" VIEW, 133 CF			
ALL DIAMETERS CONCENTRIC WITHIN .005. REMOVE ALL BURRS AND SHARP EDGES		DOWNLOADED FROM MPFPI.COM			
		DWG. NO.		REV	
		A1858-1-CF			
		Thursday, January 24, 2019 11:03:57 AM			