

# MPF PRODUCTS INC.

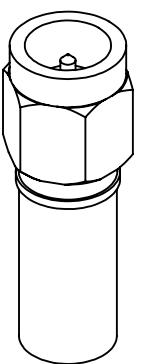
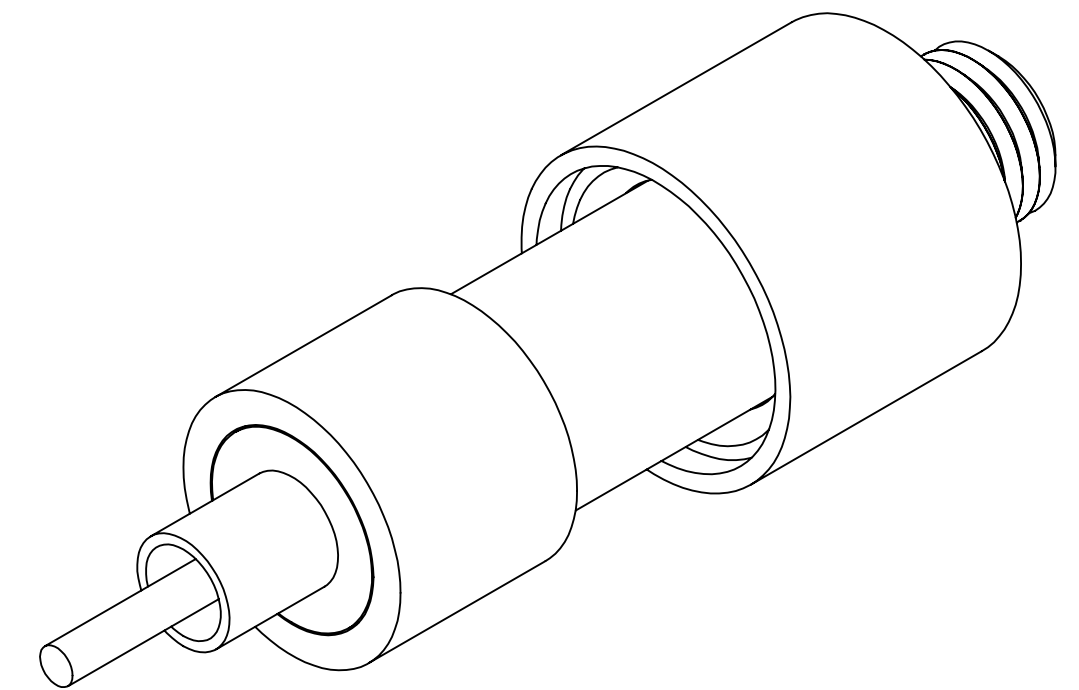
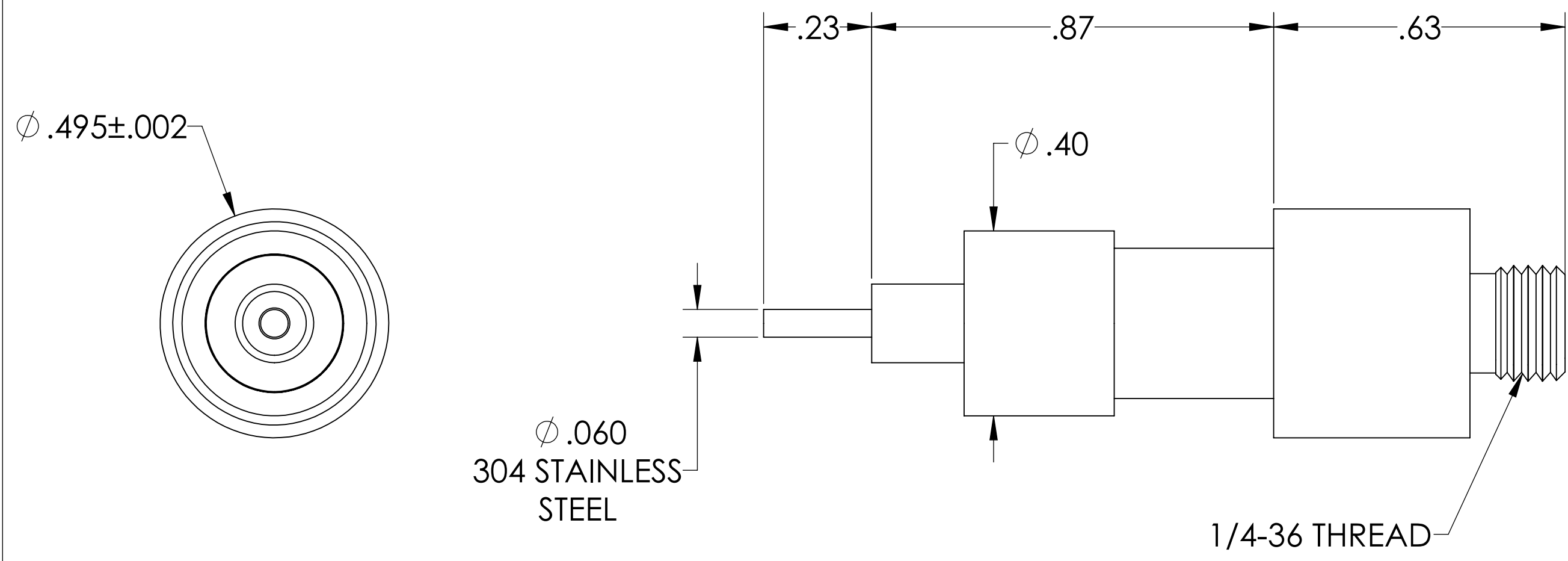

PART #	AIRSIDE CONNECTOR INCLUDED
A1908-1-W	YES
A1908-2-W	NO

**NOTE:**

1. SHIELD: GROUNDING
2. VOLTAGE: 700 VOLTS DC
3. CURRENT: 1 AMP
4. TEMPERATURE RATING: -200 TO 450°C (FEEDTHROUGH), 65 TO 165°C ( AIRSIDE CONNECTOR)
5. IMPEDANCE: 50 OHM

SMA Coaxial Feedthrough, 50 Ohm 1 Pin, Grounded Shield, 0.495" Dia SS Weld Adapter, UHV Compatible

UNLESS OTHERWISE SPECIFIED:	QUOTATION #	N/A
DIMENSIONS ARE IN INCHES TOLERANCES:	NAME	DATE
ANGULAR: MACH $\pm 1/2^\circ$	WJ	9/11/2015
TWO PLACE DECIMAL $\pm .030$	CHECKED	9/11/2015
THREE PLACE DECIMAL $\pm .015$	ENG APPR.	WJ 9/11/2015
MATERIAL	THIRD ANGLE:	
	APPLICATION	
	NEXT ASSY	USED ON
FINISH	SURFACE FINISH:	63 OR BETTER
PLATING	UNLESS OTHERWISE SPECIFIED:	
	ALL DIAMETERS CONCENTRIC WITHIN .005.	REMOVE ALL BURRS AND SHARP EDGES
	TITLE:	MPF PRODUCTS INC.
		SMA COAXIAL FEEDTHROUGH, 50 OHM, 1 PIN, GROUNDING SHIELD, 0.495" DIA SS WELD ADAPTER
	DOWNLOADED FROM MPFPI.COM	
	DWG. NO.	A1908
	REV	
	Friday, January 18, 2019 9:15:57 AM	