

MPF PRODUCTS INC.

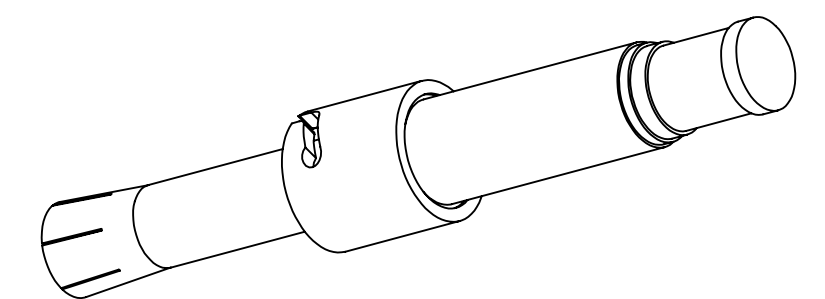
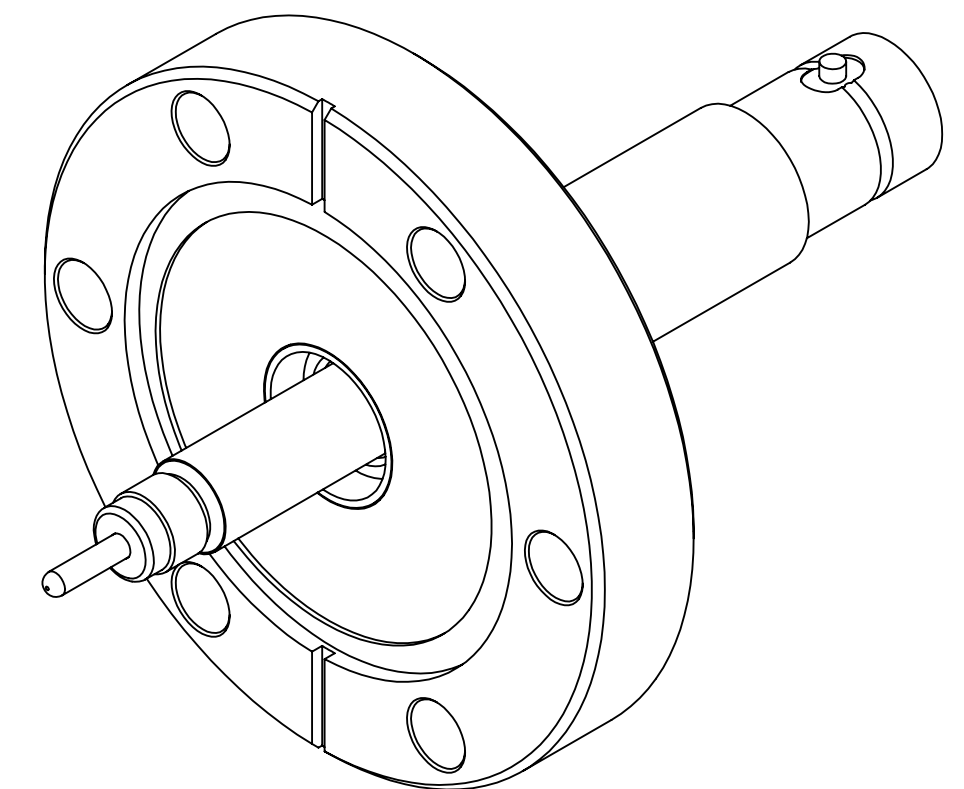
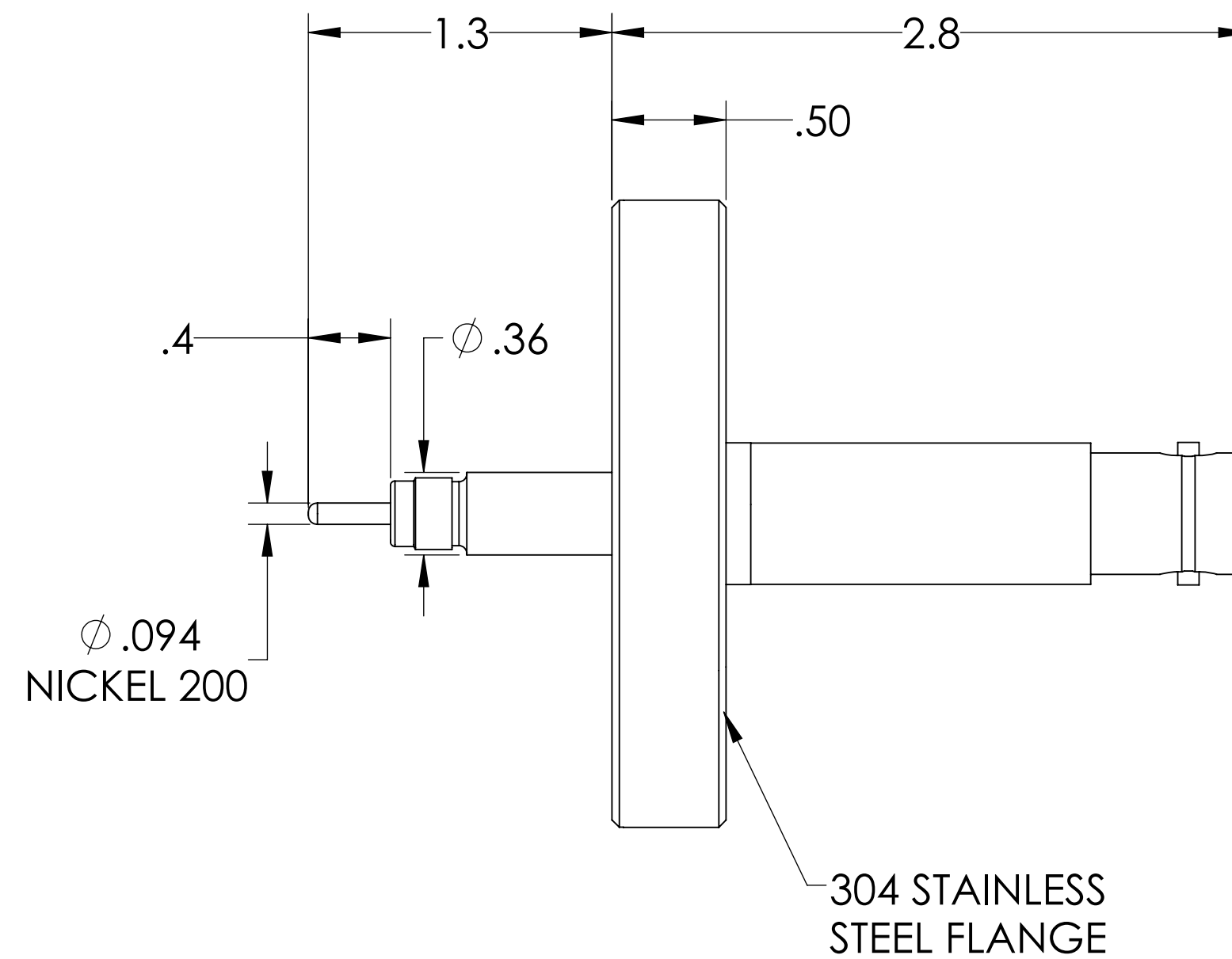
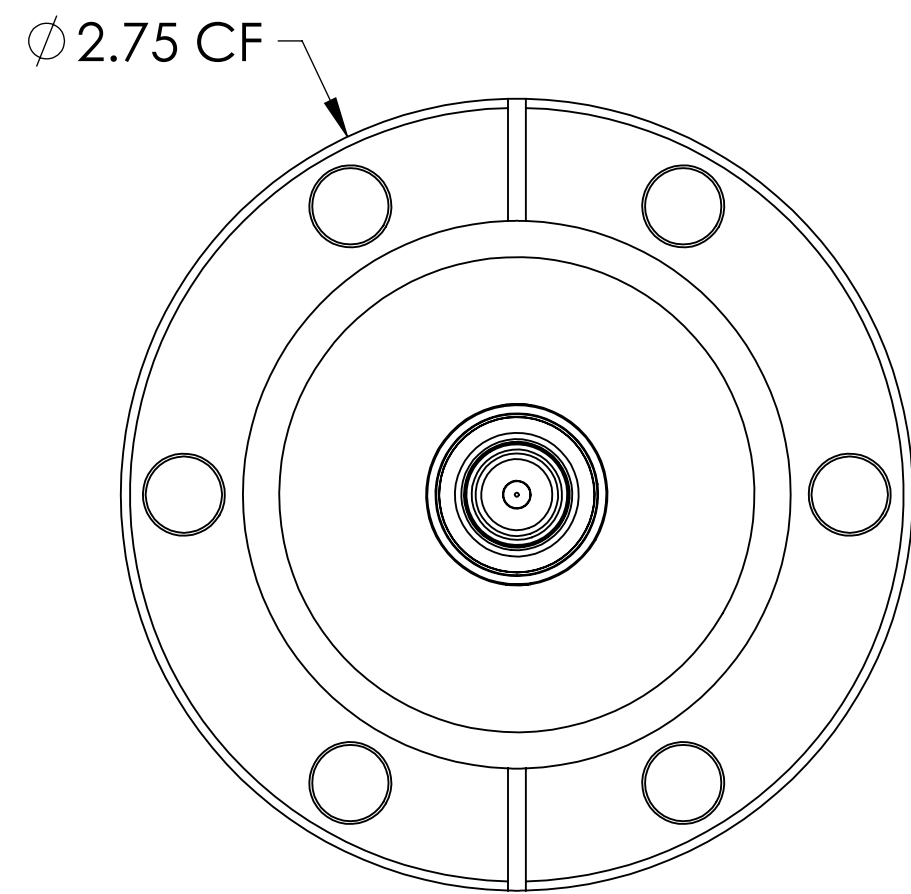

| PART # | AIRSIDE CONNECTOR INCLUDED |
|------------|----------------------------|
| A1909-1-CF | YES |
| A1909-2-CF | NO |

NOTE:

1. SHIELD: GROUNDED
2. VOLTAGE: 20,000 VOLTS DC
3. CURRENT: 15 AMPS
4. TEMPERATURE RATING: -200 TO 450°C (FEEDTHROUGH), 65 TO 165°C (AIRSIDE CONNECTOR)
5. IMPEDANCE: NON-CONSTANT

SHV-20 Coaxial Feedthrough, 1 Pin, Grounded Shield, Exposed Insulator, 2.75" Conflat Flange, UHV Compatible

| | | |
|---|---|---|
| UNLESS OTHERWISE SPECIFIED: | QUOTATION # | N/A |
| DIMENSIONS ARE IN INCHES TOLERANCES: | NAME | DATE |
| ANGULAR: MACH ± 1/2° | WJ | 9/11/2015 |
| TWO PLACE DECIMAL ± .030 | CHECKED | 9/11/2015 |
| THREE PLACE DECIMAL ± .015 | ENG APPR. | WJ 9/11/2015 |
| MATERIAL | THIRD ANGLE: | |
| | APPLICATION | |
| | NEXT ASSY | USED ON |
| FINISH | SURFACE FINISH: | 63 OR BETTER |
| PLATING | UNLESS OTHERWISE SPECIFIED: | |
| | ALL DIAMETERS CONCENTRIC WITHIN .005. REMOVE ALL BURRS AND SHARP EDGES | |
| | TITLE: | SHV-20 COAXIAL FEEDTHROUGH, 1 PIN, GROUNDED SHIELD, EXPOSED, 2.75" CONFLAT FLANGE |
| | DOWNLOADED FROM MPFPI.COM | |
| | DWG. NO. | A1909 |
| | REV | |
| | Friday, January 18, 2019 9:14:32 AM | |