

MPF PRODUCTS INC.

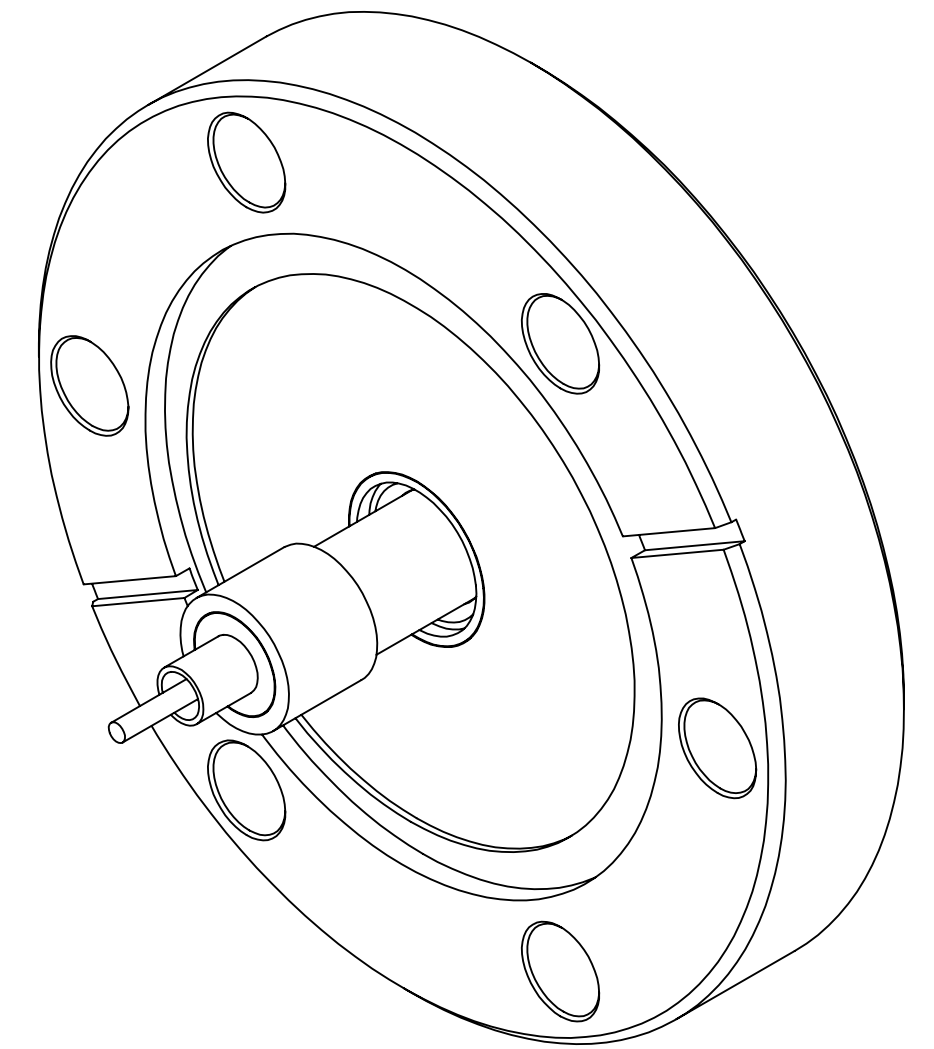

PART #	AIRSIDE CONNECTOR INCLUDED
A1910-1-CF	YES
A1910-2-CF	NO

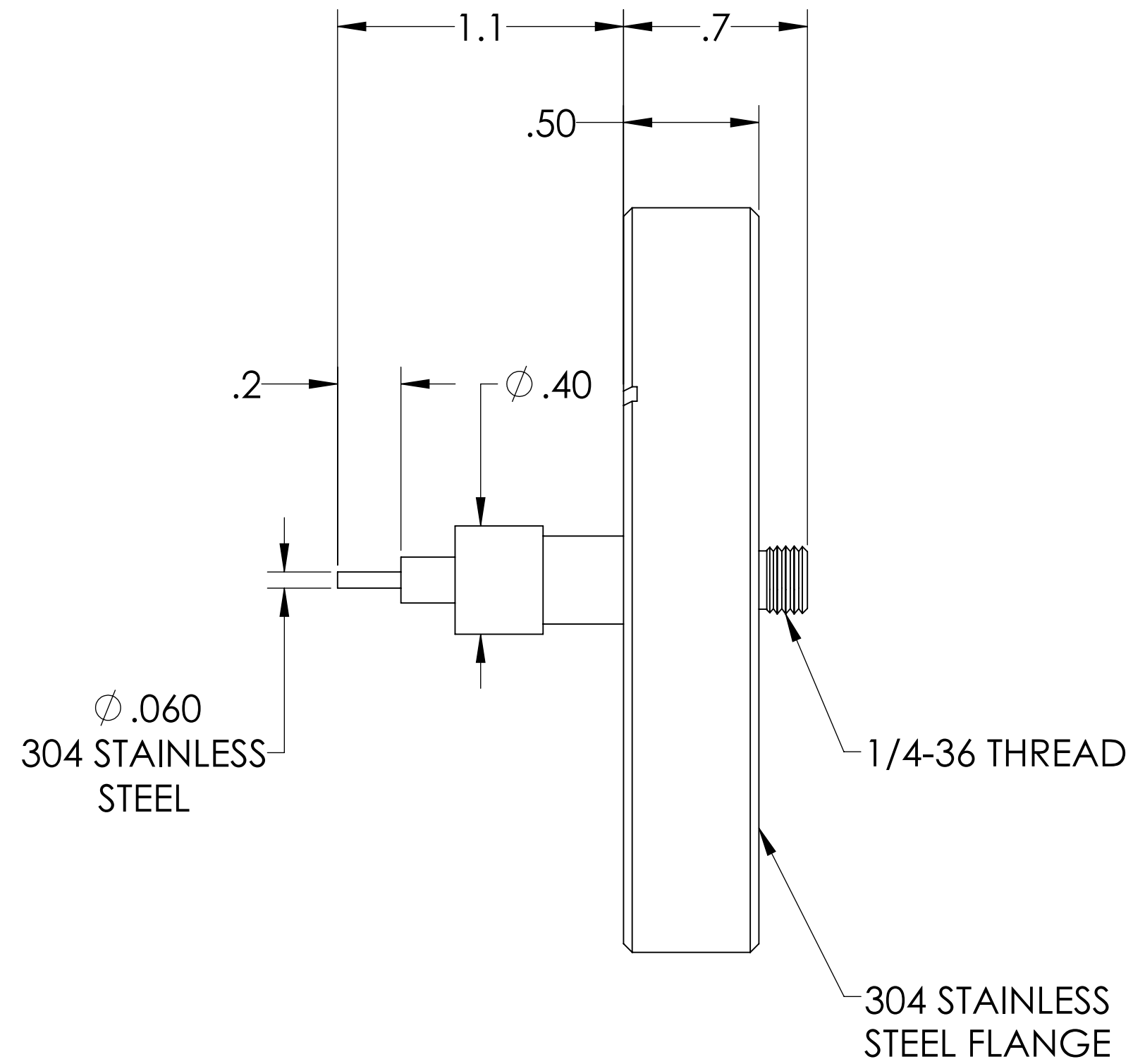
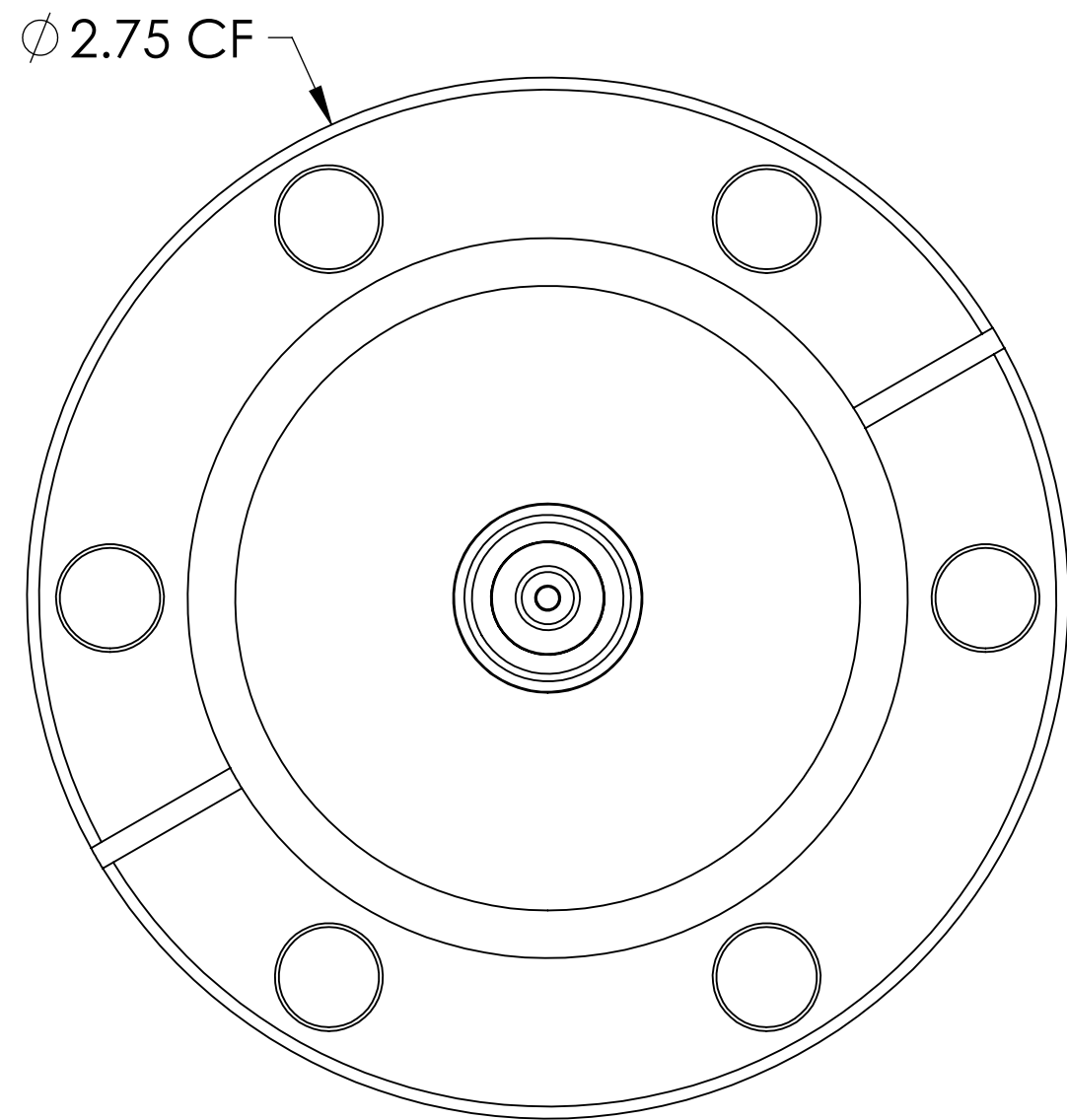
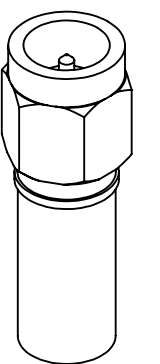

NOTE:

1. SHIELD: GROUNDED
2. VOLTAGE: 700 VOLTS DC
3. CURRENT: 1 AMP
4. TEMPERATURE RATING: -200 TO 450°C (FEEDTHROUGH), 65 TO 165°C (AIRSIDE CONNECTOR)
5. IMPEDANCE: 50 OHM

SMA Coaxial Feedthrough, 50 Ohm 1 Pin, Grounded Shield, 2.75" Conflat Flange, UHV Compatible

UNLESS OTHERWISE SPECIFIED:	QUOTATION #	N/A	
DIMENSIONS ARE IN INCHES TOLERANCES:	DRAWN	NAME	DATE
ANGULAR: MACH ± 1/2°	WJ	WJ	9/11/2015
TWO PLACE DECIMAL ± .030	CHECKED		9/11/2015
THREE PLACE DECIMAL ± .015	ENG APPR.	WJ	9/11/2015
MATERIAL	THIRD ANGLE:		
FINISH	APPLICATION	SMA COAXIAL FEEDTHROUGH, 50 OHM, 1 PIN, GROUNDED SHIELD, 2.75" CONFLAT FLANGE	
PLATING	NEXT ASSY	USED ON	DOWNLOAD FROM MPFPI.COM DWG. NO.
	SURFACE FINISH:	63/ OR BETTER	A1910 REV
	UNLESS OTHERWISE SPECIFIED:	ALL DIAMETERS CONCENTRIC WITHIN .005. REMOVE ALL BURRS AND SHARP EDGES	
		Friday, January 18, 2019 9:12:29 AM	