

MPF PRODUCTS INC.

Ø "A" DIM CF

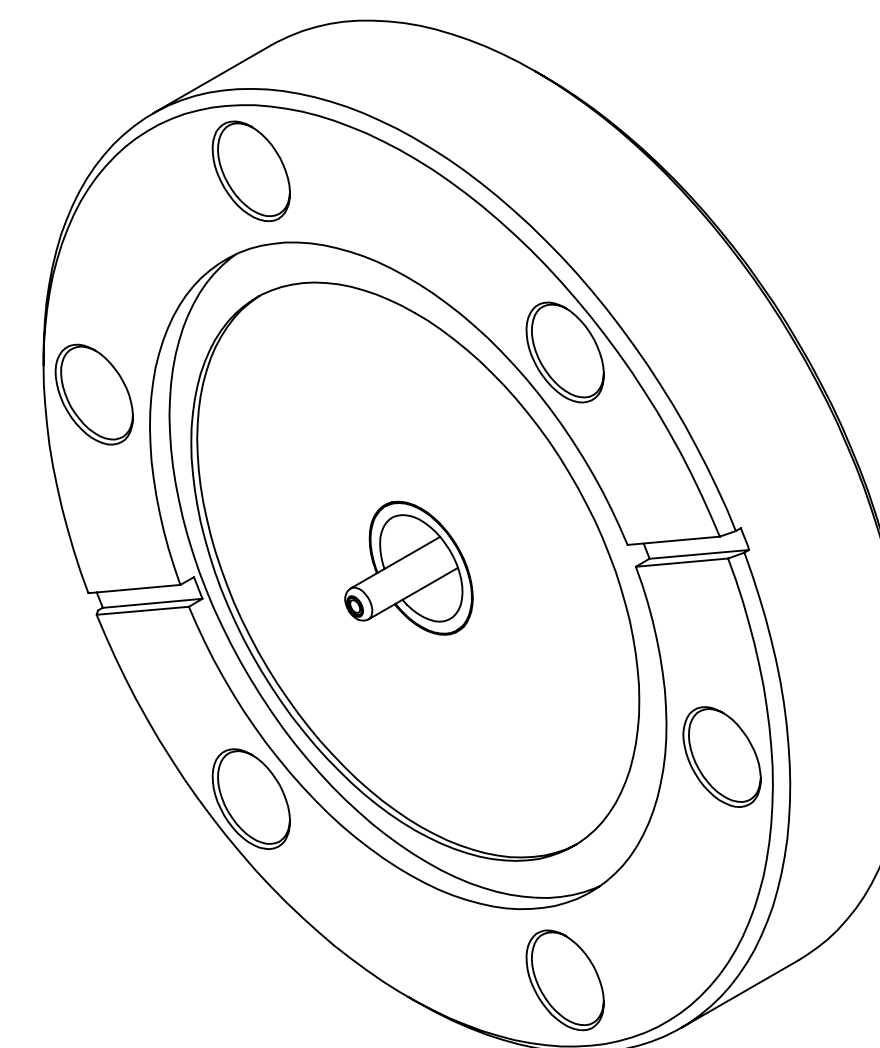

PART #	"A" DIM	AIRSIDE CONNECTOR INCLUDED
A1911-1-CF	2.75	YES
A1911-2-CF	1.33	YES
A1911-3-CF	2.75	NO
A1911-4-CF	1.33	NO

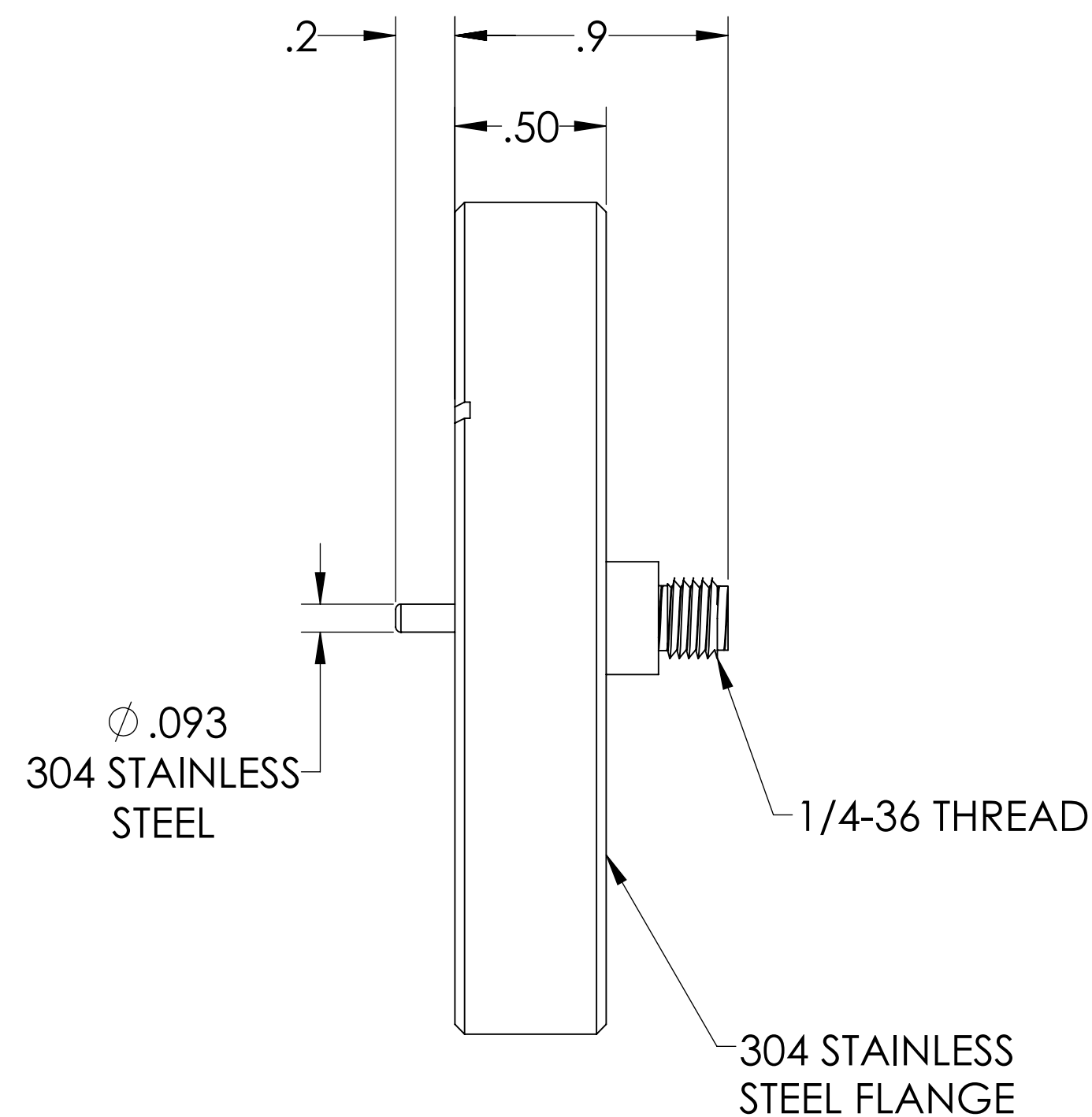
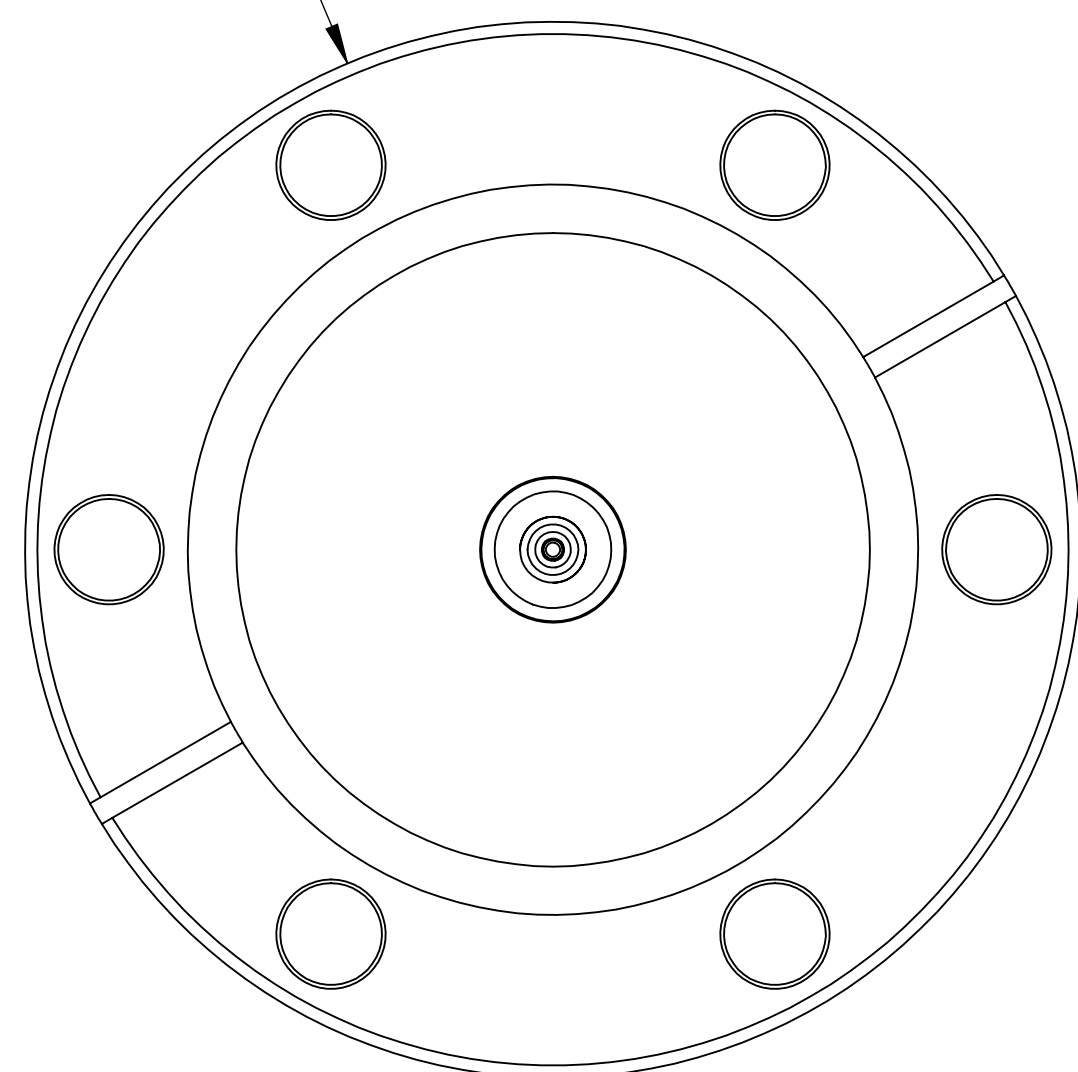
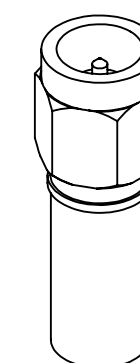

NOTE:

1. SHIELD: GROUNDING
2. VOLTAGE: 700 VOLTS DC
3. CURRENT: 1 AMP
4. TEMPERATURE RATING: -200 TO 450°C (FEEDTHROUGH), 65 TO 165°C (AIRSIDE CONNECTOR)
5. IMPEDANCE: 50 OHM

SMA Coaxial Feedthrough, 50 Ohm 1 Pin, Grounded Shield, Conflat Flange, UHV Compatible

UNLESS OTHERWISE SPECIFIED:		QUOTATION #		N/A	
DIMENSIONS ARE IN INCHES TOLERANCES:		NAME	DATE	MPF PRODUCTS INC.	
ANGULAR: MACH ± 1/2°		DRAWN	9/11/2015		
TWO PLACE DECIMAL ± .030		CHECKED	9/11/2015		
THREE PLACE DECIMAL ± .015		ENG APPR.	9/11/2015		
MATERIAL		THIRD ANGLE:		TITLE: SMA COAXIAL FEEDTHROUGH, 50 OHM, 1 PIN, GROUNDING SHIELD, CONFLAT FLANGE	
APPLICATION					
NEXT ASSY		USED ON			
FINISH		SURFACE FINISH: 63 OR BETTER		DOWNLOADED FROM MPFPI.COM	
PLATING		UNLESS OTHERWISE SPECIFIED:		DWG. NO. A1911	
		ALL DIAMETERS CONCENTRIC WITHIN .005. REMOVE ALL BURRS AND SHARP EDGES		REV	
		Friday, January 18, 2019 9:10:56 AM			