

# MPF PRODUCTS INC.

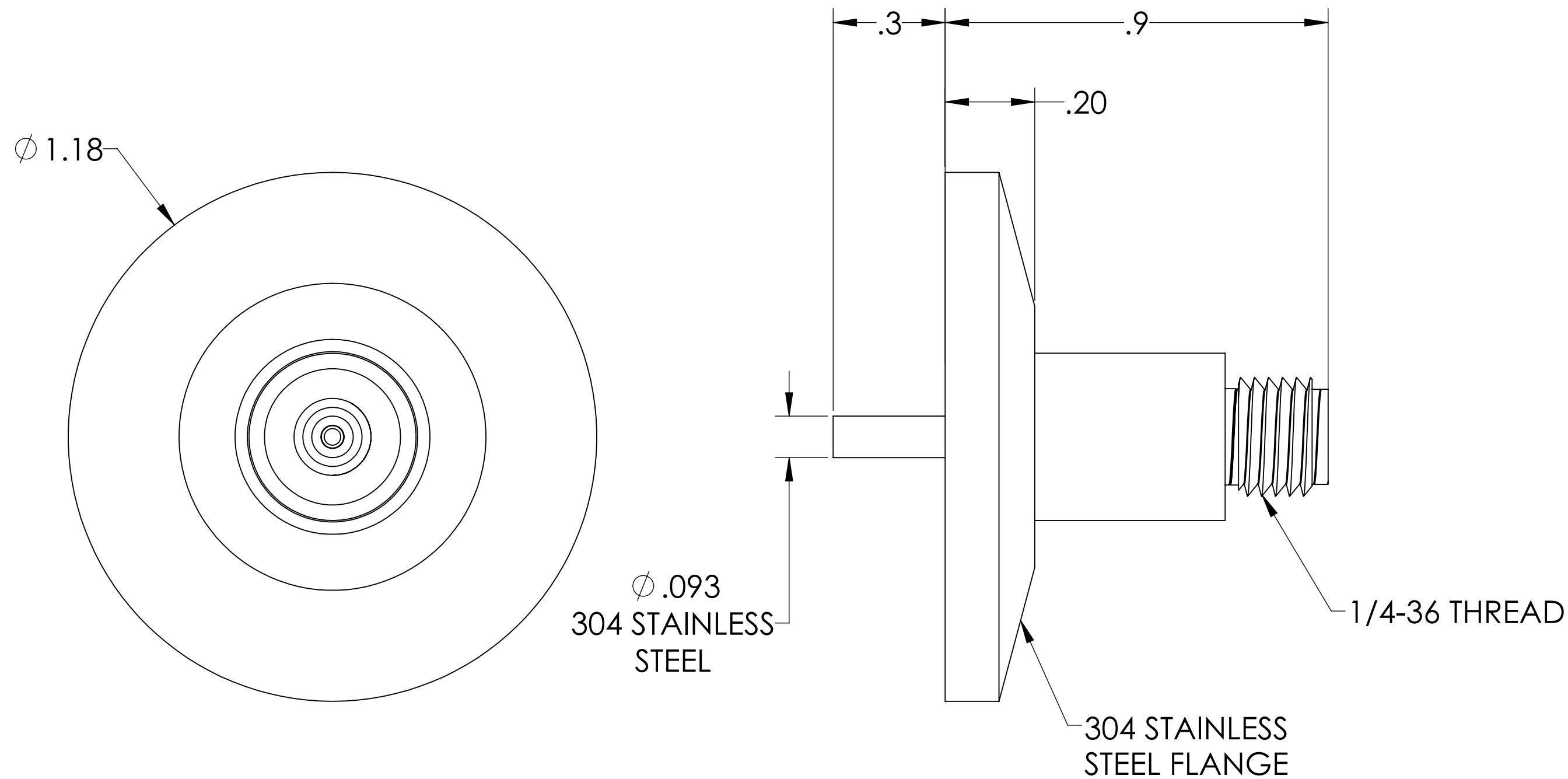

PART #	AIRSIDE CONNECTOR INCLUDED
A1920-1-QF	YES
A1920-2-QF	NO

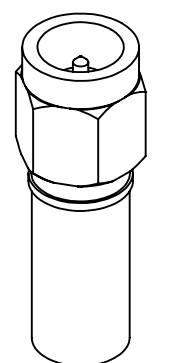

**NOTE:**

1. SHIELD: GROUNDED
2. VOLTAGE: 700 VOLTS DC
3. CURRENT: 1 AMP
4. TEMPERATURE RATING: -200 TO 450°C (FEEDTHROUGH), 65 TO 165°C ( AIRSIDE CONNECTOR)
5. IMPEDANCE: 50 OHM

SMA Coaxial Feedthrough, 50 Ohm 1 Pin, Grounded Shield, 1.18" QF/KF, UHV Compatible

UNLESS OTHERWISE SPECIFIED:	QUOTATION #	N/A
DIMENSIONS ARE IN INCHES TOLERANCES:	NAME	DATE
ANGULAR: MACH $\pm 1/2^\circ$	DRAWN	9/11/2015
TWO PLACE DECIMAL $\pm .030$	CHECKED	9/11/2015
THREE PLACE DECIMAL $\pm .015$	ENG APPR.	9/11/2015
MATERIAL	THIRD ANGLE:	
FINISH	APPLICATION	
PLATING	NEXT ASSY	USED ON
	SURFACE FINISH:	$\sqrt{63}$ OR BETTER
	UNLESS OTHERWISE SPECIFIED:	
	ALL DIAMETERS CONCENTRIC WITHIN .005.	
	REMOVE ALL BURRS AND SHARP EDGES	
	TITLE:	MPF PRODUCTS INC.
		SMA COAXIAL FEEDTHROUGH, 50 OHM, 1 PIN, GROUNDED SHIELD, 1.18" QF/KF
	DOWNLOADED FROM MPFPI.COM	
	DWG. NO.	A1920
	REV	
	Friday, January 18, 2019 9:09:49 AM	