

MPF PRODUCTS INC.

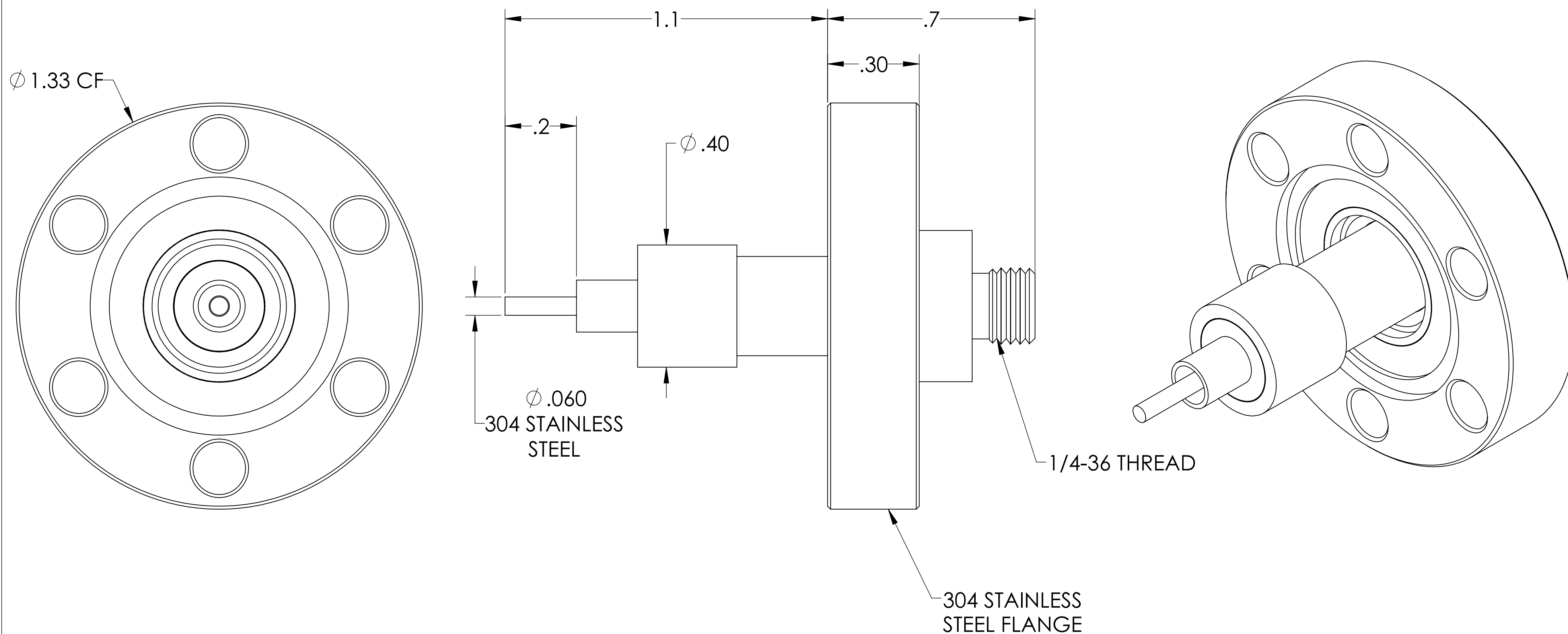

PART #	AIRSIDE CONNECTOR INCLUDED
A1921-1-CF	YES
A1921-2-CF	NO

NOTE:

1. SHIELD: GROUNDED
2. VOLTAGE: 700 VOLTS DC
3. CURRENT: 1 AMP
4. TEMPERATURE RATING: -200 TO 450°C (FEEDTHROUGH), 65 TO 165°C (AIRSIDE CONNECTOR)
5. IMPEDANCE: 50 OHM

SMA Coaxial Feedthrough, 50 Ohm 1 Pin, Grounded Shield, 1.33" Conflat Flange, UHV Compatible

UNLESS OTHERWISE SPECIFIED:	QUOTATION #	N/A	
DIMENSIONS ARE IN INCHES TOLERANCES:	DRAWN	NAME	DATE
ANGULAR: MACH ± 1/2°	WJ	WJ	9/11/2015
TWO PLACE DECIMAL ± .030	CHECKED		9/11/2015
THREE PLACE DECIMAL ± .015	ENG APPR.	WJ	9/11/2015
MATERIAL	THIRD ANGLE:		
FINISH	APPLICATION	NEXT ASSY USED ON	
PLATING	SURFACE FINISH:	63/ OR BETTER	
	UNLESS OTHERWISE SPECIFIED:	ALL DIAMETERS CONCENTRIC WITHIN .005. REMOVE ALL BURRS AND SHARP EDGES	
	TITLE:	SMA COAXIAL FEEDTHROUGH, 50 OHM, 1 PIN, GROUNDED SHIELD, 1.33" CONFLAT FLANGE	
	DOWNLOADED FROM MPFPI.COM		
	DWG. NO.	A1921	
	REV		
	Friday, January 18, 2019 9:09:26 AM		