

MPF PRODUCTS INC.

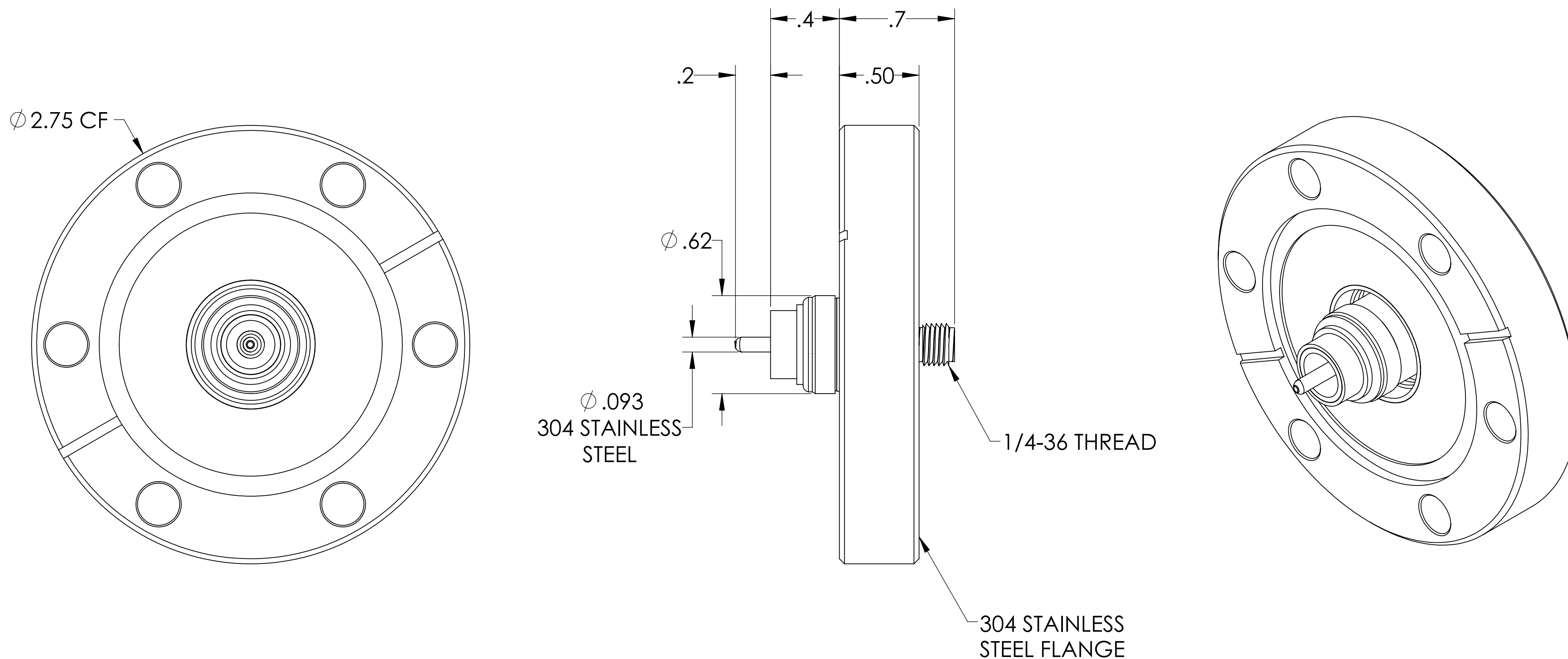

PART #	AIRSIDE CONNECTOR INCLUDED
A1983-1-CF	YES
A1983-2-CF	NO

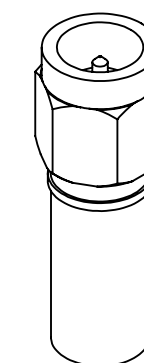

NOTE:

1. SHIELD: FLOATING
2. VOLTAGE: 2500 VOLTS DC SHIELD TO GROUND, 700V PIN TO SHEILD
3. CURRENT: 1 AMP
4. TEMPERATURE RATING: -200 TO 450°C (FEEDTHROUGH), 65 TO 165°C (AIRSIDE CONNECTOR)
5. IMPEDANCE: NON-CONSTANT

SMA Coaxial Feedthrough, 1 Pin, Floating Shield, Double Ended, 2.75" Conflat Flange, UHV Compatible

UNLESS OTHERWISE SPECIFIED:	QUOTATION #	N/A
DIMENSIONS ARE IN INCHES TOLERANCES:	NAME	DATE
ANGULAR: MACH ± 1/2°	WJ	9/11/2015
TWO PLACE DECIMAL ± .030	CHECKED	9/11/2015
THREE PLACE DECIMAL ± .015	ENG APPR.	WJ 9/11/2015
MATERIAL	THIRD ANGLE:	
	APPLICATION	
	NEXT ASSY	USED ON
FINISH	SURFACE FINISH:	63 OR BETTER
PLATING	UNLESS OTHERWISE SPECIFIED:	
	ALL DIAMETERS CONCENTRIC WITHIN .005. REMOVE ALL BURRS AND SHARP EDGES	
TITLE:		MPF PRODUCTS INC.
SMA COAXIAL FEEDTHROUGH, 1 PIN, FLOATING SHIELD, DOUBLE ENDED, 2.75" CONFLAT FLANGE		DOWNLOADED FROM MPFPI.COM
DWG. NO.		A1983
REV		
Friday, January 18, 2019 10:33:16 AM		