

# MPF PRODUCTS INC.

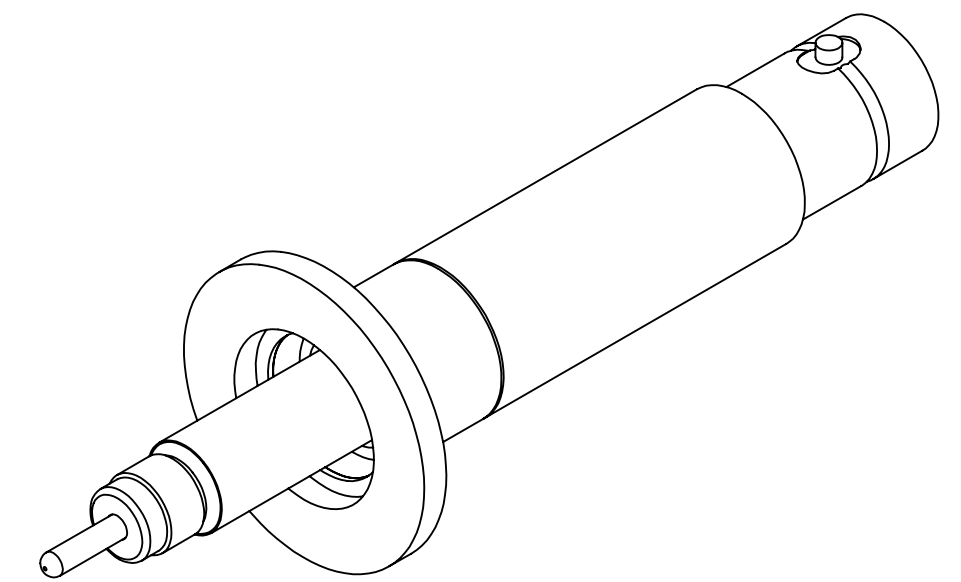

PART #	"A" DIM	"B" DIM	$\phi$ "C" DIM	AIRSIDE CONNECTOR INCLUDED
A2094-1-QF	2.85	1.27	1.18	YES
A2094-2-QF	2.75	1.37	2.16	YES
A2094-3-QF	2.85	1.27	1.18	NO
A2094-4-QF	2.75	1.37	2.16	NO

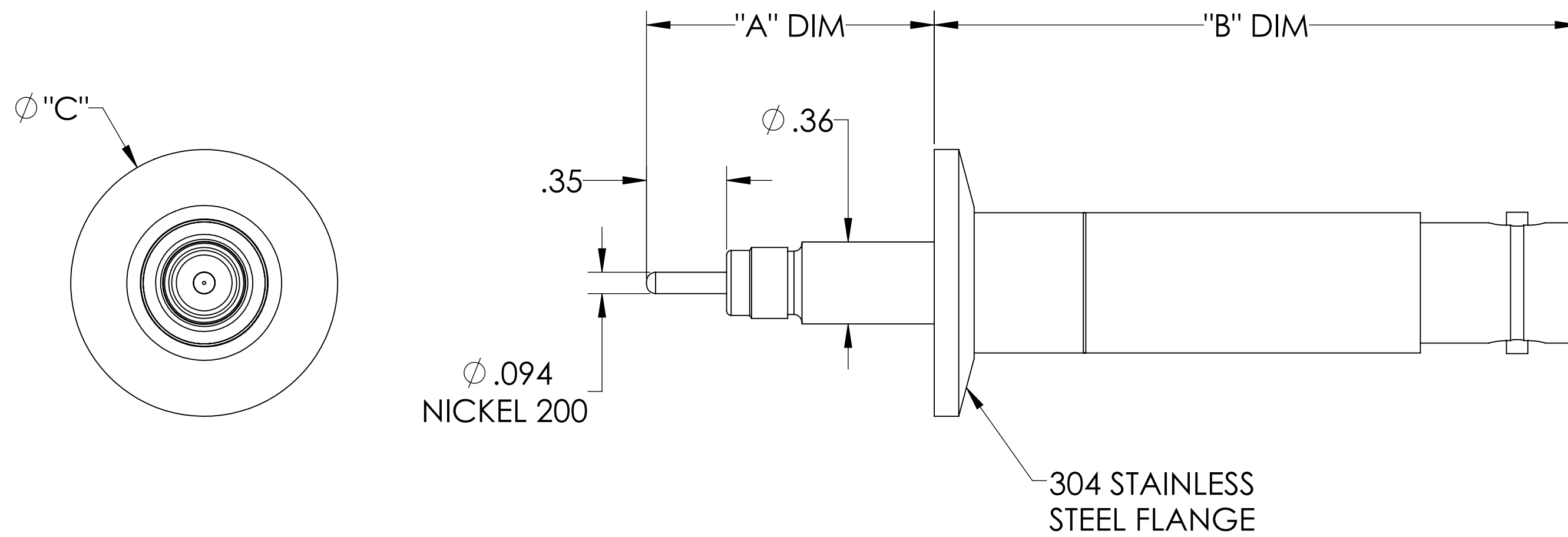
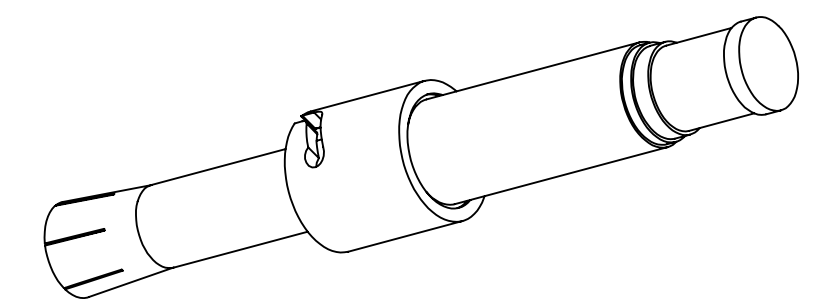

NOTE:

1. SHIELD: GROUNDED
2. VOLTAGE: 20,000 VOLTS DC
3. CURRENT: 15 AMP
4. TEMPERATURE RATING: -200 TO 450°C (FEEDTHROUGH), 65 TO 165°C ( AIRSIDE CONNECTOR)
5. IMPEDANCE: NON-CONSTANT

SHV-20 Coaxial Feedthrough, 1 Pin, Grounded Shield, Exposed Insulator, QF/KF, UHV Compatible

UNLESS OTHERWISE SPECIFIED:	QUOTATION #	N/A	
DIMENSIONS ARE IN INCHES TOLERANCES:	DRAWN	NAME	DATE
ANGULAR: MACH $\pm 1/2^\circ$	WJ	WJ	9/11/2015
TWO PLACE DECIMAL $\pm .030$	CHECKED		9/11/2015
THREE PLACE DECIMAL $\pm .015$	ENG APPR.	WJ	9/11/2015
MATERIAL	THIRD ANGLE:		
FINISH	APPLICATION	NEXT ASSY      USED ON	
PLATING	SURFACE FINISH:	$\sqrt{63}$ OR BETTER	
	UNLESS OTHERWISE SPECIFIED:	ALL DIAMETERS CONCENTRIC WITHIN .005. REMOVE ALL BURRS AND SHARP EDGES	
	TITLE:	SHV-20 COAXIAL FEEDTHROUGH, 1 PIN, GROUNDED SHIELD, EXPOSED, QF/KF	
	DOWNLOADED FROM MPFPI.COM		
	DWG. NO.	A2094	
	REV		
	Thursday, January 17, 2019 4:07:55 PM		