

MPF PRODUCTS INC.

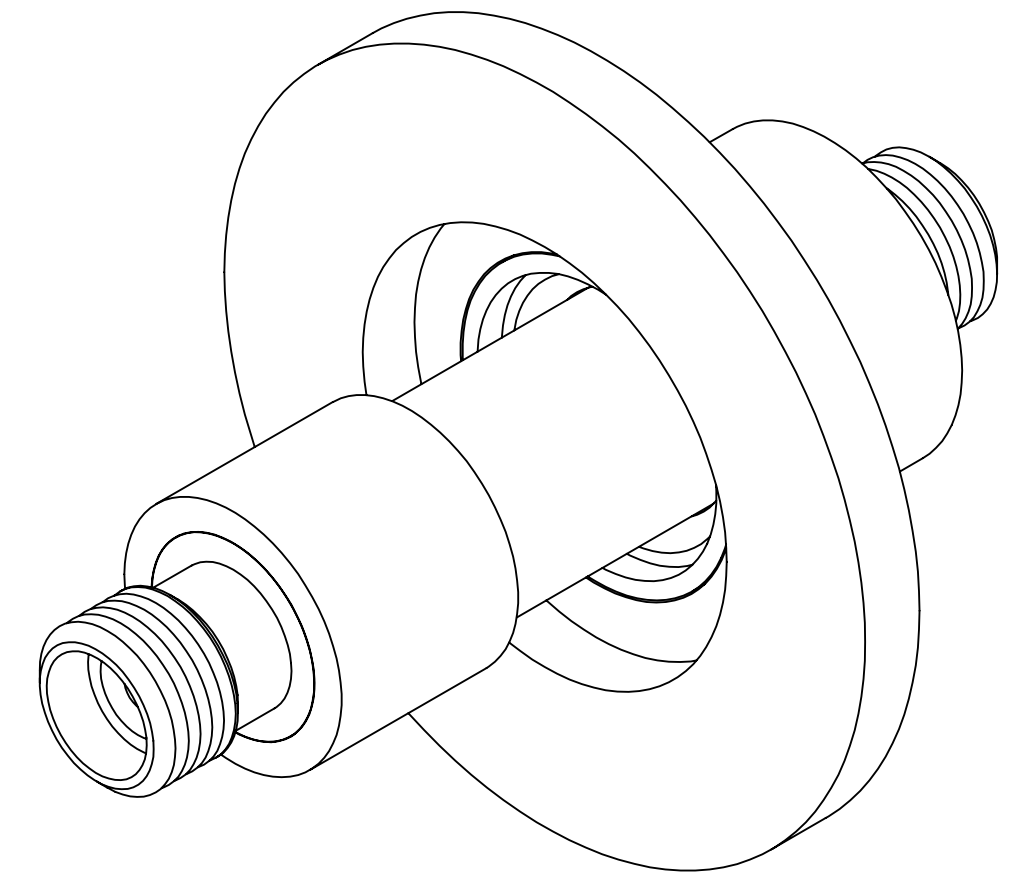

PART #	AIRSIDE CONNECTOR INCLUDED
A2127-1-QF	YES
A2127-2-QF	NO

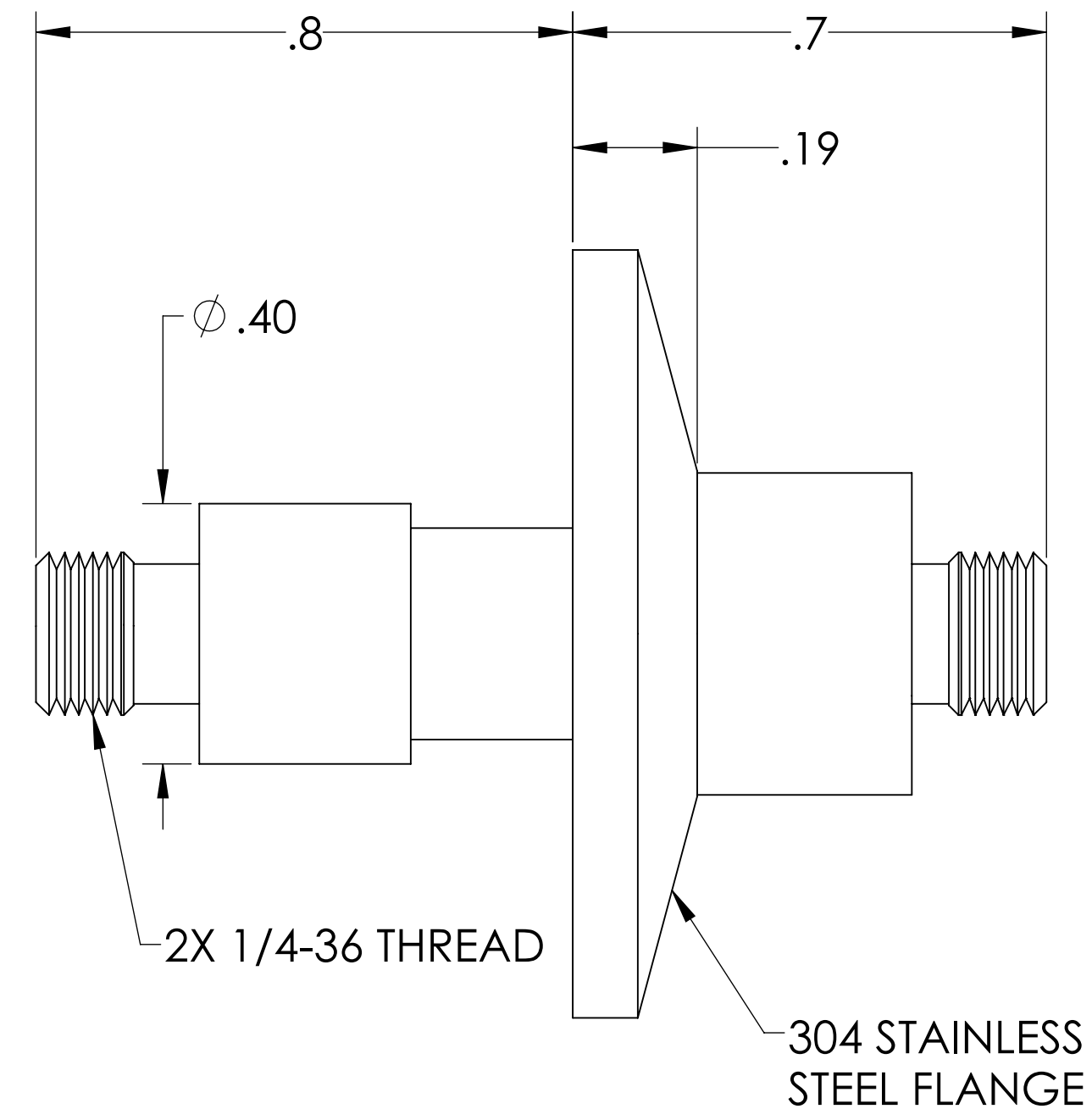
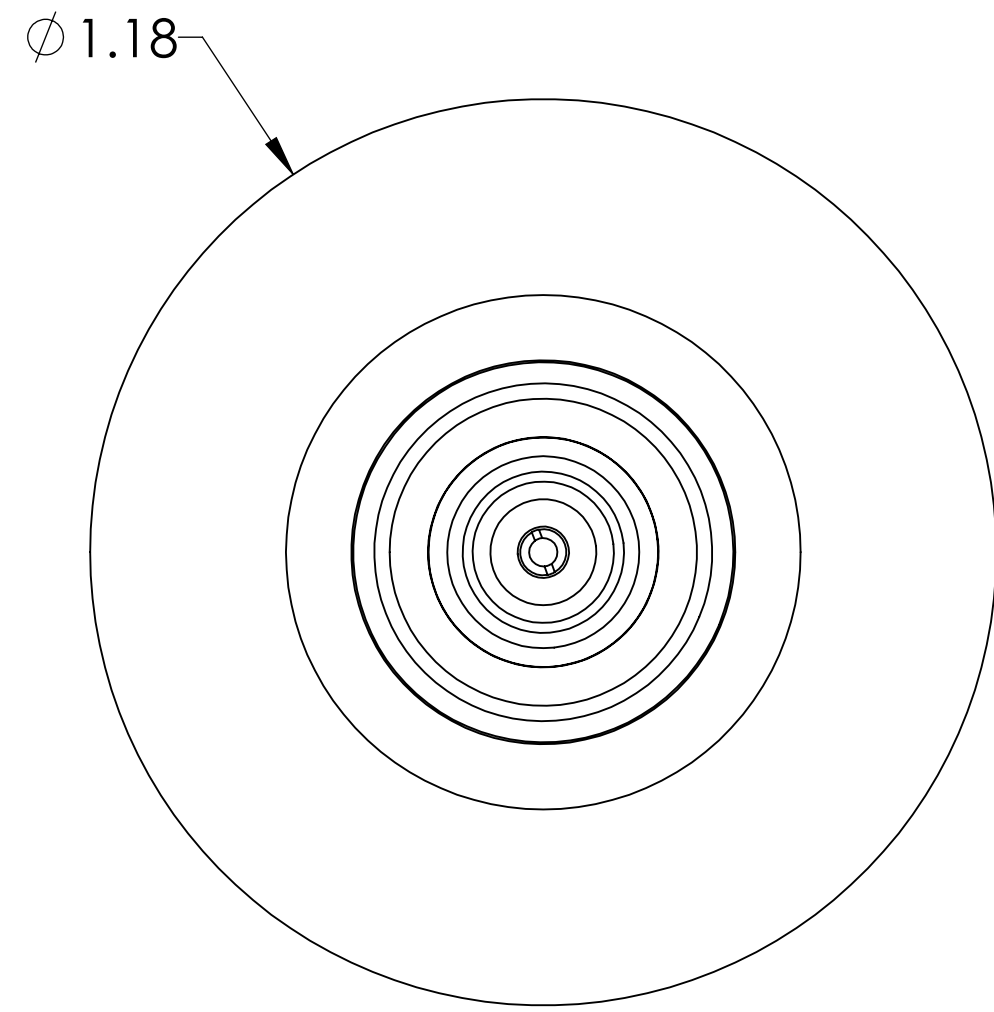
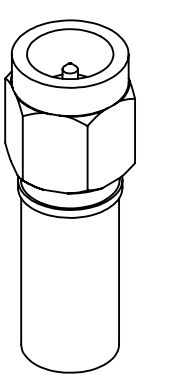

NOTE:

1. SHIELD: GROUNDED
2. VOLTAGE: 700 VOLTS DC
3. CURRENT: 1 AMP
4. TEMPERATURE RATING: -200 TO 450°C (FEEDTHROUGH), 65 TO 165°C (AIRSIDE CONNECTOR)
5. IMPEDANCE: 50 OHM

SMA Coaxial Feedthrough, 50 Ohm 1 Pin, Grounded Shield, Double Ended, 1.18" QF/KF, UHV Compatible

UNLESS OTHERWISE SPECIFIED:		QUOTATION #		N/A	
DIMENSIONS ARE IN INCHES TOLERANCES:		NAME	DATE	MPF PRODUCTS INC. TITLE: SMA COAXIAL FEEDTHROUGH, 50 OHM, 1 PIN, GROUNDED SHIELD, DOUBLE ENDED, 1.18" QF/KF DOWNLOADED FROM MPFPI.COM DWG. NO. A2127 REV	
ANGULAR: MACH ± 1/2°		DRAWN	9/11/2015		
TWO PLACE DECIMAL ± .030		CHECKED	9/11/2015		
THREE PLACE DECIMAL ± .015		ENG APPR.	9/11/2015		
MATERIAL		THIRD ANGLE:			
		APPLICATION			
		NEXT ASSY	USED ON		
FINISH		SURFACE FINISH: 63 OR BETTER			
PLATING		UNLESS OTHERWISE SPECIFIED:			
		ALL DIAMETERS CONCENTRIC WITHIN .005. REMOVE ALL BURRS AND SHARP EDGES		Friday, January 18, 2019 10:49:26 AM	