

MPF PRODUCTS INC.

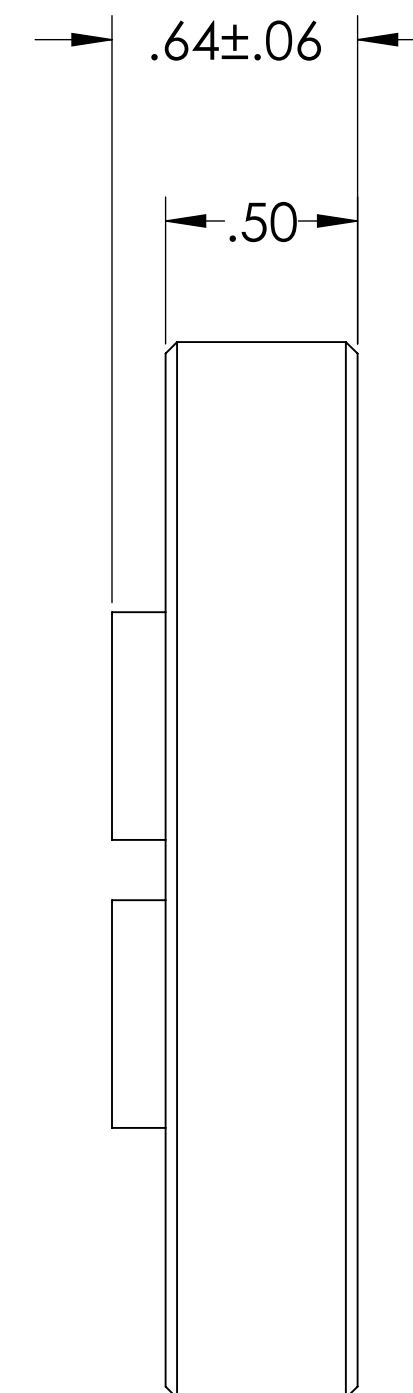
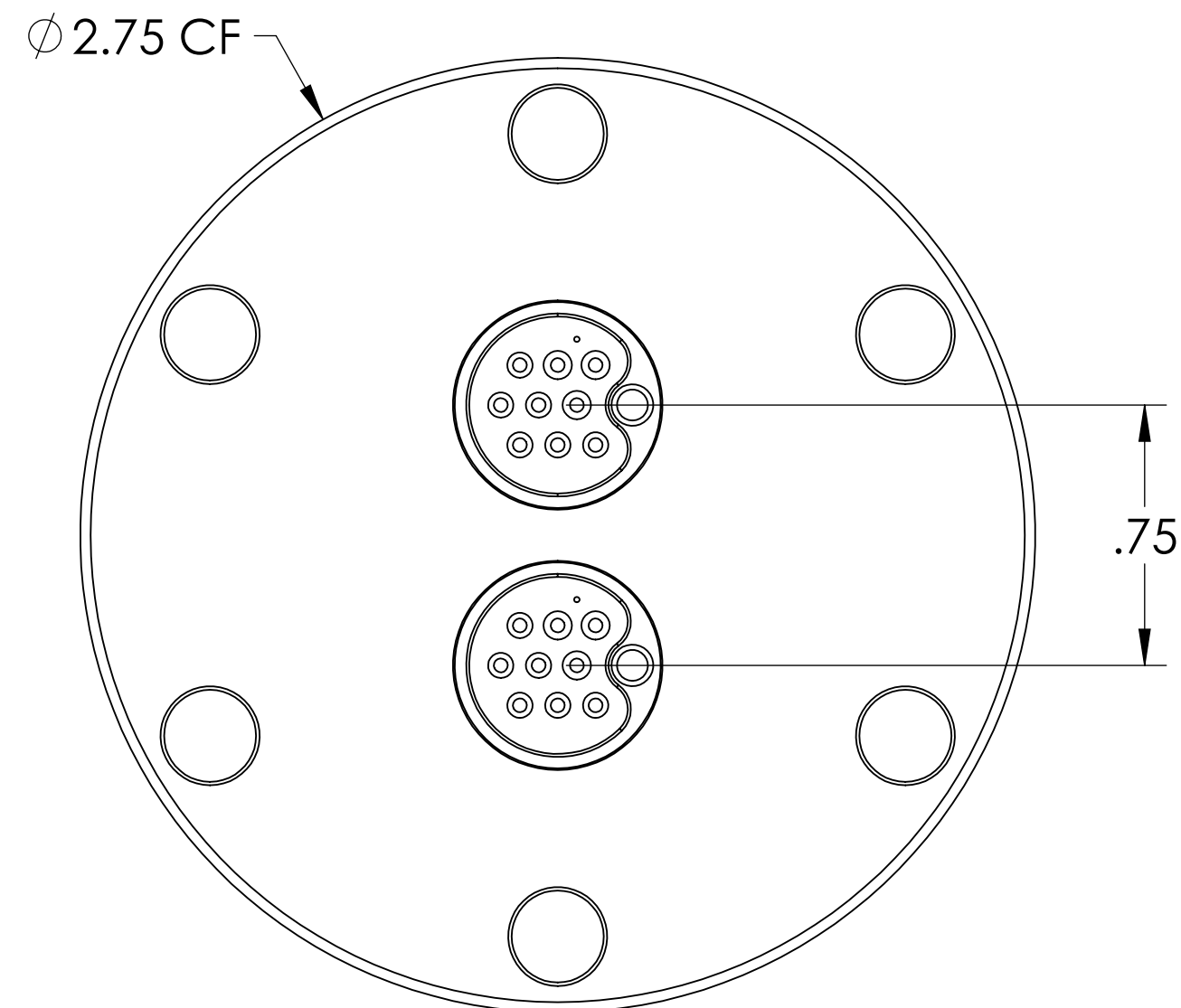
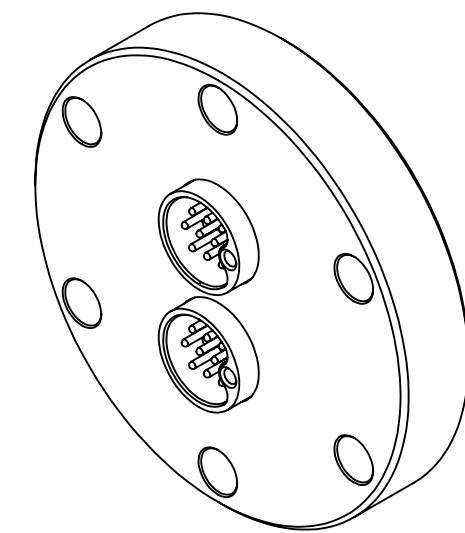

304 STAINLESS
STEEL FLANGE

SPECIFICATIONS:

1. VOLTAGE: 700 VOLTS DC
2. CURRENT: 10 AMPS PER PIN
3. TEMPERATURE RATING: -200 TO 450°C WITHOUT CONNECTOR
4. LEAK RATE <math>< 1 \times 10^{-9}</math> ATM CC/SEC HE

Subminiature C-type Multipin Feedthrough, 2X 9 Pins, 500 Volts, 5 Amps per Pin, 2.75" Conflat Flange

UNLESS OTHERWISE SPECIFIED:	QUOTATION #		N/A
DIMENSIONS ARE IN INCHES TOLERANCES:	NAME	DATE	MPF PRODUCTS INC.
ANGULAR: MACH $\pm 1/2^\circ$	DRAWN	9/11/2015	
TWO PLACE DECIMAL $\pm .030$	CHECKED	9/11/2015	
THREE PLACE DECIMAL $\pm .015$	ENG APPR.	WJ 9/11/2015	
MATERIAL	THIRD ANGLE:		MULTIPIN, TYPE-C, 500V, 5A, 2X 9 PINS, 275CF
FINISH	APPLICATION		DOWNLOADED FROM MPFPI.COM
PLATING	NEXT ASSY USED ON		
	SURFACE FINISH: $\sqrt{63}$ OR BETTER		DWG. NO.
	UNLESS OTHERWISE SPECIFIED:		A2141-1-CF
	ALL DIAMETERS CONCENTRIC WITHIN .005. REMOVE ALL BURRS AND SHARP EDGES		REV
	Thursday, February 7, 2019 8:39:29 AM		