

MPF PRODUCTS INC.

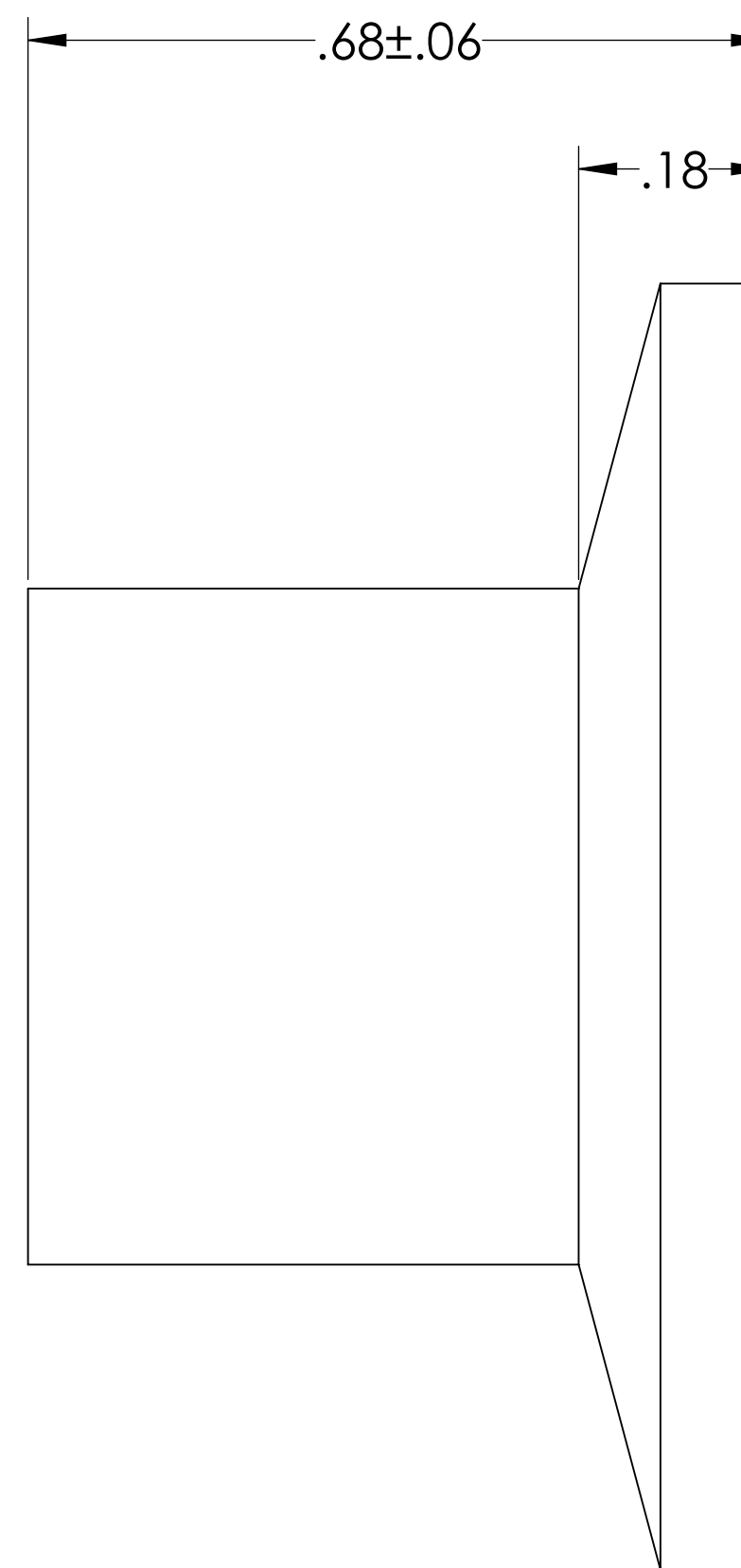
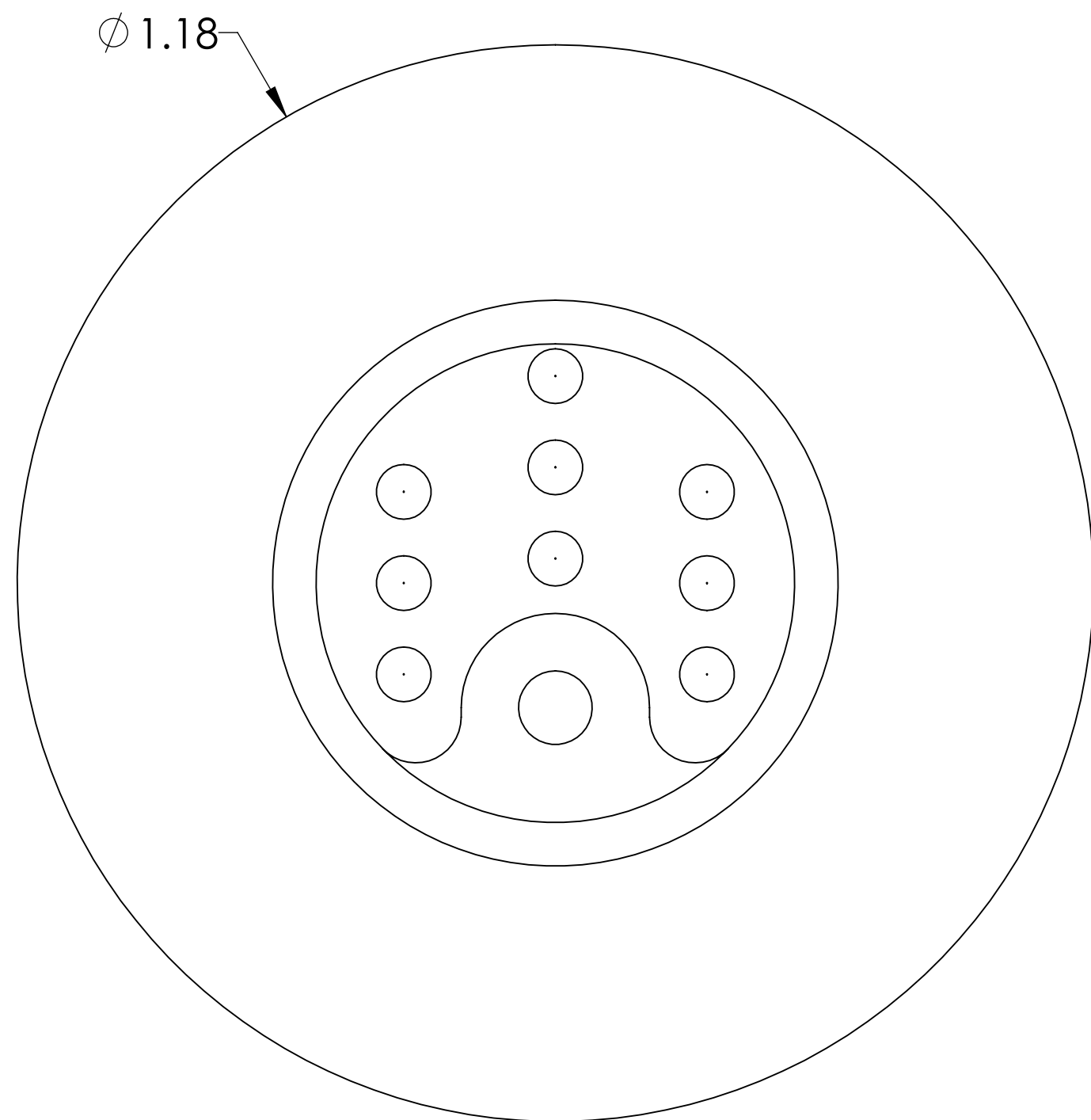
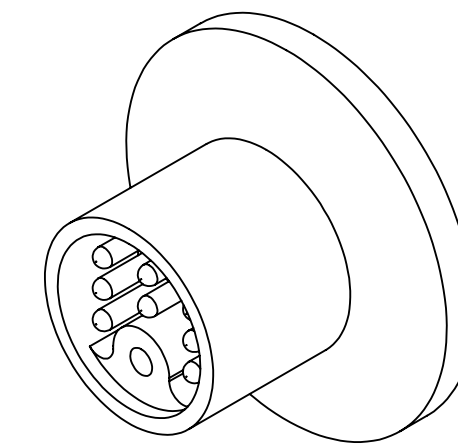

304 STAINLESS
STEEL FLANGE

SPECIFICATIONS:

1. VOLTAGE: 700 VOLTS DC
2. CURRENT: 5 AMPS PER PIN
3. TEMPERATURE RATING: -100 TO 450°C WITHOUT CONNECTOR
4. LEAK RATE < 1X10-9 ATM CC/SEC HE

Subminiature C-type Multipin Feedthrough, 9 Pins, 500 Volts, 5 Amps per Pin, 1.18" QF/KF

| | | | |
|---|---|------|-----------|
| UNLESS OTHERWISE SPECIFIED: | QUOTATION # | N/A | |
| DIMENSIONS ARE IN INCHES TOLERANCES: | DRAWN | NAME | DATE |
| ANGULAR: MACH ± 1/2° | WJ | WJ | 9/11/2015 |
| TWO PLACE DECIMAL ± .030 | CHECKED | | 9/11/2015 |
| THREE PLACE DECIMAL ± .015 | ENG APPR. | WJ | 9/11/2015 |
| MATERIAL | THIRD ANGLE: | | |
| | | | |
| FINISH | APPLICATION | | |
| PLATING | NEXT ASSY USED ON | | |
| | SURFACE FINISH: 63/ OR BETTER | | |
| | UNLESS OTHERWISE SPECIFIED: | | |
| | ALL DIAMETERS CONCENTRIC WITHIN .005. REMOVE ALL BURRS AND SHARP EDGES | | |
| | TITLE: | | REV |
| | MULTIPIN, TYPE-C, 500V, 5A, 9 PIN, 1.18" QF/KF | | |
| | DWG. NO. | | |
| | A2143-1-QF | | |
| | DOWNLOADED FROM MPFPI.COM | | |
| | Monday, January 28, 2019 9:48:27 AM | | |