

# MPF PRODUCTS INC.

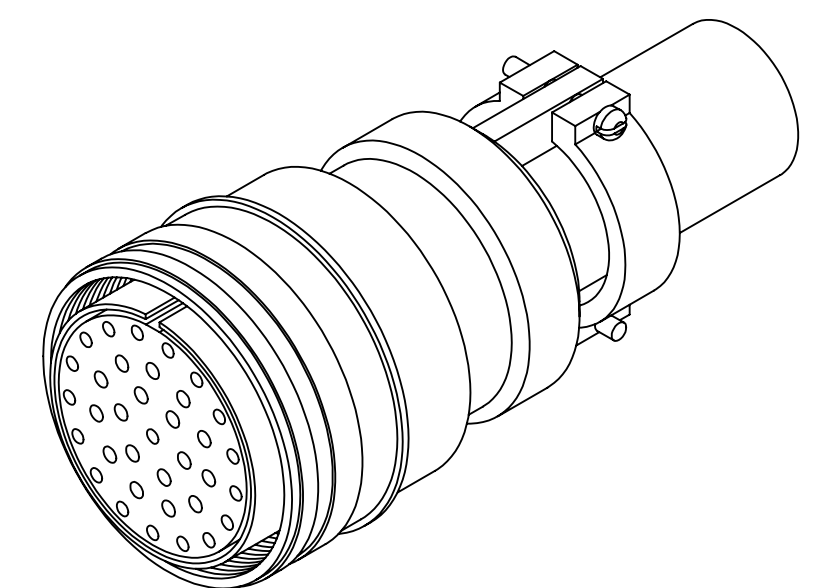
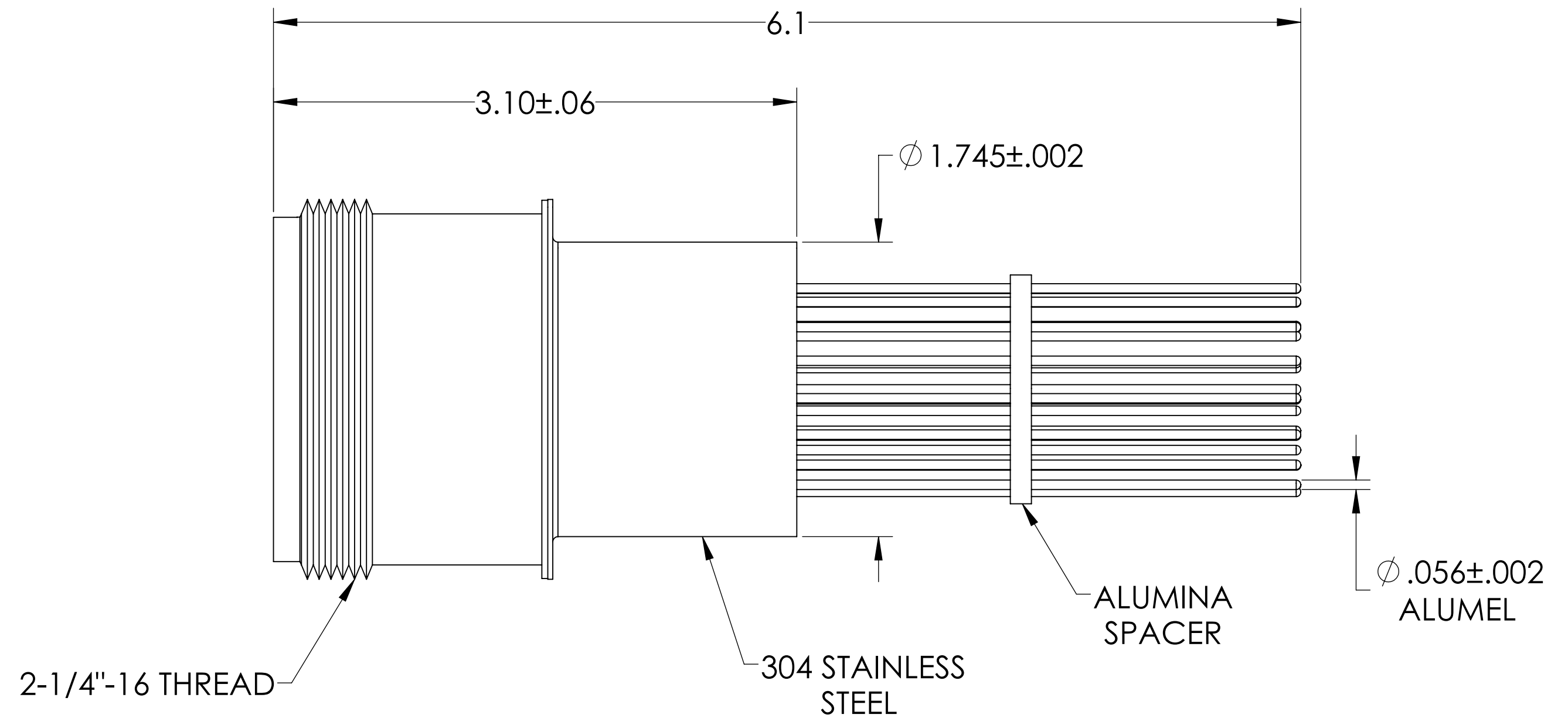
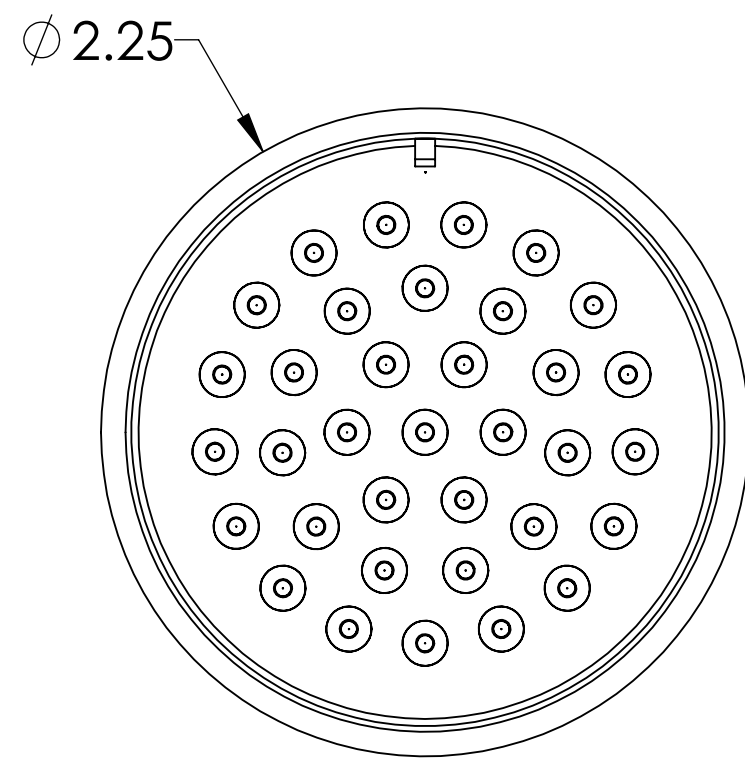
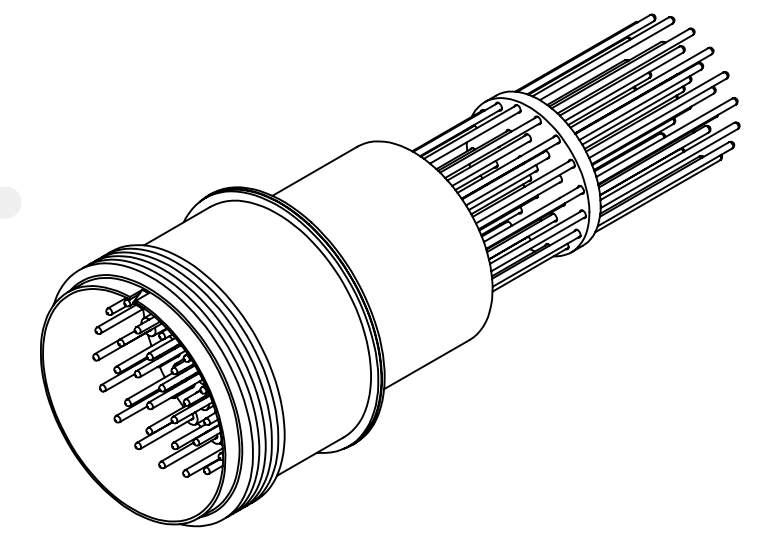

**SPECIFICATIONS:**

1. VOLTAGE: 700 VOLTS DC
2. CURRENT: 10 AMPS PER PIN, 100 AMPS FULL LOAD
3. TEMPERATURE RATING: -100 TO 450°C WITHOUT CONNECTOR
4. LEAK RATE < 1X10-9 ATM CC/SEC HE

MS Series, Multipin Feedthrough, 35 Pins, 700 Volts, 10 Amps per Pin, 0.056" Dia Conductors w/ Air-side Connector, 1.75" Weld Adapter

UNLESS OTHERWISE SPECIFIED:		QUOTATION #		N/A	
DIMENSIONS ARE IN INCHES TOLERANCES:		NAME	DATE	MPF PRODUCTS INC.	
ANGULAR: MACH ± 1/2°		DRAWN	9/11/2015		
TWO PLACE DECIMAL ± .030		CHECKED	9/11/2015		
THREE PLACE DECIMAL ± .015		ENG APPR.	9/11/2015		
MATERIAL		THIRD ANGLE:		MULTIPIN, 35 PINS, 700V, 10A, 1.745" WELD ADAPTER	
FINISH					
PLATING		SURFACE FINISH: 63 OR BETTER		DOWNLOADED FROM MPFPI.COM	
		UNLESS OTHERWISE SPECIFIED: ALL DIAMETERS CONCENTRIC WITHIN .005. REMOVE ALL BURRS AND SHARP EDGES		DWG. NO. A2248-1-W	
				REV	
				Monday, January 28, 2019 10:21:14 AM	