

MPF PRODUCTS INC.

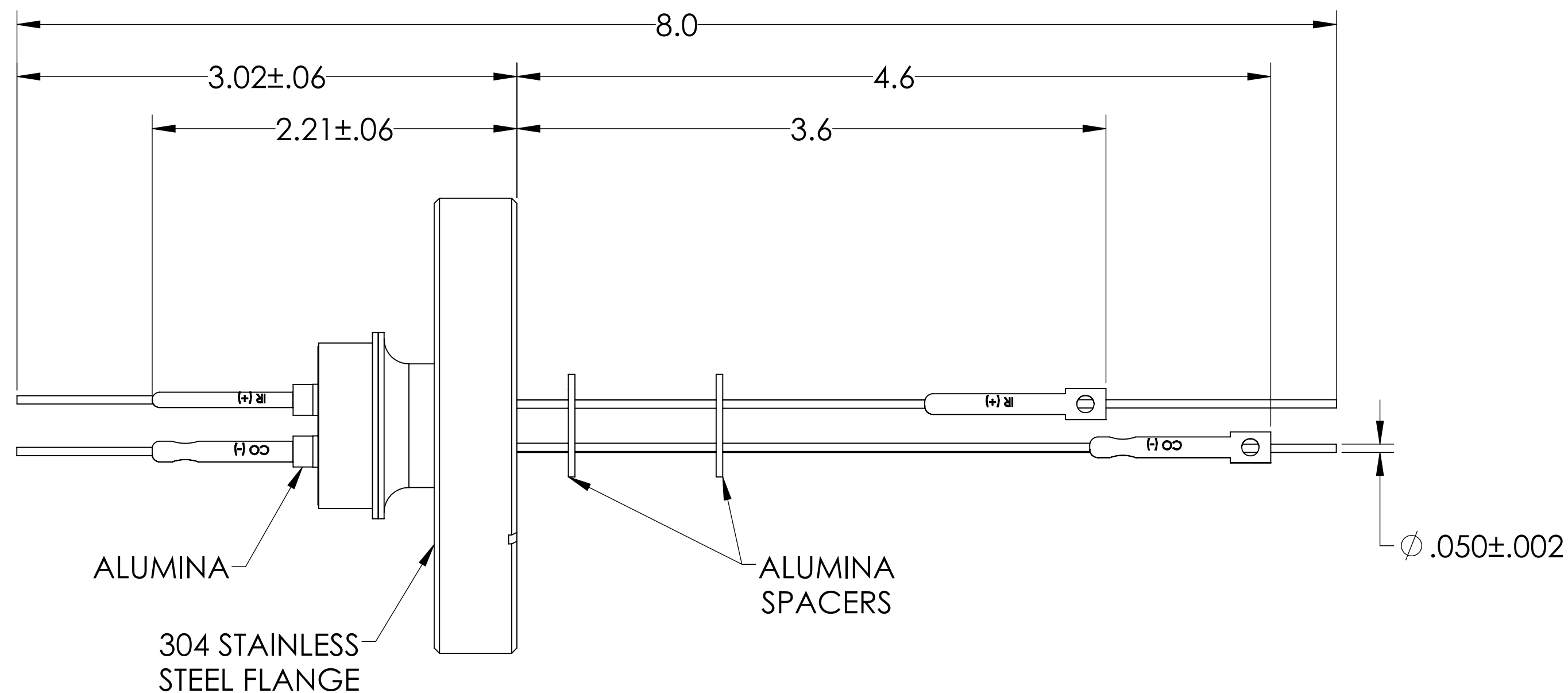
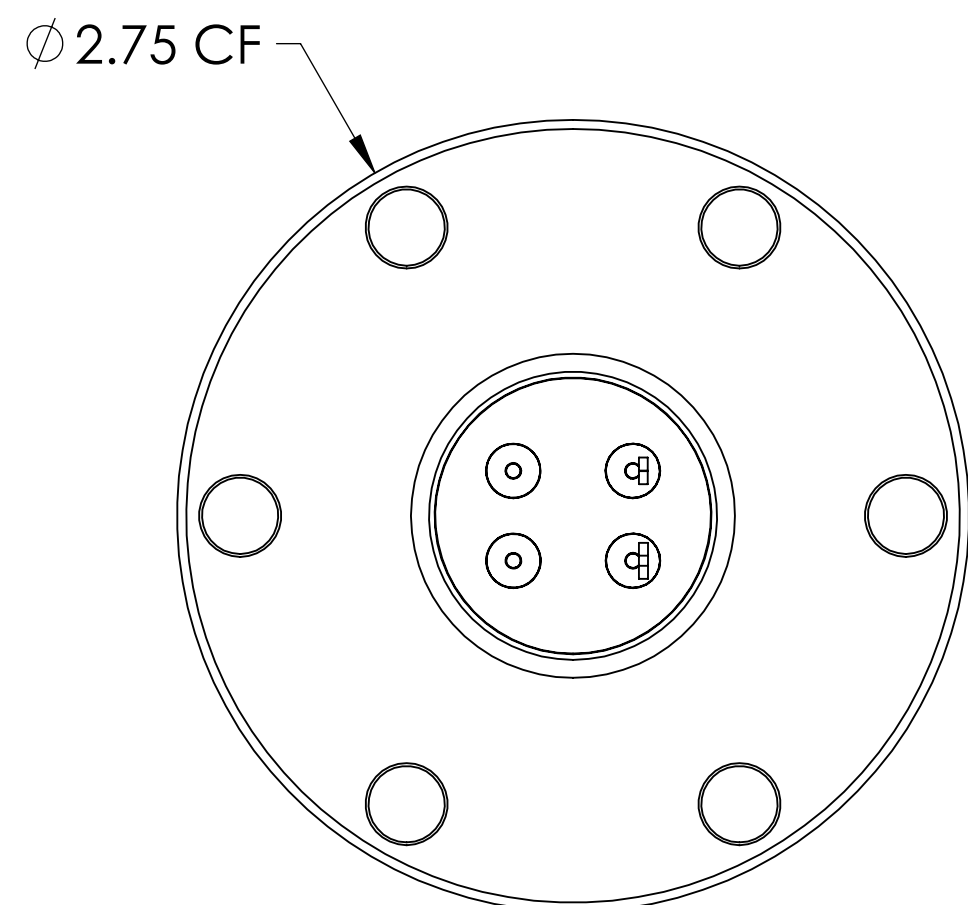
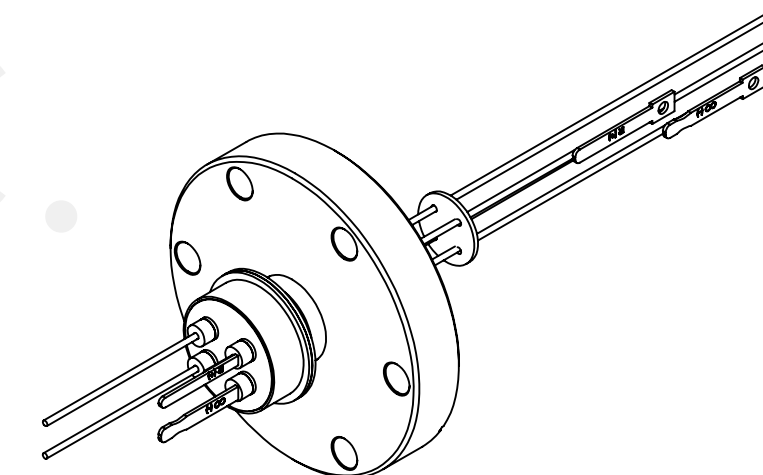

PART #	T/C TYPE	POWER LEADS	CURRENT RATINGS (POWER PINS ONLY)
A2267-1-CF	K	COPPER	15 AMPS (PER PIN)
A2267-2-CF	K	NICKEL	5 AMPS (PER PIN)
A2267-3-CF	J	COPPER	15 AMPS (PER PIN)
A2267-4-CF	J	NICKEL	5 AMPS (PER PIN)
A2267-5-CF	C	COPPER	15 AMPS (PER PIN)
A2267-6-CF	C	NICKEL	5 AMPS (PER PIN)
A2267-7-CF	E	COPPER	15 AMPS (PER PIN)
A2267-8-CF	E	NICKEL	5 AMPS (PER PIN)

SPECIFICATIONS:

- VOLTAGE: 1000 VOLTS DC
- CURRENT: SEE TABLE
- TEMPERATURE RATING: -100 TO 450°C
- LEAK RATE < 1X10-9 ATM CC/SEC HE

Thermocouple-Power Feedthrough, 1 Pair , w/ Miniature TC Connector, 1000 Volts, 2 Pins, 2.75" Conflat Flange

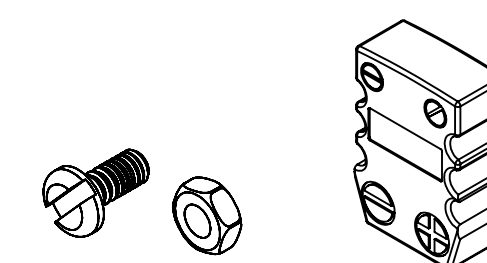

UNLESS OTHERWISE SPECIFIED:		QUOTATION #		N/A	
DIMENSIONS ARE IN INCHES TOLERANCES:		NAME	DATE	MPF PRODUCTS INC.	
ANGULAR: MACH ± 1/2°		DRAWN	9/11/2015		
TWO PLACE DECIMAL ± .030		CHECKED	9/11/2015		
THREE PLACE DECIMAL ± .015		ENG APPR.	9/11/2015		
MATERIAL		THIRD ANGLE:		TITLE:	
				THERMOCOUPLE-POWER, 1 PAIR, 1000V, 2 PINS, 275CF	
FINISH		APPLICATION		NEXT ASSY	
PLATING		SURFACE FINISH: 63/ OR BETTER		USED ON	
		UNLESS OTHERWISE SPECIFIED:		DOWNLOADED FROM MPFPI.COM	
		ALL DIAMETERS CONCENTRIC WITHIN .005. REMOVE ALL BURRS AND SHARP EDGES		DWG. NO. A2267	
				REV	
				Friday, February 8, 2019 12:49:31 PM	