

# MPF PRODUCTS INC.

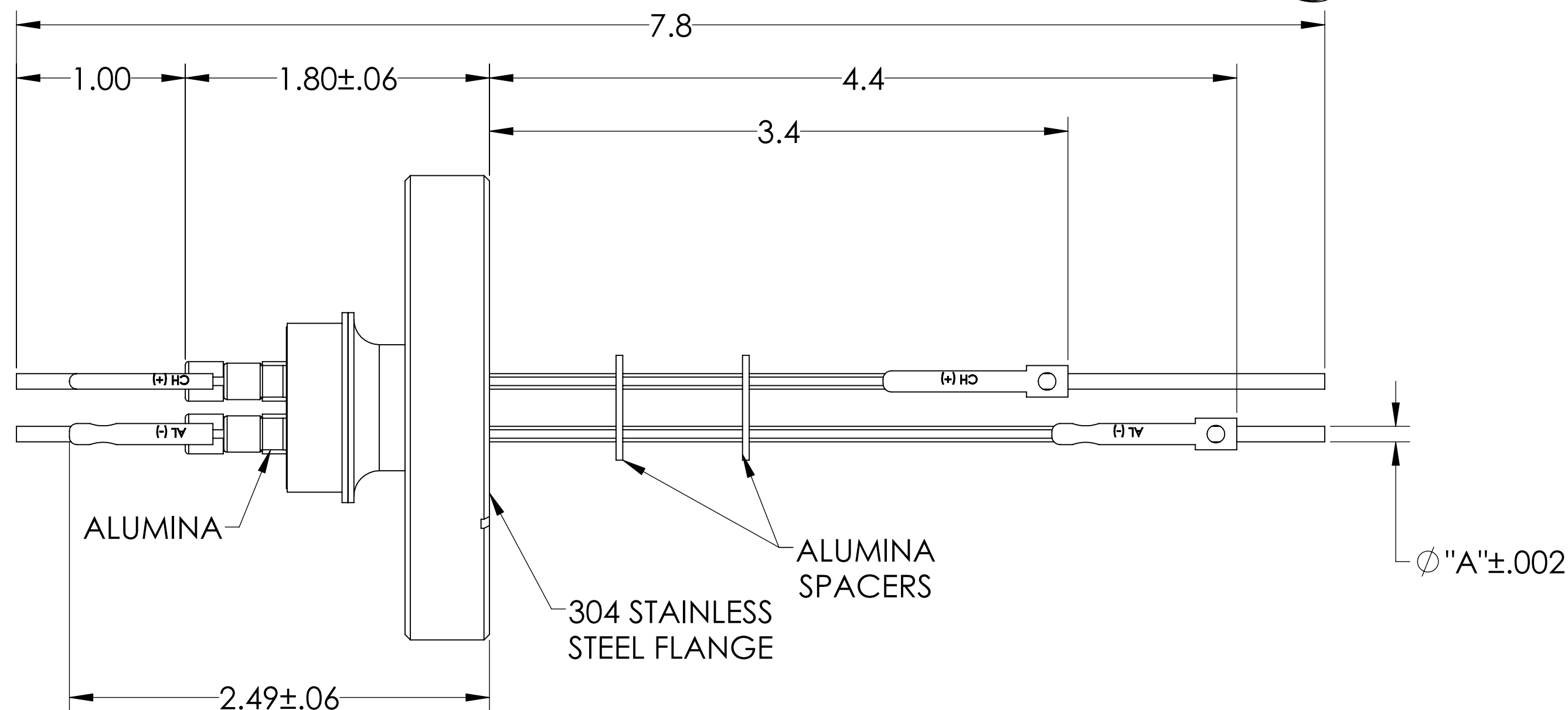

| PART #     | T/C TYPE | POWER LEADS | Ø"A" | CURRENT RATINGS (POWER PINS ONLY) |
|------------|----------|-------------|------|-----------------------------------|
| A2277-1-CF | K        | COPPER      | .094 | 30 AMPS (PER PIN)                 |
| A2277-2-CF | K        | NICKEL      | .092 | 15 AMPS (PER PIN)                 |
| A2277-3-CF | J        | COPPER      | .094 | 30 AMPS (PER PIN)                 |
| A2277-4-CF | J        | NICKEL      | .092 | 15 AMPS (PER PIN)                 |
| A2277-5-CF | C        | COPPER      | .094 | 30 AMPS (PER PIN)                 |
| A2277-6-CF | C        | NICKEL      | .092 | 15 AMPS (PER PIN)                 |
| A2277-7-CF | E        | COPPER      | .094 | 30 AMPS (PER PIN)                 |
| A2277-8-CF | E        | NICKEL      | .092 | 15 AMPS (PER PIN)                 |

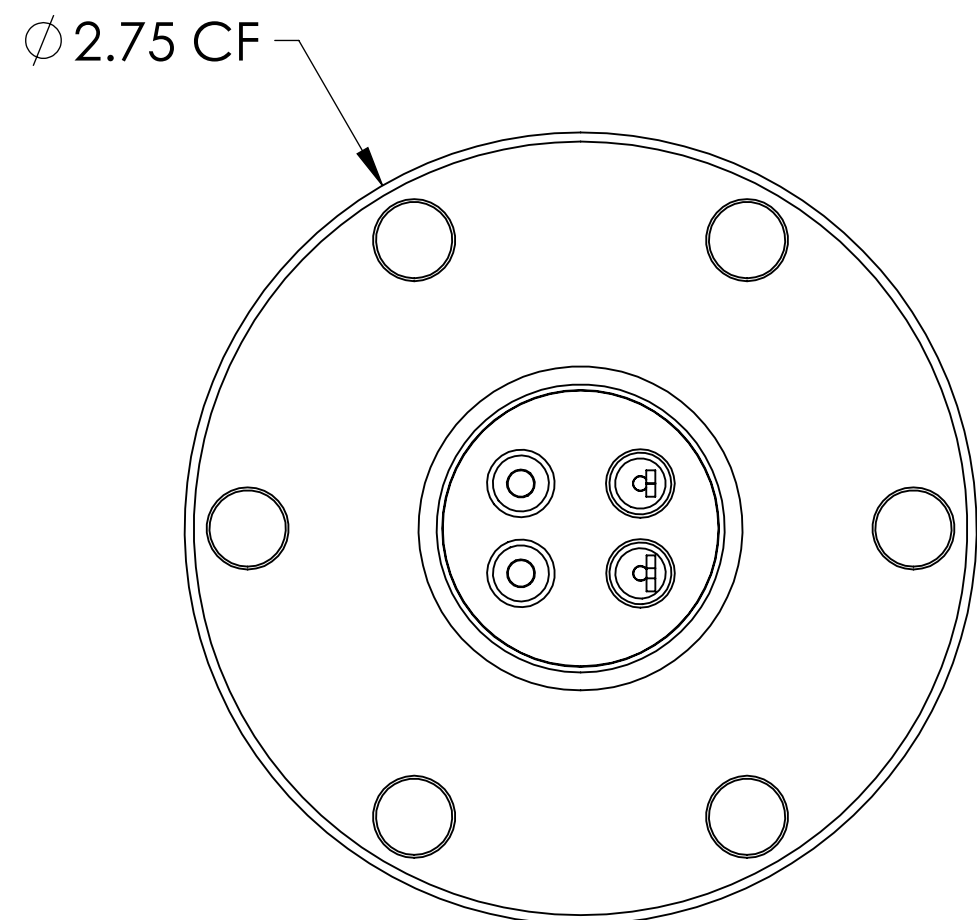
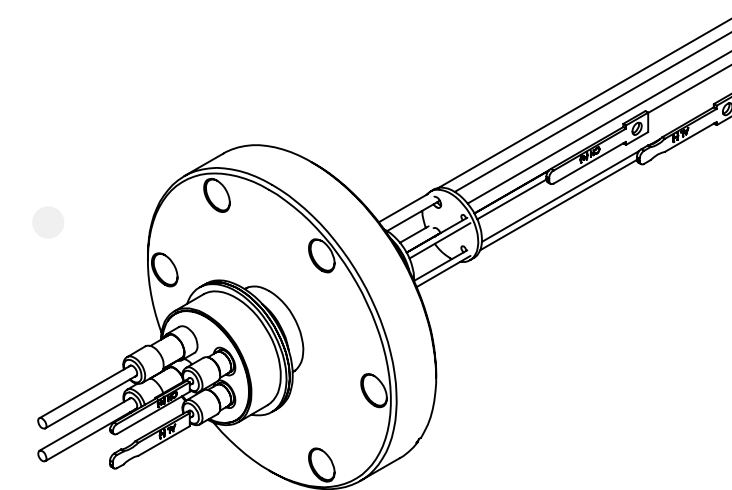
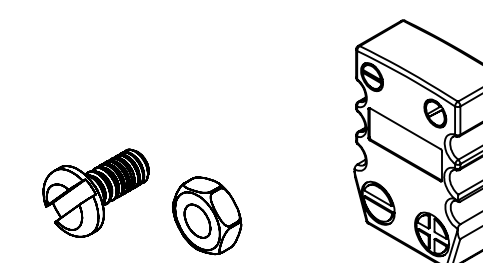

**SPECIFICATIONS:**

- VOLTAGE: 5000 VOLTS DC
- CURRENT: SEE TABLE
- TEMPERATURE RATING: -100 TO 450°C
- LEAK RATE < 1X10-9 ATM CC/SEC HE

Thermocouple-Power Feedthrough, 1 Pair , w/ Miniature TC Connector, 5000 Volts, 2 Pins, 2.75" Conflat Flange

|                                      |  |                                                                        |           |                                         |  |
|--------------------------------------|--|------------------------------------------------------------------------|-----------|-----------------------------------------|--|
| UNLESS OTHERWISE SPECIFIED:          |  | QUOTATION #                                                            |           | N/A                                     |  |
| DIMENSIONS ARE IN INCHES TOLERANCES: |  | NAME                                                                   | DATE      | MPF PRODUCTS INC.                       |  |
| ANGULAR: MACH ± 1/2°                 |  | DRAWN                                                                  | 9/11/2015 | TITLE:                                  |  |
| TWO PLACE DECIMAL ± .030             |  | CHECKED                                                                | 9/11/2015 | THERMOCOUPLE-POWER,                     |  |
| THREE PLACE DECIMAL ± .015           |  | ENG APPR.                                                              | 9/11/2015 | 1 PAIR, 5000V, 2 PINS,                  |  |
| MATERIAL                             |  | THIRD ANGLE:                                                           |           | 275CF                                   |  |
| FINISH                               |  | APPLICATION                                                            |           | DOWNLOADED FROM MPFPI.COM               |  |
| PLATING                              |  | NEXT ASSY                                                              |           | DWG. NO.                                |  |
|                                      |  | USED ON                                                                |           | A2277                                   |  |
|                                      |  | SURFACE FINISH: 63/ OR BETTER                                          |           | REV                                     |  |
|                                      |  | UNLESS OTHERWISE SPECIFIED:                                            |           | Tuesday, September 24, 2019 11:24:55 AM |  |
|                                      |  | ALL DIAMETERS CONCENTRIC WITHIN .005. REMOVE ALL BURRS AND SHARP EDGES |           |                                         |  |