

MPF PRODUCTS INC.

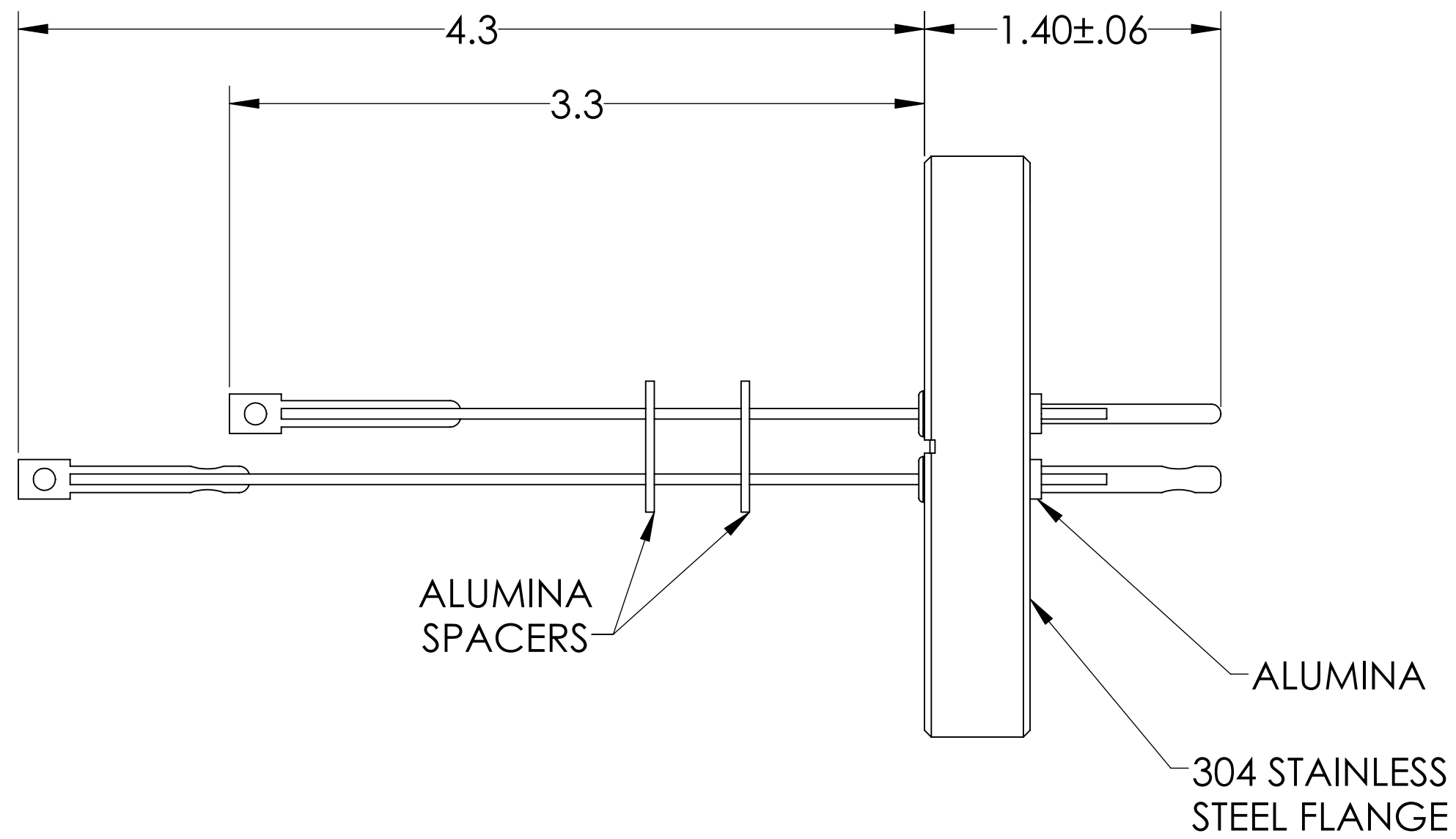

PART #	T/C TYPE
A2288-1-CF	J
A2288-2-CF	K
A2288-3-CF	C
A2288-4-CF	E

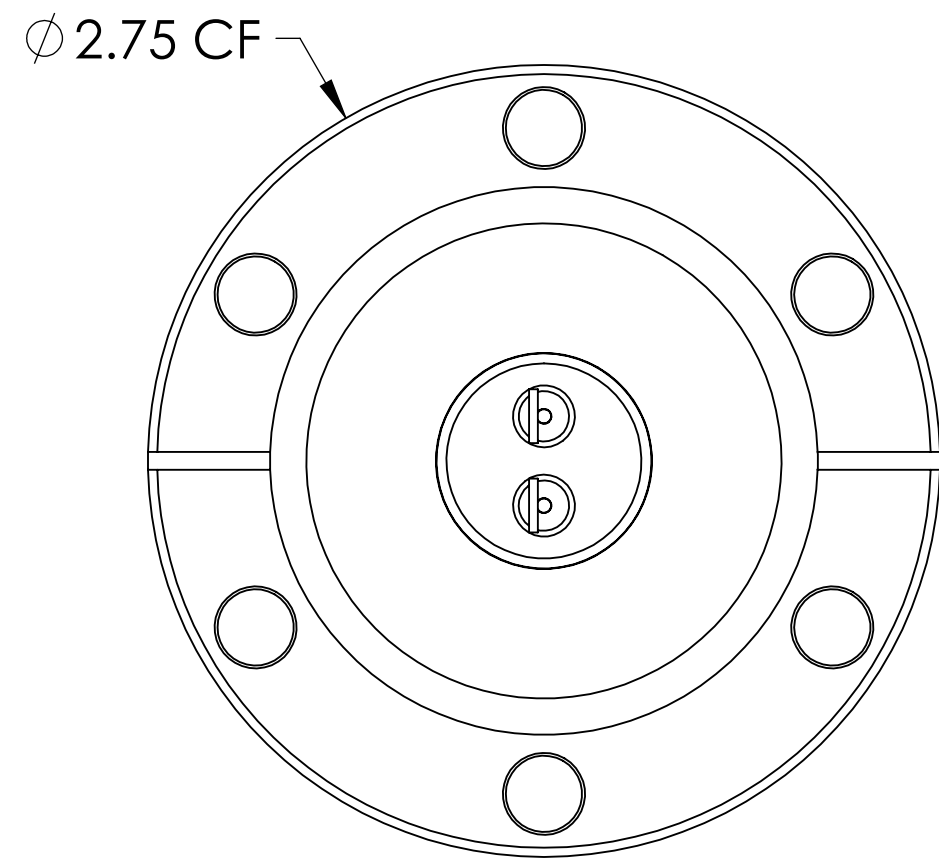
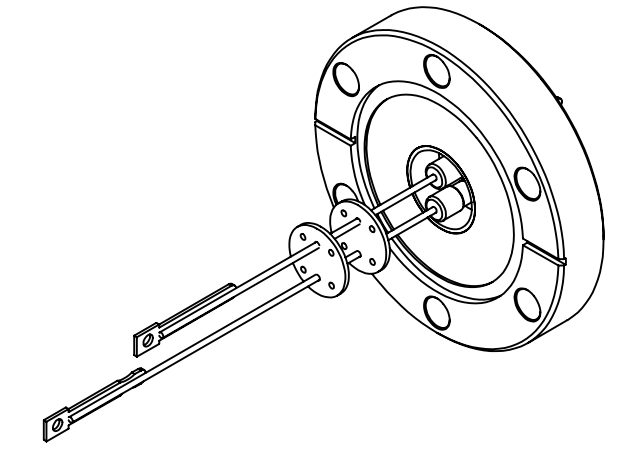
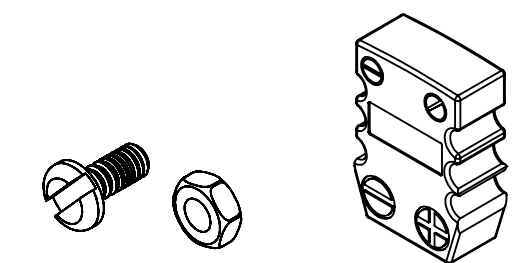

SPECIFICATIONS:

1. TEMPERATURE RATING: -100 TO 450°C
2. LEAK RATE < 1X10-9 ATM CC/SEC HE

Thermocouple Feedthrough, 1 Pair, Miniature Connector, 2.75" Conflat Flange

UNLESS OTHERWISE SPECIFIED:	QUOTATION #	N/A
DIMENSIONS ARE IN INCHES TOLERANCES:	NAME	DATE
ANGULAR: MACH ± 1/2°	DRAWN	9/11/2015
TWO PLACE DECIMAL ± .030	CHECKED	9/11/2015
THREE PLACE DECIMAL ± .015	ENG APPR.	WJ 9/11/2015
MATERIAL	THIRD ANGLE:	
FINISH	APPLICATION	
PLATING	NEXT ASSY	USED ON
	SURFACE FINISH:	63/ OR BETTER
	UNLESS OTHERWISE SPECIFIED:	
	ALL DIAMETERS CONCENTRIC WITHIN .005.	REMOVE ALL BURRS AND SHARP EDGES
	TITLE:	MPF PRODUCTS INC.
	THERMOCOUPLE, 1 PAIR, CONNECTOR, 275CF	
	DOWNLOADED FROM MPFPI.COM	
	DWG. NO.	A2288
	REV	
	Friday, February 8, 2019 12:59:03 PM	