

MPF PRODUCTS INC.

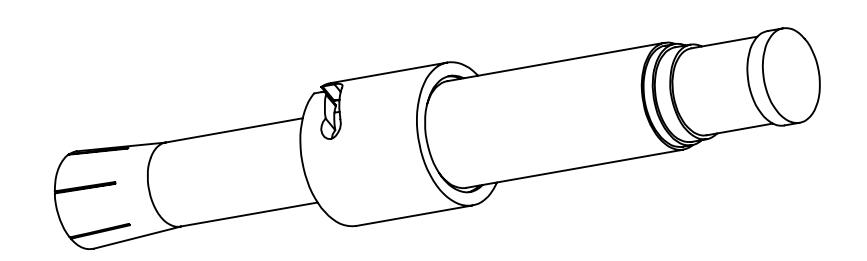
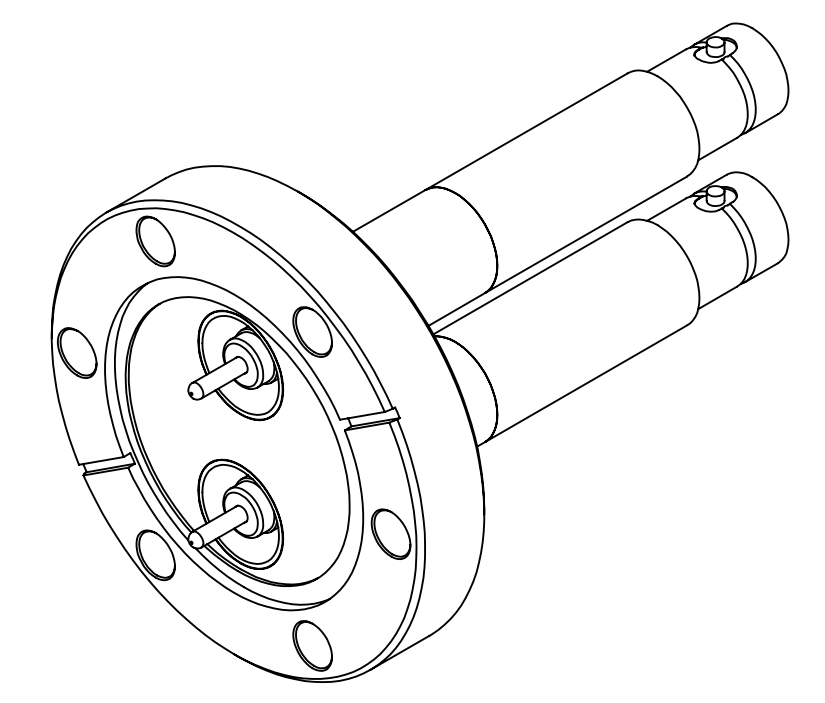
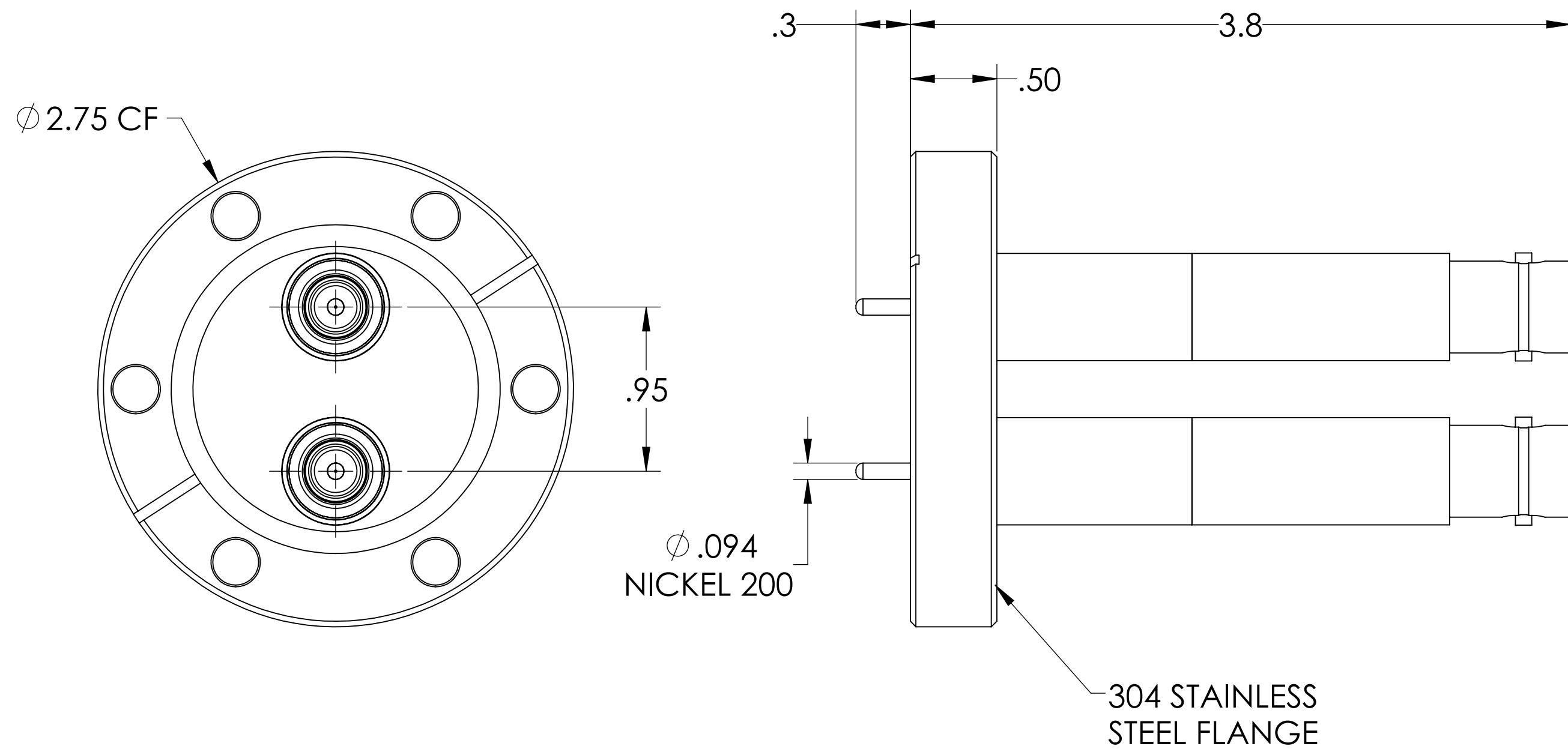

PART #	AIRSIDE CONNECTOR INCLUDED
A2300-1-CF	YES
A2300-2-CF	NO

- NOTE:
1. SHIELD: GROUNDED
 2. VOLTAGE: 20,000 VOLTS DC
 3. CURRENT: 15 AMPS
 4. TEMPERATURE RATING: -200 TO 450°C (FEEDTHROUGH), 65 TO 165°C (AIRSIDE CONNECTOR)
 5. IMPEDANCE: NON-CONSTANT

SHV-20 Coaxial Feedthrough, 2 Pins, Grounded Shield, 2.75" Conflat Flange, UHV Compatible

UNLESS OTHERWISE SPECIFIED:	QUOTATION #	N/A
DIMENSIONS ARE IN INCHES TOLERANCES:	NAME	DATE
ANGULAR: MACH ± 1/2°	DRAWN	9/11/2015
TWO PLACE DECIMAL ± .030	CHECKED	9/11/2015
THREE PLACE DECIMAL ± .015	ENG APPR.	9/11/2015
MATERIAL	THIRD ANGLE:	
	APPLICATION	
	NEXT ASSY	USED ON
FINISH	SURFACE FINISH:	63/ OR BETTER
PLATING	UNLESS OTHERWISE SPECIFIED:	
	ALL DIAMETERS CONCENTRIC WITHIN .005.	REMOVE ALL BURRS AND SHARP EDGES
	TITLE:	SHV-20 COAXIAL FEEDTHROUGH, 2 PINS, GROUNDED SHIELD, 2.75" CONFLAT FLANGE
	DOWNLOADED FROM MPFPI.COM	
	DWG. NO.	A2300
	REV	
	Friday, January 18, 2019 10:28:20 AM	