

MPF PRODUCTS INC.

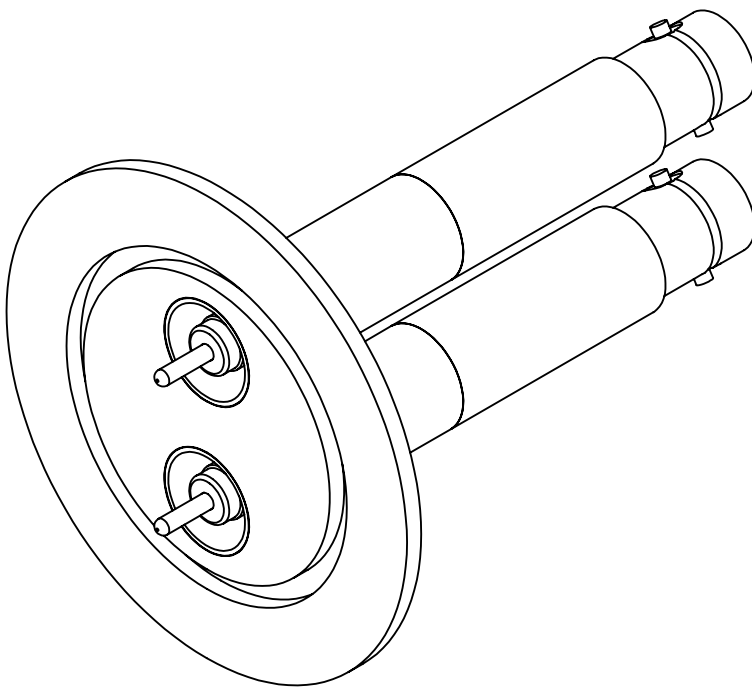
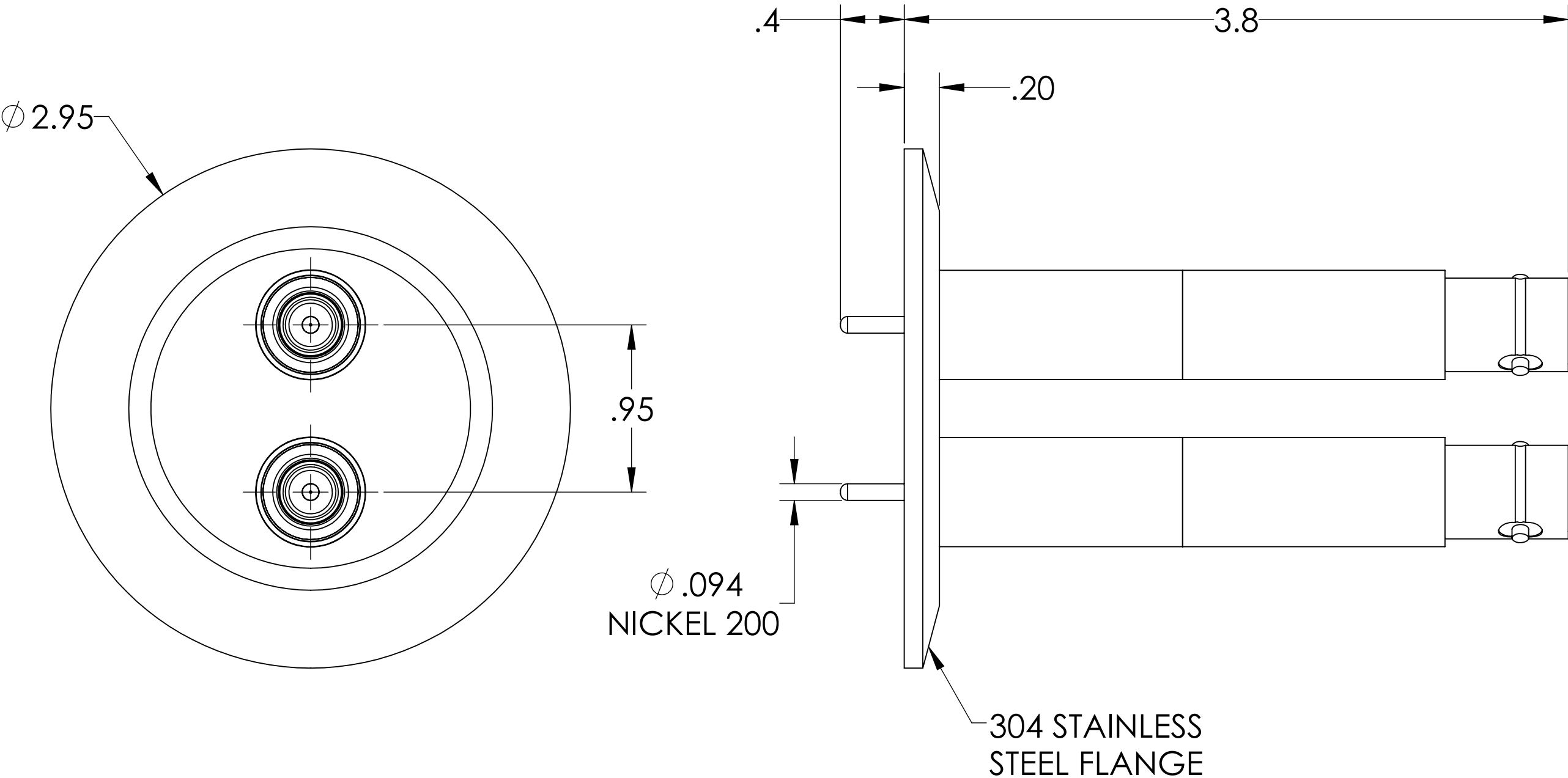

PART #	AIRSIDE CONNECTOR INCLUDED
A2302-1-QF	YES
A2302-2-QF	NO

- NOTE:
- 1. SHIELD: GROUNDED
 - 2. VOLTAGE: 20,000 VOLTS DC
 - 3. CURRENT: 15 AMPS
 - 4. TEMPERATURE RATING: -200 TO 450°C (FEEDTHROUGH), 65 TO 165°C (AIRSIDE CONNECTOR)
 - 5. IMPEDANCE: NON-CONSTANT

SHV-20 Coaxial Feedthrough, 2 Pins, Grounded Shield, 2.95" QF/KF, UHV Compatible

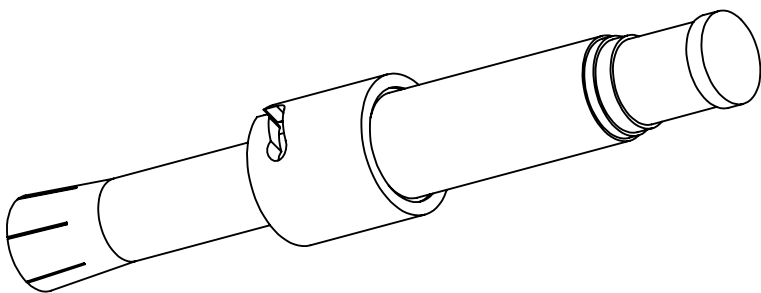

UNLESS OTHERWISE SPECIFIED:		QUOTATION #		N/A	
DIMENSIONS ARE IN INCHES TOLERANCES:		DRAWN	WJ	DATE	9/11/2015
ANGULAR: MACH ± 1/2°		CHECKED			9/11/2015
TWO PLACE DECIMAL ± .030		ENG APPR.	WJ		9/11/2015
THREE PLACE DECIMAL ± .015		THIRD ANGLE:			
MATERIAL					
		APPLICATION			
		NEXT ASSY			
		USED ON			
FINISH		SURFACE FINISH: 63 OR BETTER			
PLATING		UNLESS OTHERWISE SPECIFIED:			
		ALL DIAMETERS CONCENTRIC WITHIN .005. REMOVE ALL BURRS AND SHARP EDGES			
		TITLE: SHV-20 COAXIAL FEEDTHROUGH, 2 PINS, GROUNDED SHIELD, 2.95" QF/KF			
		DWG. NO. A2302			
		REV			
		DOWNLOADED FROM MPFPI.COM			
		Friday, January 18, 2019 10:27:33 AM			