

MPF PRODUCTS INC.

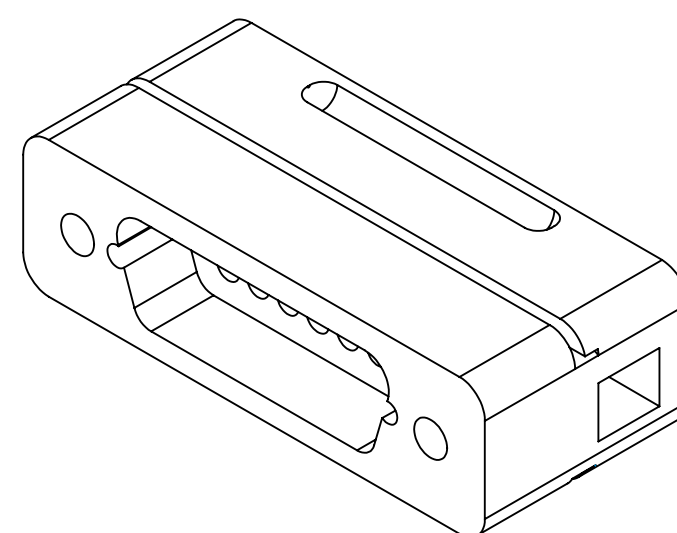

SPECIFICATIONS:

1. OPERATING TEMPERATURE: 250 °C (CONTACTS NOT INCLUDED)

Subminiature D-type Connector, 15 Pins, In-Vacuum, Male Pins

UNLESS OTHERWISE SPECIFIED:	QUOTATION #		N/A
DIMENSIONS ARE IN INCHES	NAME	DATE	MPF PRODUCTS INC.
TOLERANCES:	DRAWN	9/11/2015	
ANGULAR: MACH ± 1/2°	CHECKED	9/11/2015	
TWO PLACE DECIMAL ± .030	ENG APPR.	9/11/2015	
THREE PLACE DECIMAL ± .015	THIRD ANGLE:		CONNECTOR, TYPE-D, IN-VACUUM, PEEK, 15 PINS, MALE
MATERIAL			
	APPLICATION		
	NEXT ASSY	USED ON	DOWNLOADED FROM MPFPI.COM
FINISH	SURFACE FINISH: $\sqrt{32}$ OR BETTER		DWG. NO.
PLATING	UNLESS OTHERWISE SPECIFIED:		A2376-1-CN
	ALL DIAMETERS CONCENTRIC WITHIN .005. REMOVE ALL BURRS AND SHARP EDGES		REV
	Wednesday, February 13, 2019 2:47:29 PM		