

# MPF PRODUCTS INC.

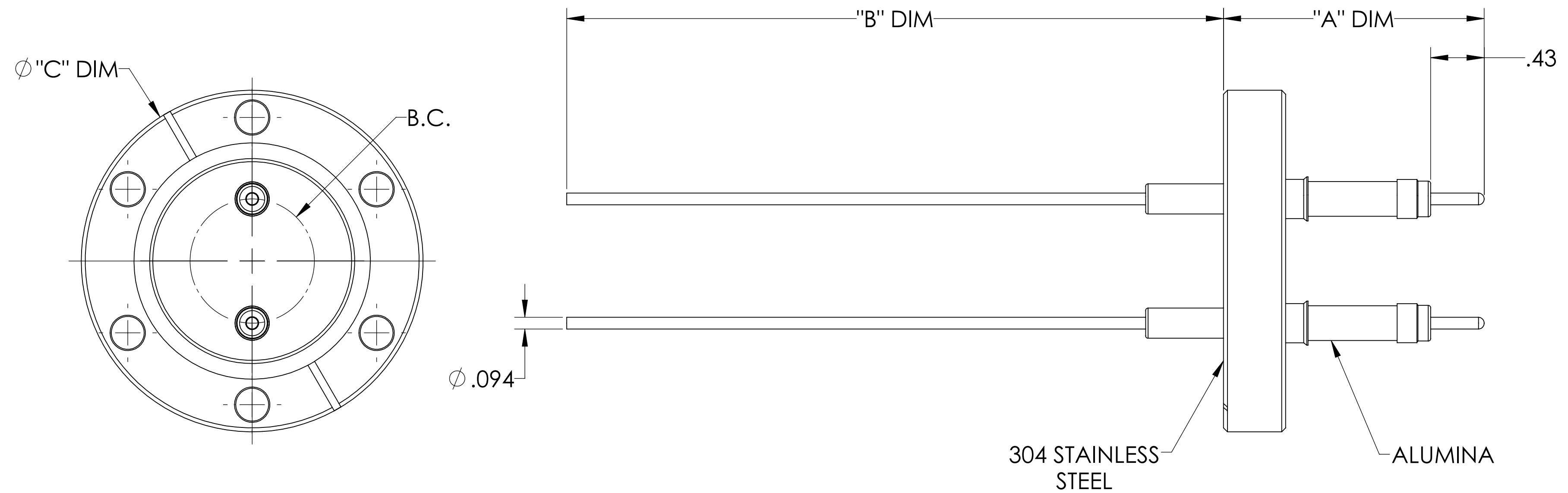

PART #	"C" DIM	"B" DIM	"A" DIM	# OF CONDUCTORS	B.C.
A2523-1-CF	1.33	5.50	1.88	1	N/A
A2523-2-CF	2.75	5.30	2.09	1	N/A
A2523-3-CF	2.75	5.30	2.09	2	1.00
A2523-4-CF	2.75	5.30	2.09	3	1.00
A2523-5-CF	2.75	5.30	2.09	4	1.00

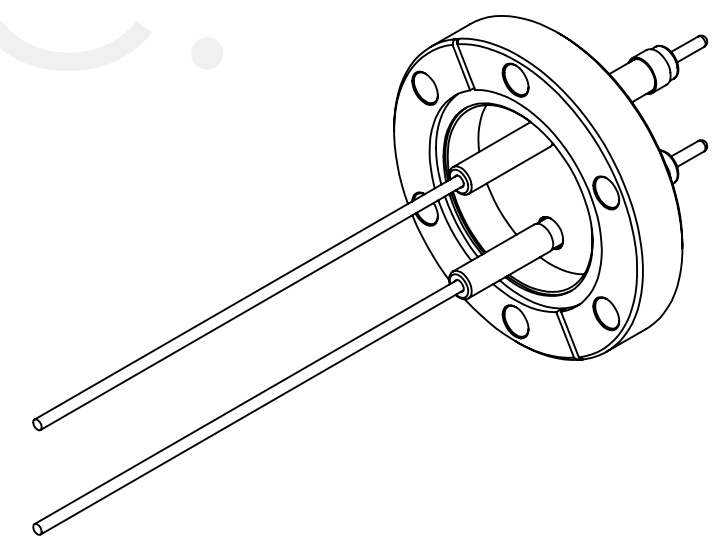
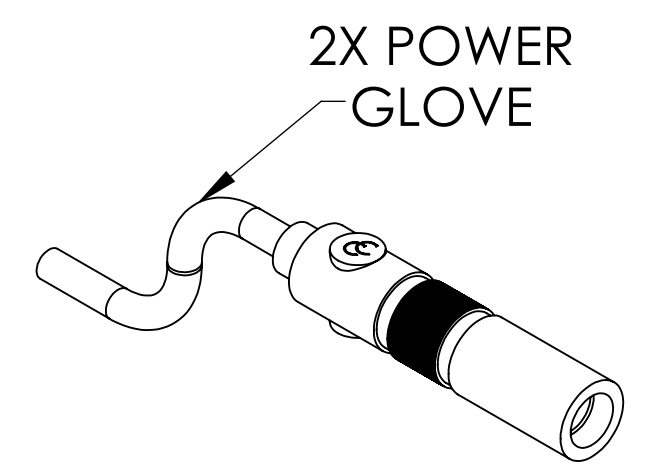

- NOTE:**
- VOLTAGE: 10,000 VOLTS DC
  - CURRENT: 30 AMPS
  - TEMPERATURE RATING: -100 TO 450°C

Power Feedthrough W/ Power Gloves, 10 KV, 0.094" Copper Conductors, Conflat Flange, UHV Rated, Bakeable to 450°C

UNLESS OTHERWISE SPECIFIED:		QUOTATION #		N/A		
DIMENSIONS ARE IN INCHES		NAME	DATE	<b>MPF PRODUCTS INC.</b> TITLE: POWER GLOVES, 10 KV, CONFLAT FLANGE DOWNLOADED FROM MPFPI.COM DWG. NO. <b>A2523</b>		
TOLERANCES:		DRAWN	WJ			9/11/2015
ANGULAR: MACH ± 1/2°		CHECKED	WJ			9/11/2015
TWO PLACE DECIMAL ± .030		ENG APPR.	WJ			9/11/2015
THREE PLACE DECIMAL ± .015		THIRD ANGLE:				
MATERIAL		APPLICATION				
		NEXT ASSY	USED ON			
FINISH		SURFACE FINISH:		63/ OR BETTER		
PLATING		UNLESS OTHERWISE SPECIFIED:		ALL DIAMETERS CONCENTRIC WITHIN .005. REMOVE ALL BURRS AND SHARP EDGES		
		TUESDAY, JANUARY 22, 2019 11:35:25 AM		REV		