

# MPF PRODUCTS INC.

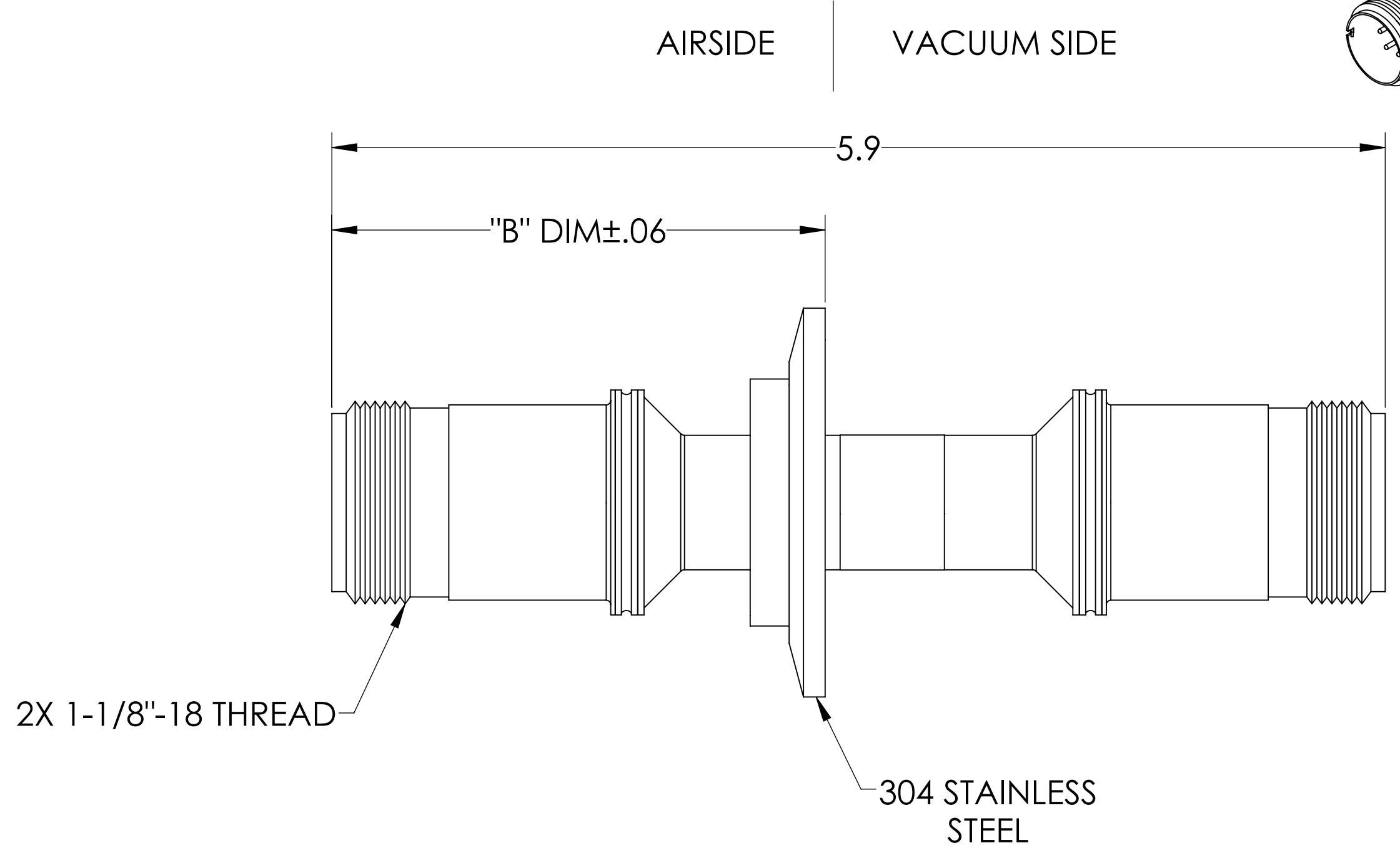

PART #	"A" DIM	"B" DIM
A2564-1-QF	2.16	2.74
A2564-2-QF	2.95	2.64

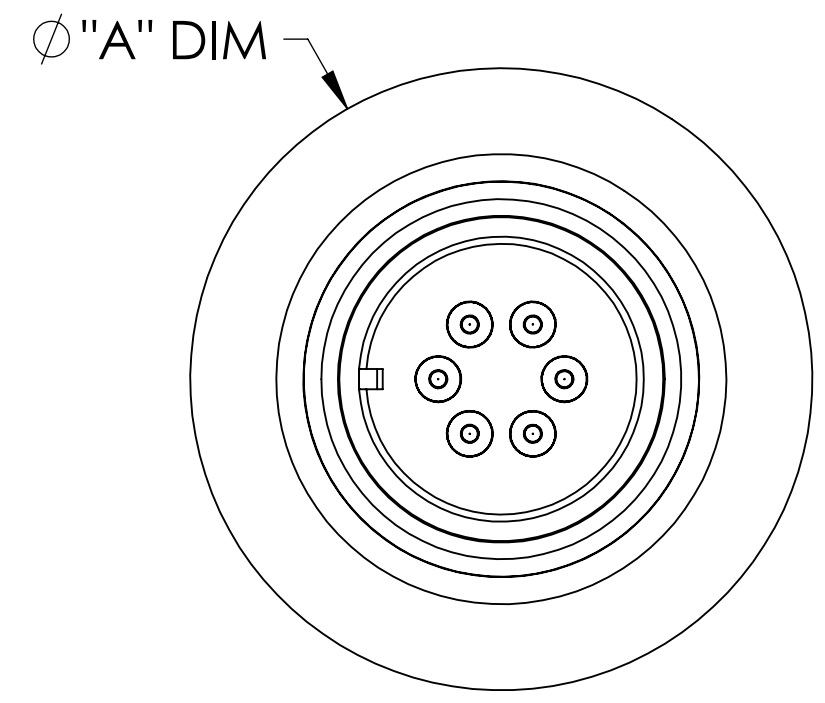
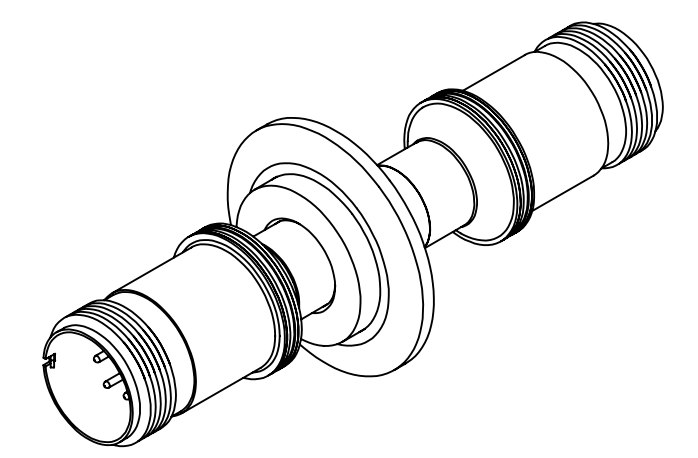
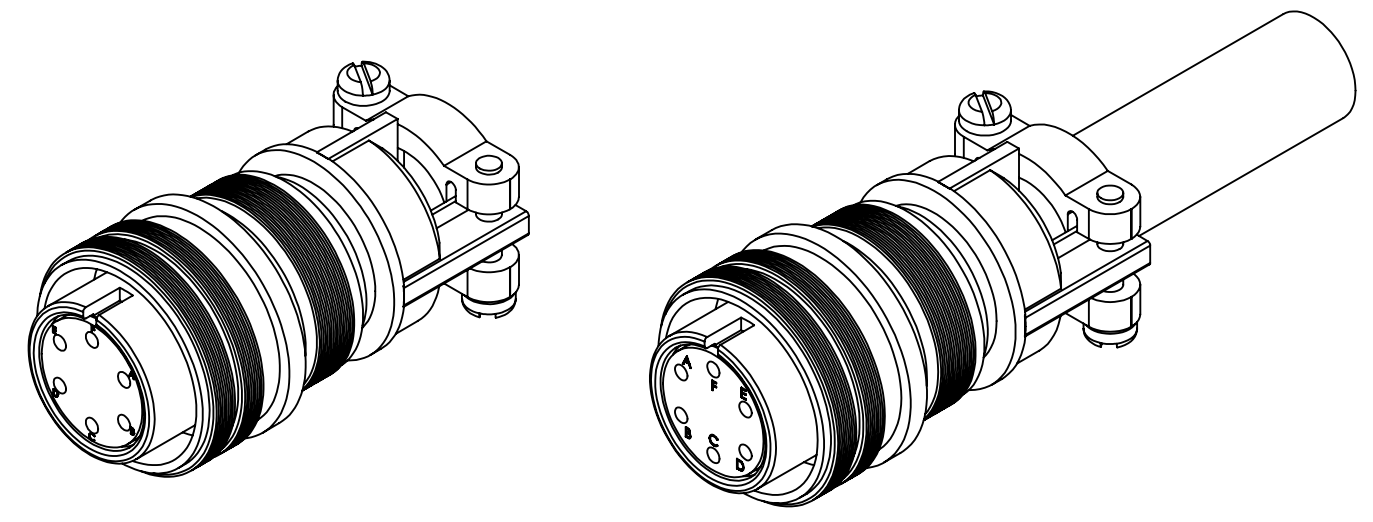

**SPECIFICATIONS:**

1. VOLTAGE: 700 VOLTS DC
2. CURRENT: 10 AMPS PER PIN, 36 AMPS FULL LOAD
3. TEMPERATURE RATING: -100 TO 450°C WITHOUT CONNECTOR
4. VACUUM SIDE CONNECTOR RATED FOR -100 TO 350 °C
5. LEAK RATE < 1X10-9 ATM CC/SEC HE

MS Series, Multipin Feedthrough, 6 Pins, 700 Volts, 10 Amps per Pin, Double-Ended w/ Air & Vacuum-side Connectors, QF/KF

UNLESS OTHERWISE SPECIFIED:		QUOTATION #		N/A	
DIMENSIONS ARE IN INCHES		NAME	DATE	MPF PRODUCTS INC.	
TOLERANCES:		DRAWN	9/11/2015		
ANGULAR: MACH ± 1/2°		CHECKED	9/11/2015		
TWO PLACE DECIMAL ± .030		ENG APPR.	9/11/2015		
THREE PLACE DECIMAL ± .015		THIRD ANGLE:		MULTIPIN, 6 PINS, 700V, 10 A, DOUBLE ENDED, QF/KF	
MATERIAL					
FINISH		APPLICATION			
PLATING		NEXT ASSY	USED ON	DOWNLOADED FROM MPFPI.COM	
SURFACE FINISH: 63/ OR BETTER		UNLESS OTHERWISE SPECIFIED:		DWG. NO.	REV
ALL DIAMETERS CONCENTRIC WITHIN .005. REMOVE ALL BURRS AND SHARP EDGES		A2564		Thursday, February 7, 2019 8:46:01 AM	