

MPF PRODUCTS INC.

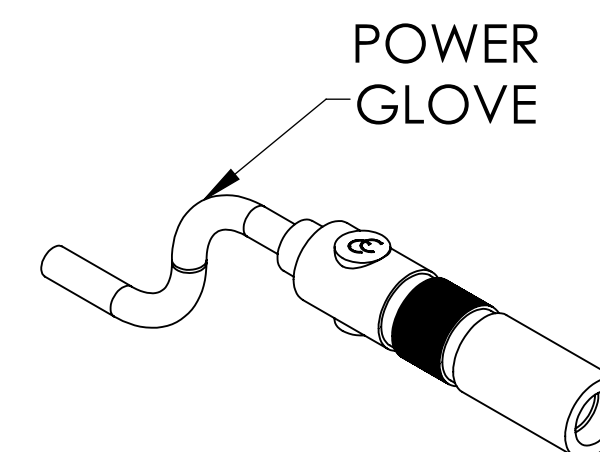
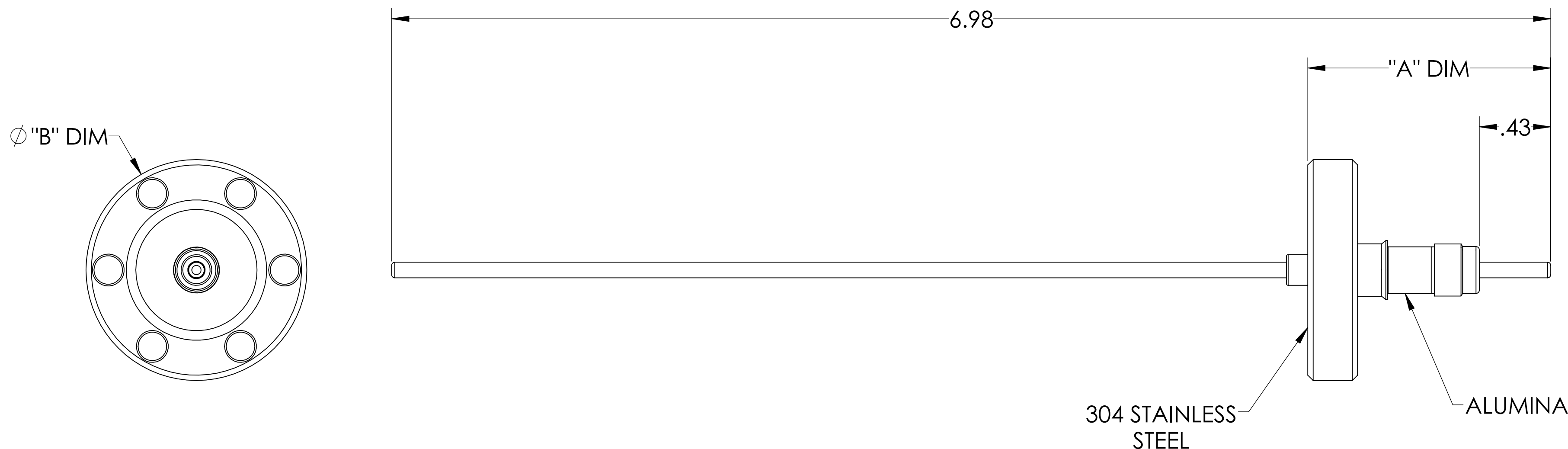
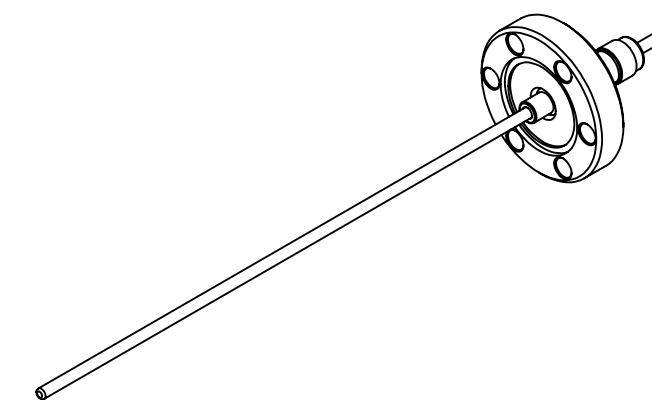

PART #	"A" DIM	"B" DIM	CURRENT RATING
A2597-1-CF	1.47	1.33	30 AMPS
A2597-2-CF	1.68	2.75	15 AMPS

NOTE:

1. VOLTAGE: 5,000 VOLTS DC
2. CURRENT: 30 AMP
3. TEMPERATURE RATING: -100 TO 450°C

Power Feedthrough W/ Power Glove, 5,000 Volts, 1 Pin, 0.094" Copper Conductor, Conflat Flange, UHV Rated, Bakeable to 450°C

UNLESS OTHERWISE SPECIFIED:	QUOTATION #		N/A
DIMENSIONS ARE IN INCHES	NAME	DATE	MPF PRODUCTS INC.
TOLERANCES:	DRAWN	9/11/2015	
ANGULAR: MACH ± 1/2°	CHECKED	9/11/2015	
TWO PLACE DECIMAL ± .030	ENG APPR.	9/11/2015	
THREE PLACE DECIMAL ± .015	THIRD ANGLE:		TITLE: POWER GLOVE, 5000 VOLTS, 1 PIN, CONFLAT FLANGE
MATERIAL			
FINISH	APPLICATION		DOWNLOADED FROM MPFPI.COM
PLATING	NEXT ASSY	USED ON	
	SURFACE FINISH: 63/ OR BETTER		DWG. NO. A2597
	UNLESS OTHERWISE SPECIFIED:		REV
	ALL DIAMETERS CONCENTRIC WITHIN .005. REMOVE ALL BURRS AND SHARP EDGES		Tuesday, January 22, 2019 11:39:41 AM