

# MPF PRODUCTS INC.

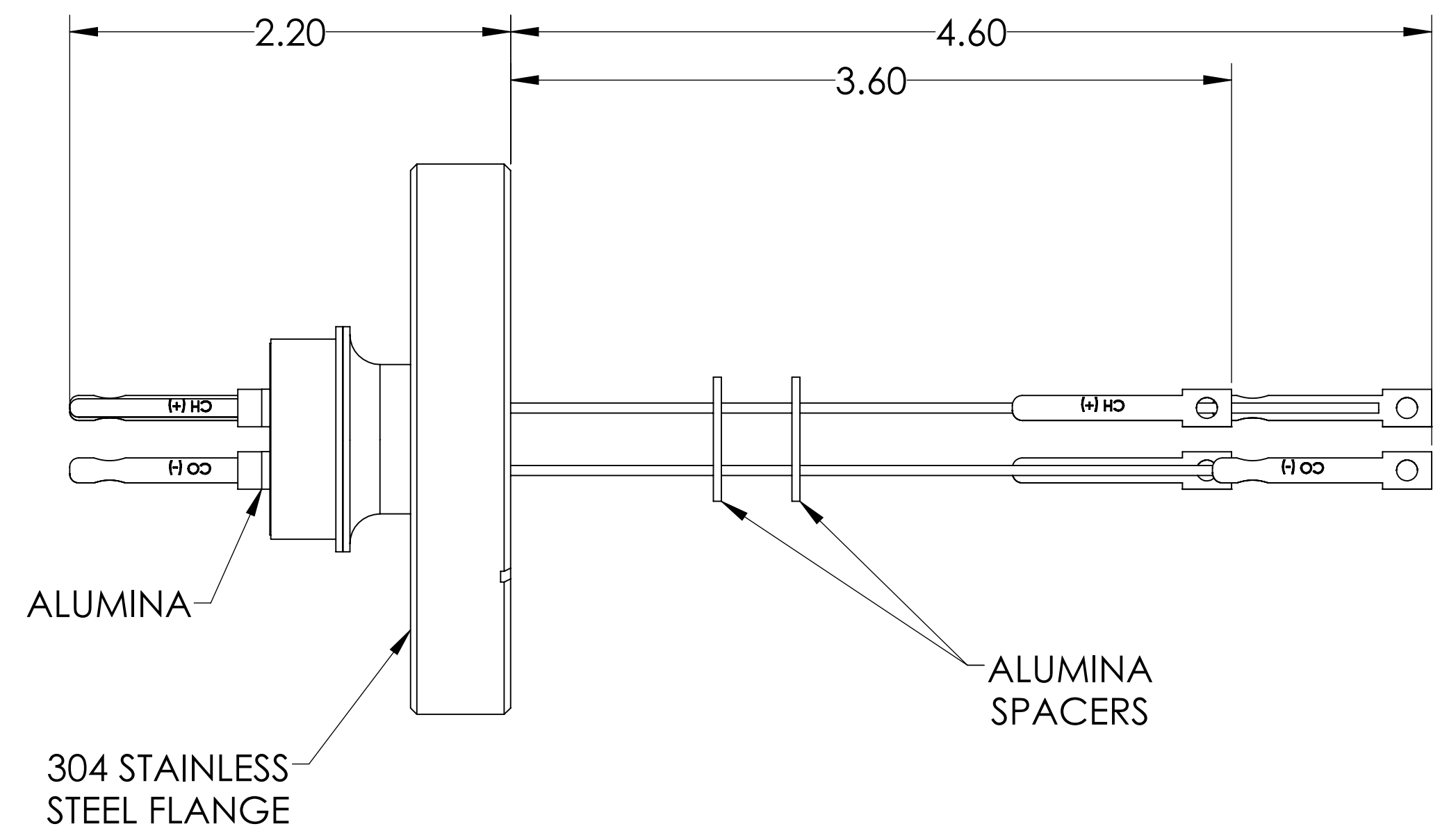

PART #	T/C TYPE
A2612-1-CF	J
A2612-2-CF	K
A2612-3-CF	C
A2612-4-CF	E

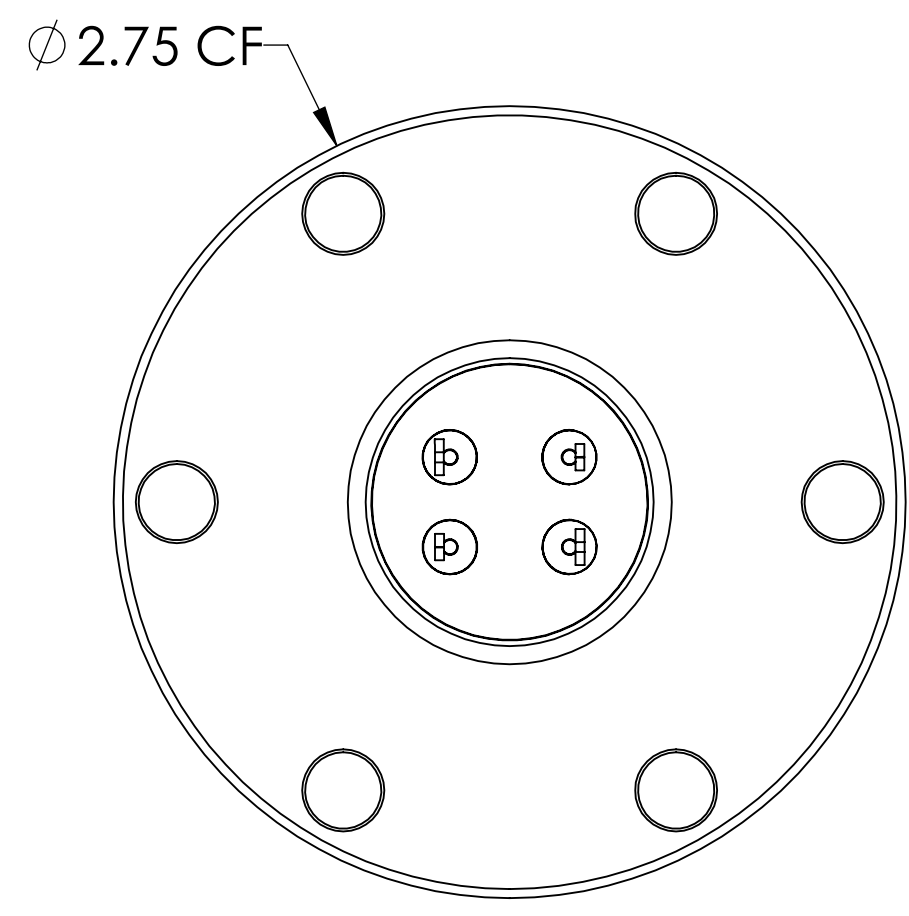
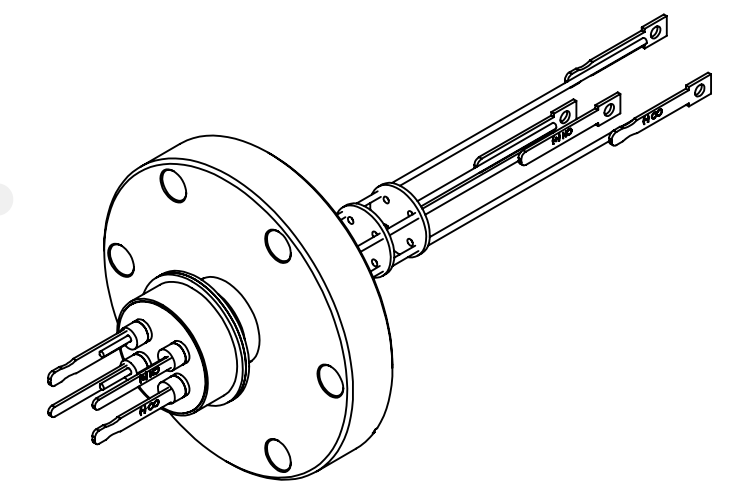
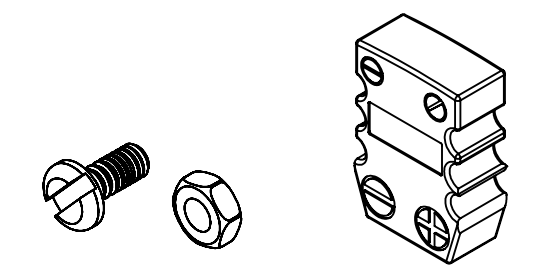

- SPECIFICATIONS:**
- TEMPERATURE RATING: -100 TO 450°C
  - LEAK RATE < 1X10-9 ATM CC/SEC HE

Thermocouple Feedthrough, 2 Pairs, Miniature Connector, 2.75" Conflat Flange

UNLESS OTHERWISE SPECIFIED:		QUOTATION #		N/A	
DIMENSIONS ARE IN INCHES TOLERANCES:		NAME	DATE	MPF PRODUCTS INC.	
ANGULAR: MACH ± 1/2°		DRAWN	9/11/2015		
TWO PLACE DECIMAL ± .030		CHECKED	9/11/2015		
THREE PLACE DECIMAL ± .015		ENG APPR.	9/11/2015		
MATERIAL		THIRD ANGLE:		TITLE:	
				THERMOCOUPLE, 2 PAIRS, CONNECTOR, 275CF	
FINISH		APPLICATION		NEXT ASSY	
PLATING		SURFACE FINISH: 63/ OR BETTER		USED ON	
		UNLESS OTHERWISE SPECIFIED:		DOWNLOADED FROM MPFPI.COM	
		ALL DIAMETERS CONCENTRIC WITHIN .005. REMOVE ALL BURRS AND SHARP EDGES		DWG. NO. A2612	
				REV	
				Friday, February 8, 2019 1:03:02 PM	