

MPF PRODUCTS INC.

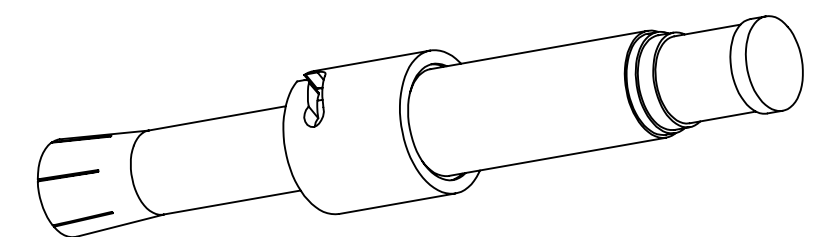
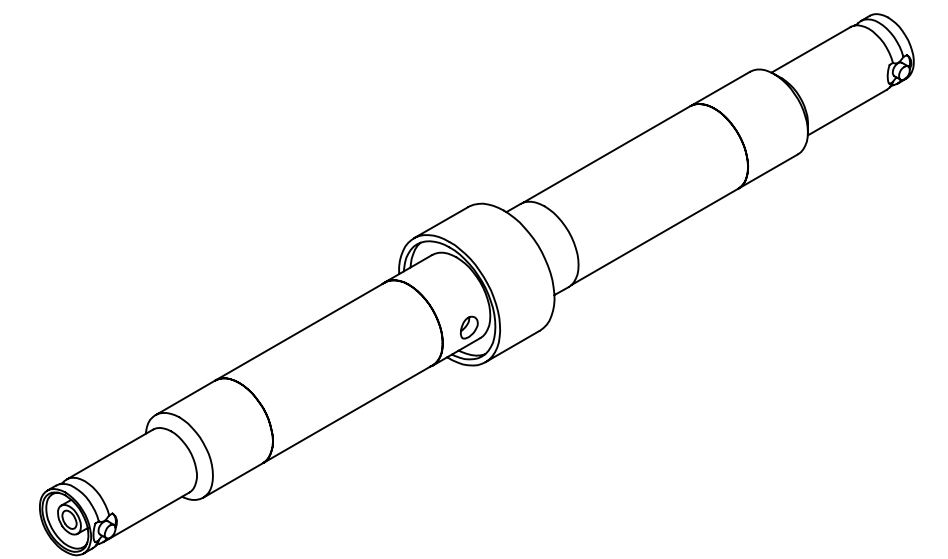
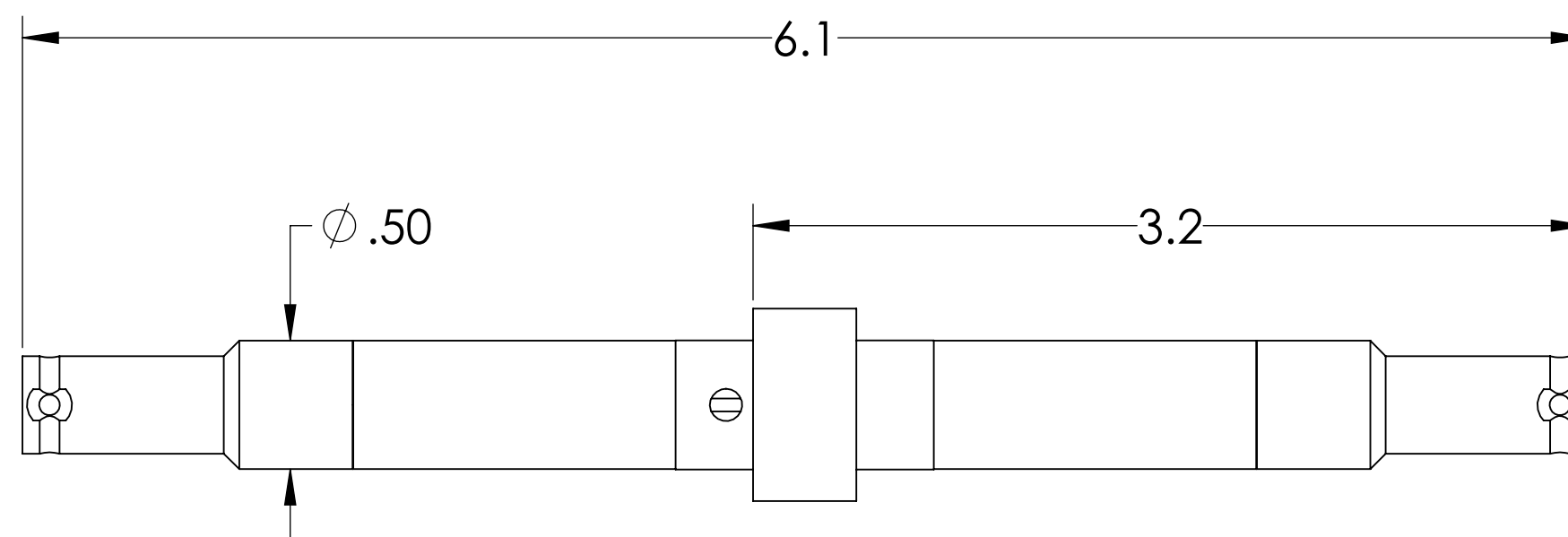
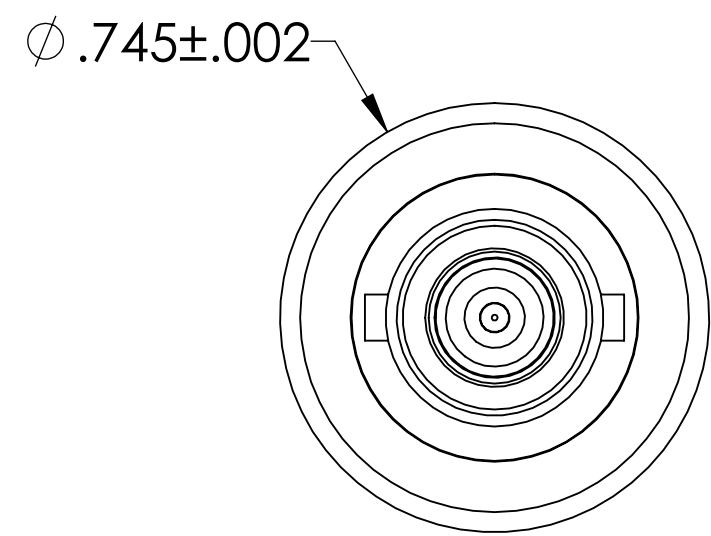

PART #	AIRSIDE CONNECTOR INCLUDED
A2613-3-W	YES
A2613-4-W	NO

NOTE:

1. SHIELD: GROUNDED
2. VOLTAGE: 10,000 VOLTS DC
3. CURRENT: 5 AMPS
4. TEMPERATURE RATING: -200 TO 450°C (FEEDTHROUGH), 65 TO 165°C (AIRSIDE CONNECTOR)
5. IMPEDANCE: NON-CONSTANT

SHV-10 Coaxial Feedthrough, 1 Pin, Grounded Shield, Double Ended, 0.745" Dia SS Weld Adapter, UHV Compatible

UNLESS OTHERWISE SPECIFIED:	QUOTATION #	N/A					
DIMENSIONS ARE IN INCHES TOLERANCES:	DRAWN	NAME	DATE				
ANGULAR: MACH $\pm 1/2^\circ$	WJ	WJ	9/11/2015				
TWO PLACE DECIMAL $\pm .030$	CHECKED		9/11/2015				
THREE PLACE DECIMAL $\pm .015$	ENG APPR.	WJ	9/11/2015				
MATERIAL	THIRD ANGLE:						
FINISH	APPLICATION	<table border="1"> <tr> <th>NEXT ASSY</th> <th>USED ON</th> </tr> <tr> <td> </td> <td> </td> </tr> </table>		NEXT ASSY	USED ON		
NEXT ASSY	USED ON						
PLATING	SURFACE FINISH:	<table border="1"> <tr> <td>63</td> <td>OR BETTER</td> </tr> </table>		63	OR BETTER		
63	OR BETTER						
	UNLESS OTHERWISE SPECIFIED:	TITLE: SHV-10 COAXIAL FEEDTHROUGH, 1 PIN, GROUNDED SHIELD, DOUBLE ENDED 0.745" DIA SS WELD ADAPTER DWG. NO. A2613 REV.					
	ALL DIAMETERS CONCENTRIC WITHIN .005. REMOVE ALL BURRS AND SHARP EDGES	DOWNLOADED FROM MPFPI.COM Friday, January 18, 2019 10:25:21 AM					