

MPF PRODUCTS INC.

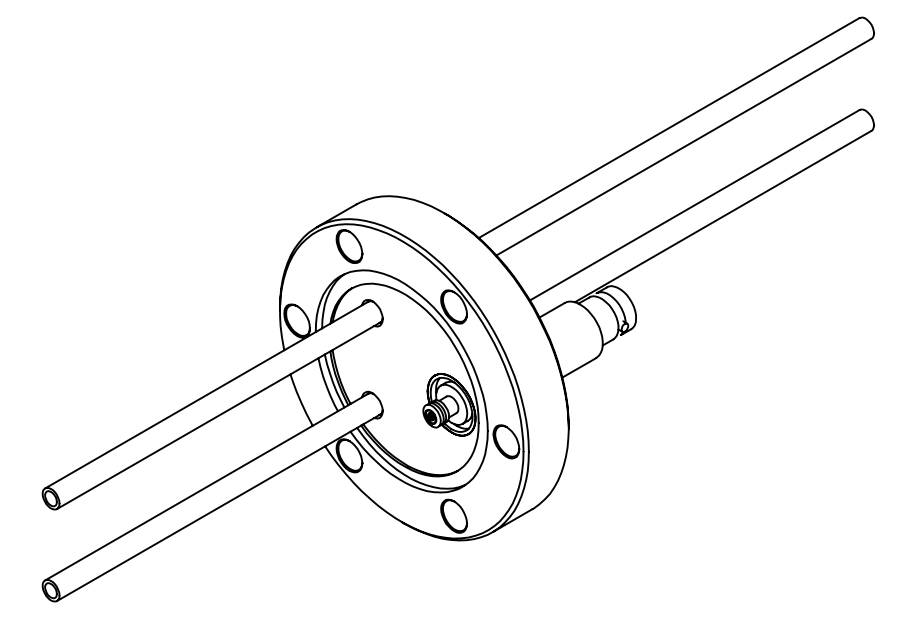
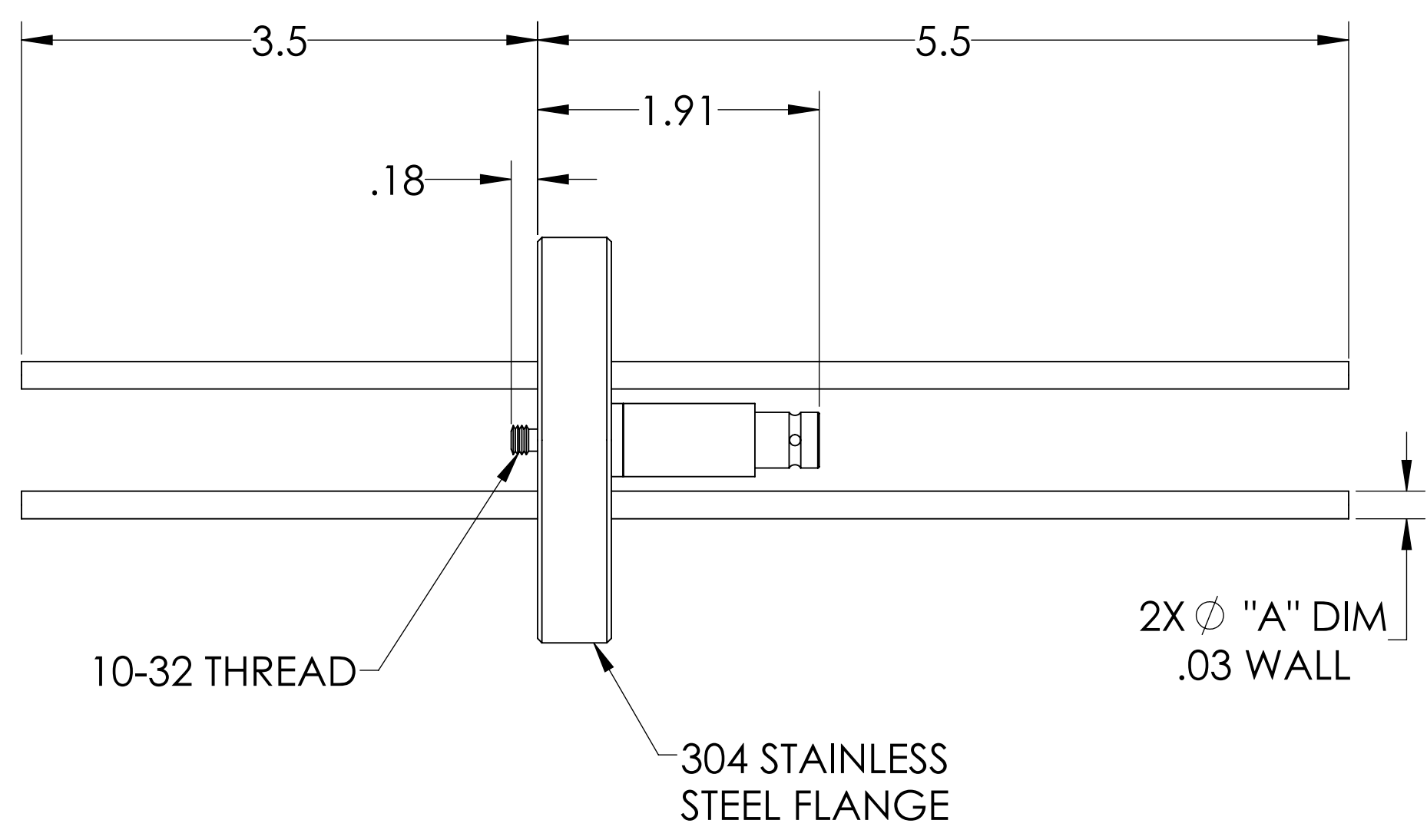
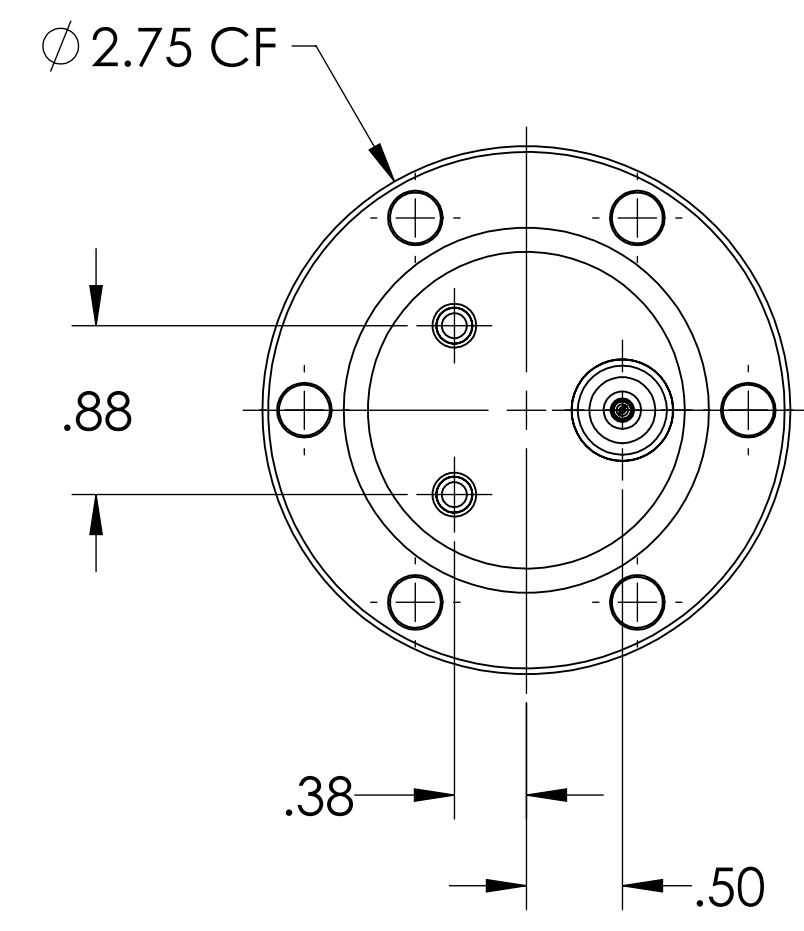

PART #	"A" DIM	CONNECTOR
A2728-1-CF	.19	YES
A2728-2-CF	.25	YES
A2728-3-CF	.19	N/A
A2728-4-CF	.25	N/A

NOTE:

1. SHIELD: GROUNDED
2. VOLTAGE: 500 VOLTS DC
3. CURRENT: 2 AMPS
4. TEMPERATURE RATING: -200 TO 450°C (FEEDTHROUGH), 65 TO 165°C (AIRSIDE CONNECTOR)
5. IMPEDANCE: NON-CONSTANT

BNC-Microdot Crystal Sensor Feedthrough, 1 Pin + 2 Stainless Steel Tubes, 2.75" Conflat Flange

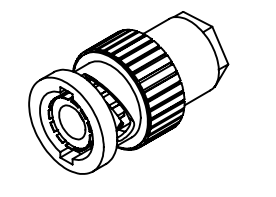

UNLESS OTHERWISE SPECIFIED:		QUOTATION #		N/A	
DIMENSIONS ARE IN INCHES TOLERANCES:		NAME	DATE	MPF PRODUCTS INC.	
ANGULAR: MACH $\pm 1/2^\circ$		DRAWN	9/11/2015		
TWO PLACE DECIMAL $\pm .030$		CHECKED	9/11/2015		
THREE PLACE DECIMAL $\pm .015$		ENG APPR.	9/11/2015		
MATERIAL		THIRD ANGLE:		TITLE: COAXIAL, BNC-MICRODOT, 1 PIN + 2 SS TUBES, GROUNDED SHIELD, 275CF	
FINISH		APPLICATION			
PLATING		NEXT ASSY USED ON			
SURFACE FINISH: $\sqrt{63}$ OR BETTER		UNLESS OTHERWISE SPECIFIED:			
ALL DIAMETERS CONCENTRIC WITHIN .005. REMOVE ALL BURRS AND SHARP EDGES		DWG. NO.		A2728	
		Saturday, January 19, 2019 7:58:30 AM		REV	