

# MPF PRODUCTS INC.

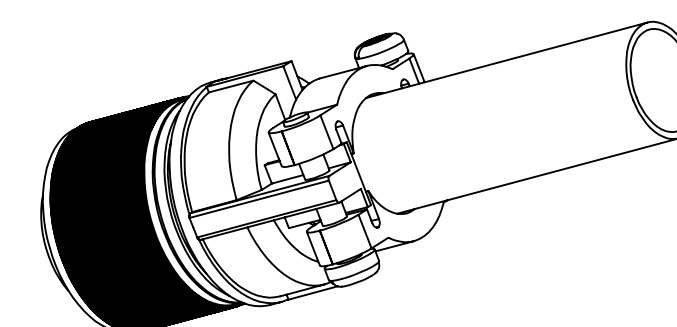
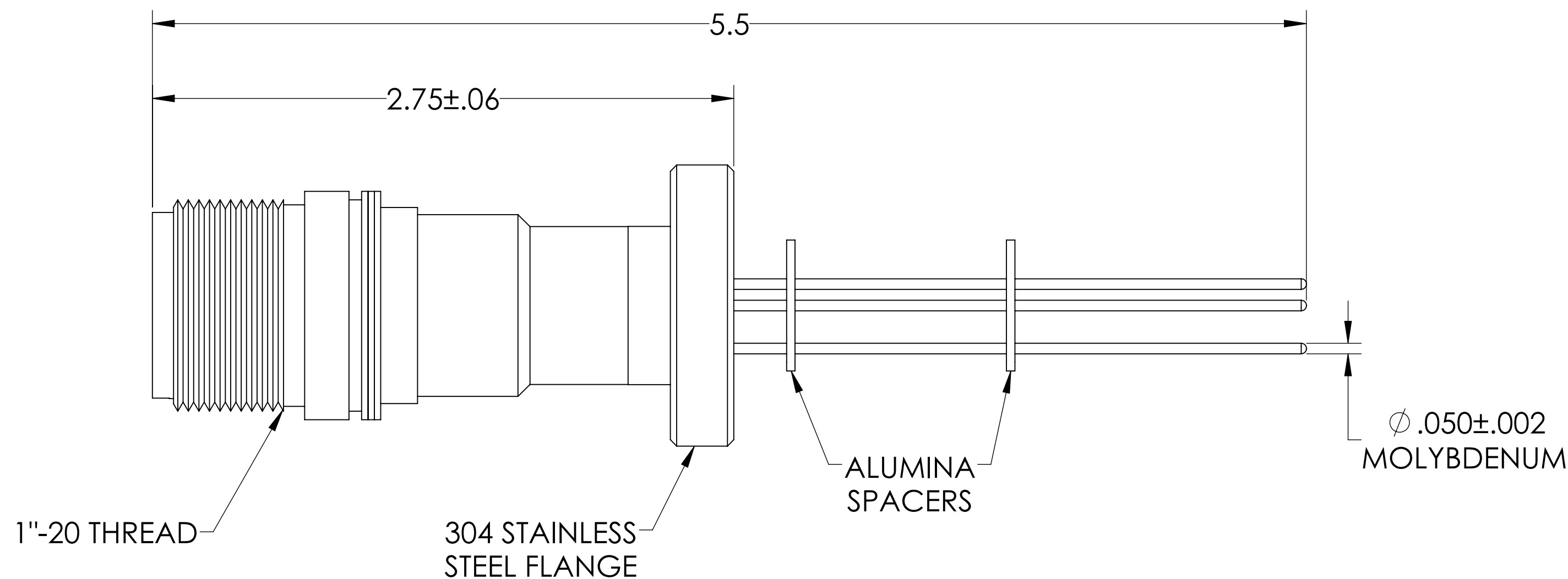
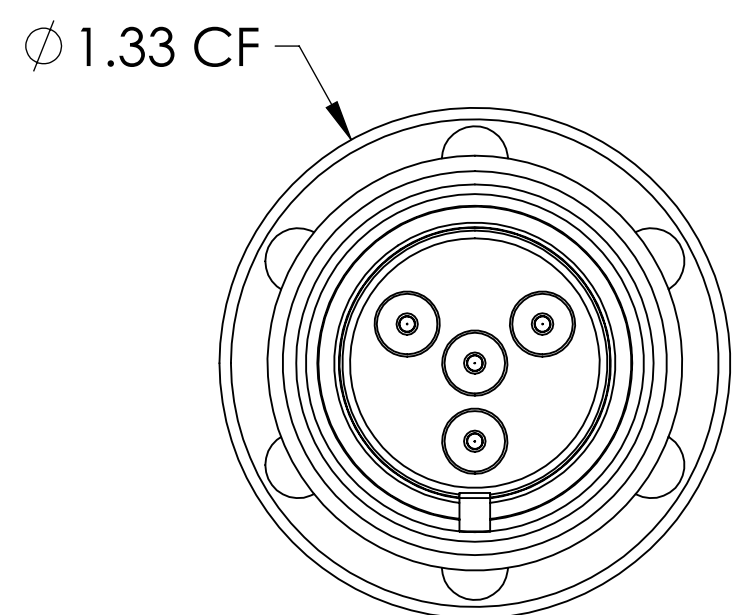
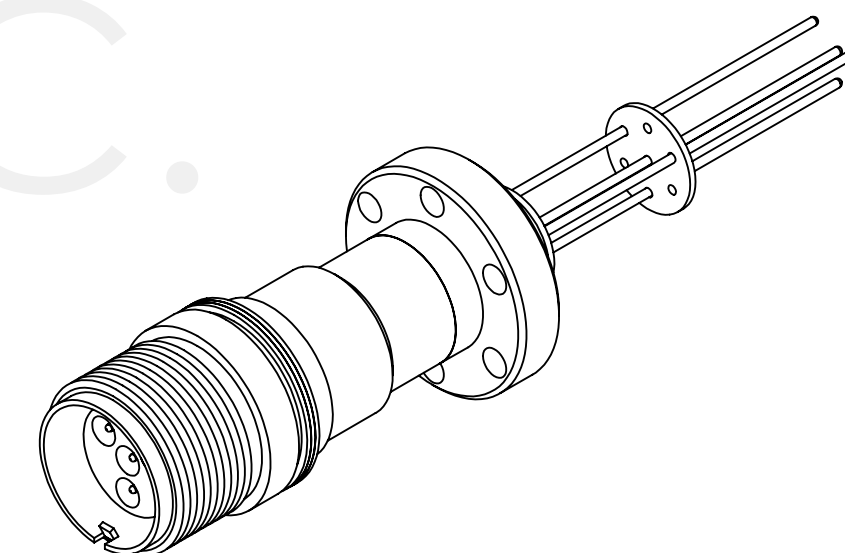

**SPECIFICATIONS:**

1. VOLTAGE: 12,000 VOLTS DC
2. CURRENT: 7.5 AMPS PER PIN
3. TEMPERATURE RATING: -100 TO 450°C WITHOUT CONNECTOR
4. LEAK RATE < 1X10-9 ATM CC/SEC HE

MS Series, Multipin Feedthrough w/ Air-side Connector, 4 Pins, 12KV, 7.5 Amps per Pin, 0.05" Moly Conductors, 1.33" Conflat Flange

UNLESS OTHERWISE SPECIFIED:		QUOTATION #		N/A		
DIMENSIONS ARE IN INCHES TOLERANCES:		NAME	DATE	<b>MPF PRODUCTS INC.</b> TITLE: <b>MULTIPIN, 4 PINS, 12KV, 7.5 A, 133CF</b>		
ANGULAR: MACH ± 1/2°		DRAWN	WJ			9/11/2015
TWO PLACE DECIMAL ± .030		CHECKED				9/11/2015
THREE PLACE DECIMAL ± .015		ENG APPR.	WJ			9/11/2015
MATERIAL		THIRD ANGLE:		DWG. NO. <b>A3971-1-CF</b> REV. _____ Monday, January 28, 2019 3:01:54 PM		
FINISH						
PLATING		SURFACE FINISH: 63/ OR BETTER UNLESS OTHERWISE SPECIFIED: ALL DIAMETERS CONCENTRIC WITHIN .005. REMOVE ALL BURRS AND SHARP EDGES				
		APPLICATION		DOWNLOADED FROM MPFPI.COM		
		NEXT ASSY	USED ON			