

MPF PRODUCTS INC

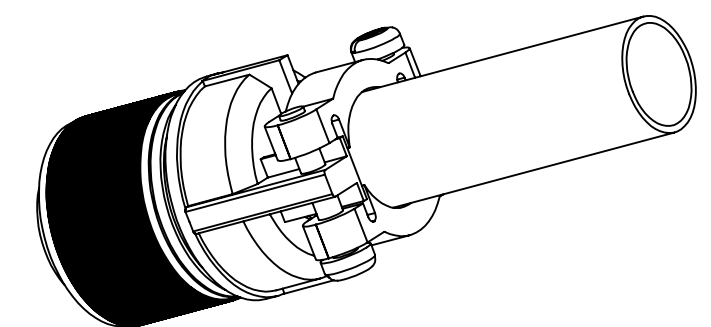
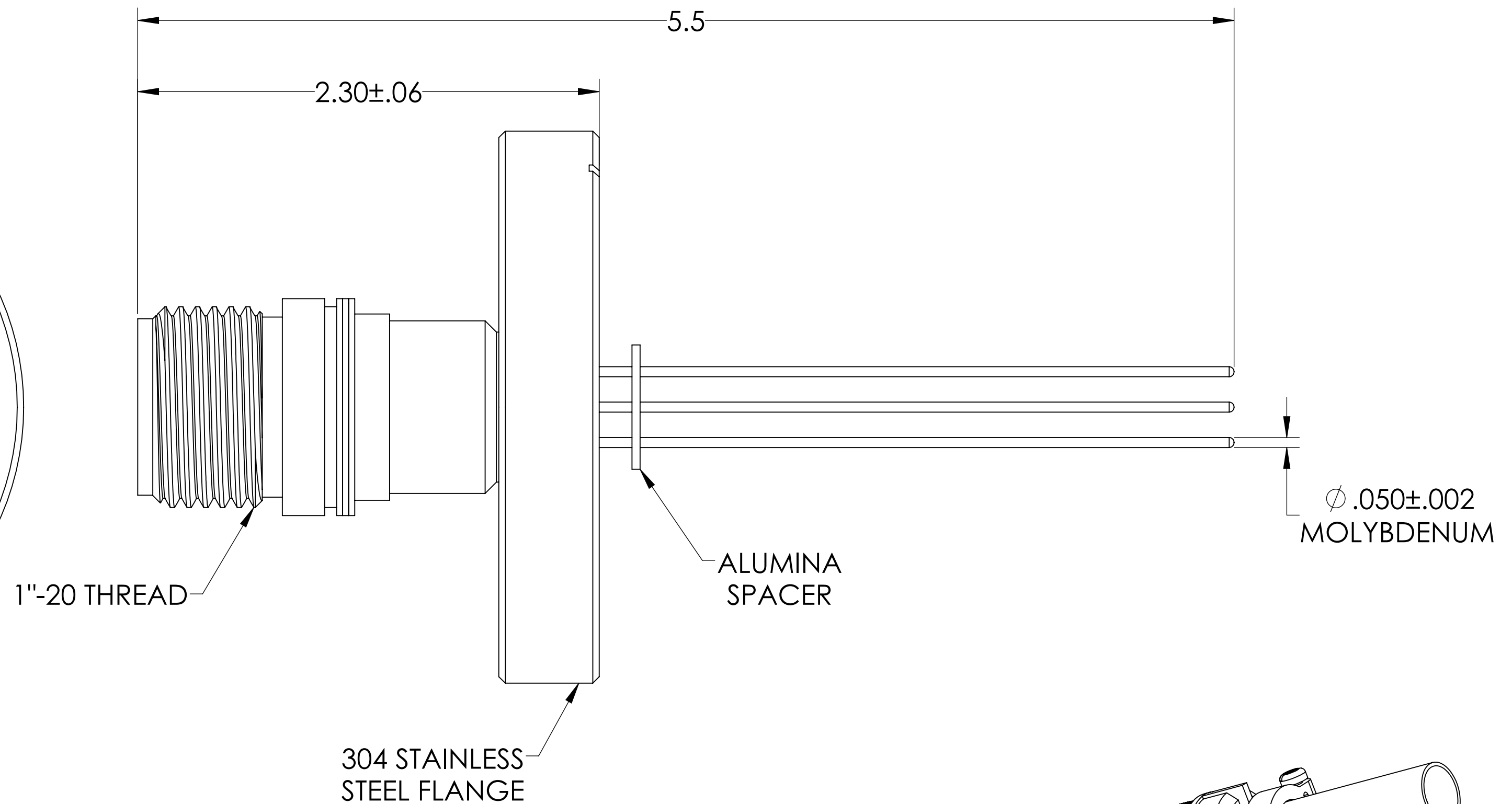
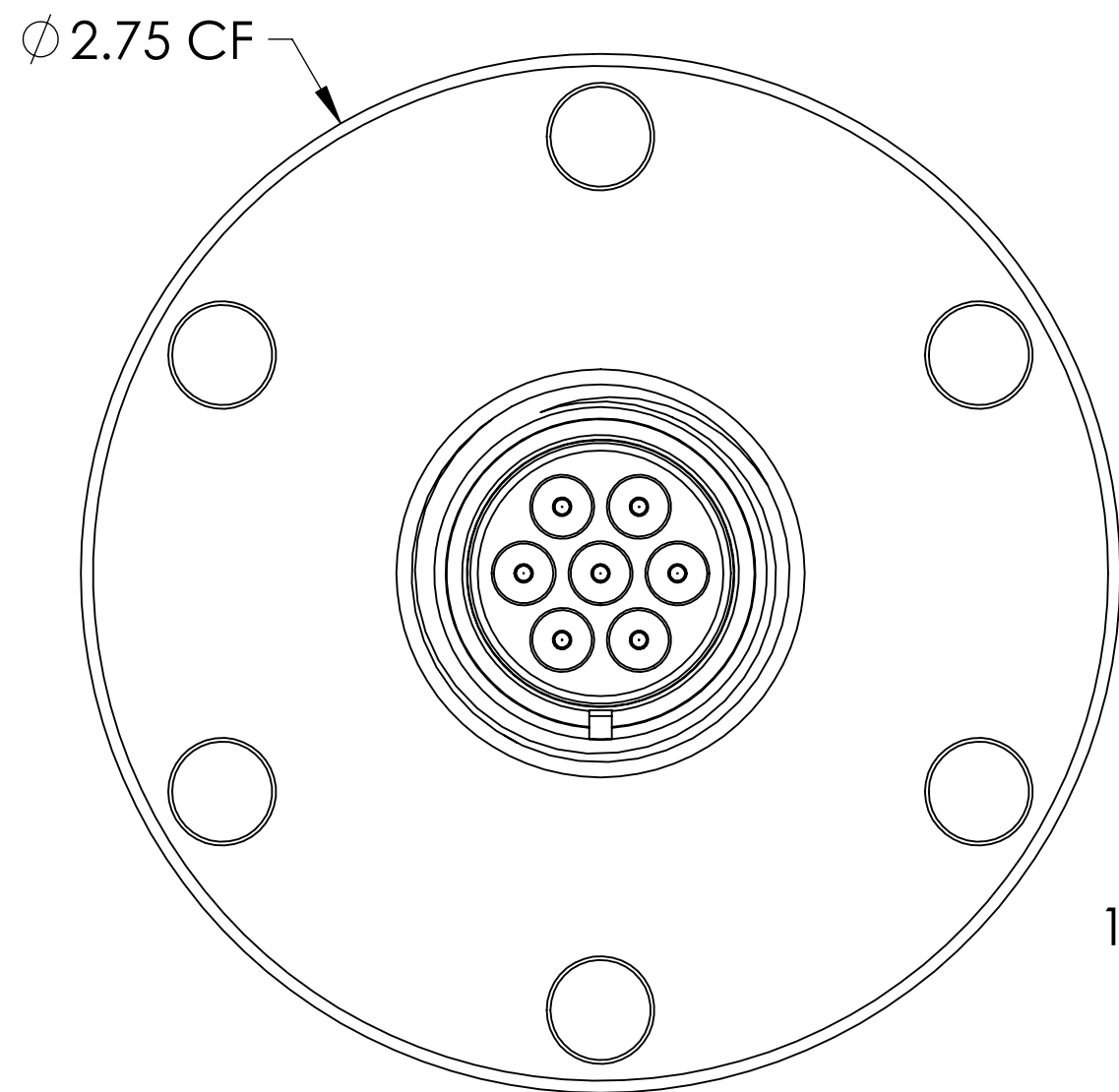
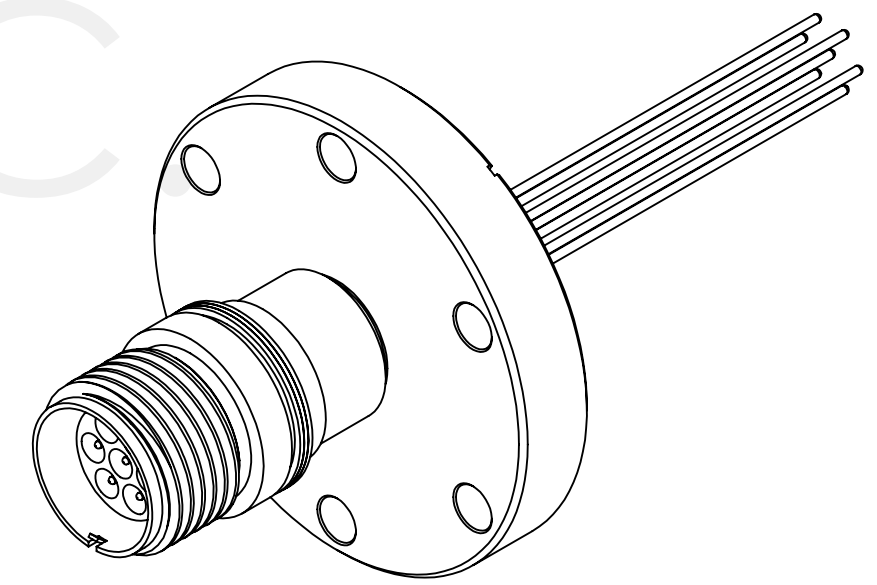

SPECIFICATIONS:

1. VOLTAGE: 12,000 VOLTS DC
2. CURRENT: 7.5 AMPS PER PIN
3. TEMPERATURE RATING: -100 TO 450°C WITHOUT CONNECTOR
4. LEAK RATE < 1X10-9 ATM CC/SEC HE

MS Series, Multipin Feedthrough w/ Air-side Connector, 7 Pins, 12KV, 7.5 Amps per Pin, 0.05" Moly Conductors, 2.75" Conflat Flange

UNLESS OTHERWISE SPECIFIED:	QUOTATION #	N/A	
DIMENSIONS ARE IN INCHES TOLERANCES:	NAME	DATE	MPF PRODUCTS INC.
ANGULAR: MACH ± 1/2°	DRAWN	9/11/2015	
TWO PLACE DECIMAL ± .030	CHECKED	9/11/2015	
THREE PLACE DECIMAL ± .015	ENG APPR.	WJ 9/11/2015	
MATERIAL	THIRD ANGLE:	TITLE:	
		MULTIPIN, 7 PINS, 12KV, 7.5 A, 275CF	
FINISH	APPLICATION	DOWNLOADED FROM MPFPI.COM	
PLATING	SURFACE FINISH: 63/ OR BETTER	DWG. NO.	REV
	UNLESS OTHERWISE SPECIFIED:	A3977-1-CF	
	ALL DIAMETERS CONCENTRIC WITHIN .005. REMOVE ALL BURRS AND SHARP EDGES	Monday, January 28, 2019 3:07:55 PM	