

# MPF PRODUCTS INC.

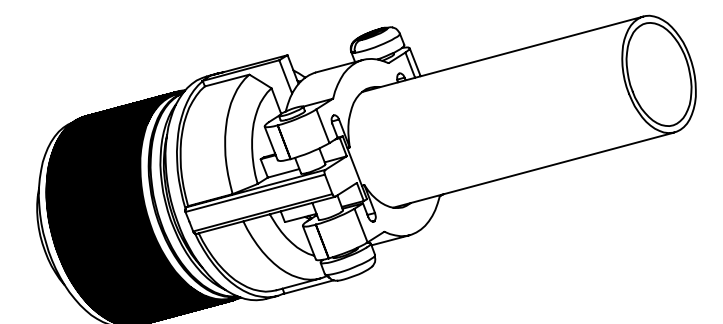
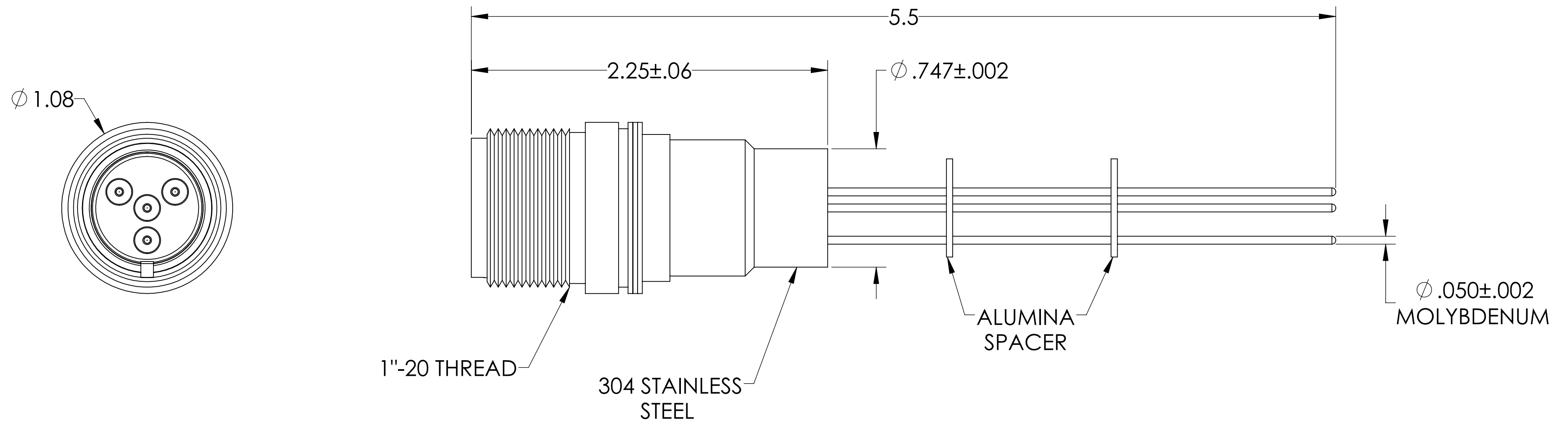
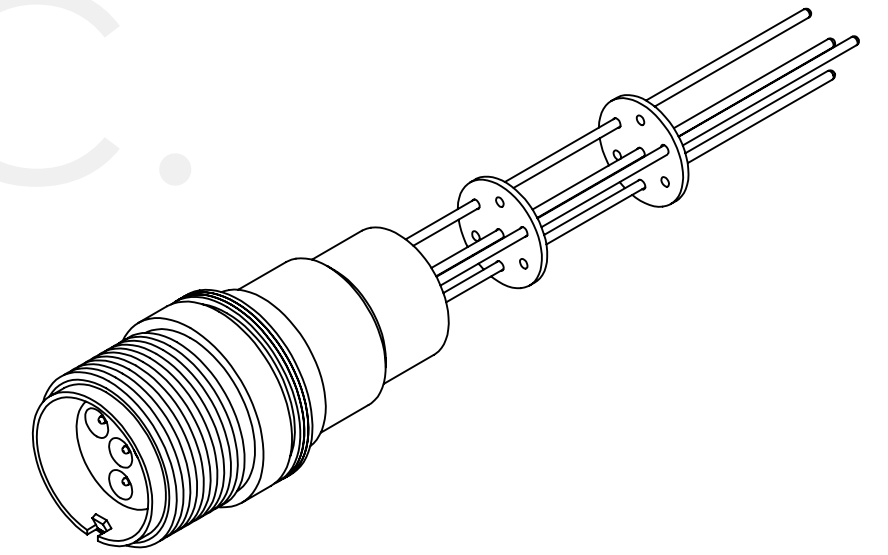

**SPECIFICATIONS:**

1. VOLTAGE: 12,000 VOLTS DC
2. CURRENT: 7.5 AMPS PER PIN
3. TEMPERATURE RATING: -100 TO 450°C WITHOUT CONNECTOR
4. LEAK RATE < 1X10-9 ATM CC/SEC HE

MS Series, Multipin Feedthrough w/ Air-side Connector, 4 Pins, 12KV, 7.5 Amps per Pin, 0.05" Moly Conductors, 0.75" Weld Adapter

UNLESS OTHERWISE SPECIFIED:	QUOTATION #	N/A					
DIMENSIONS ARE IN INCHES TOLERANCES:	DRAWN	NAME	DATE				
ANGULAR: MACH ± 1/2°	WJ	WJ	9/11/2015				
TWO PLACE DECIMAL ± .030	CHECKED		9/11/2015				
THREE PLACE DECIMAL ± .015	ENG APPR.	WJ	9/11/2015				
MATERIAL	THIRD ANGLE:						
FINISH	APPLICATION	<table border="1"> <tr> <th>NEXT ASSY</th> <th>USED ON</th> </tr> <tr> <td> </td> <td> </td> </tr> </table>		NEXT ASSY	USED ON		
NEXT ASSY	USED ON						
PLATING	SURFACE FINISH:	63/ OR BETTER					
	UNLESS OTHERWISE SPECIFIED:	ALL DIAMETERS CONCENTRIC WITHIN .005. REMOVE ALL BURRS AND SHARP EDGES					
	TITLE:	MULTIPIN, 4 PINS, 12KV, 7.5 A, .747" WELD ADAPTER					
	DOWNLOADED FROM MPFPI.COM						
	DWG. NO.	A4208-1-W	REV				
	Monday, January 28, 2019 4:07:19 PM						