

MPF PRODUCTS INC.

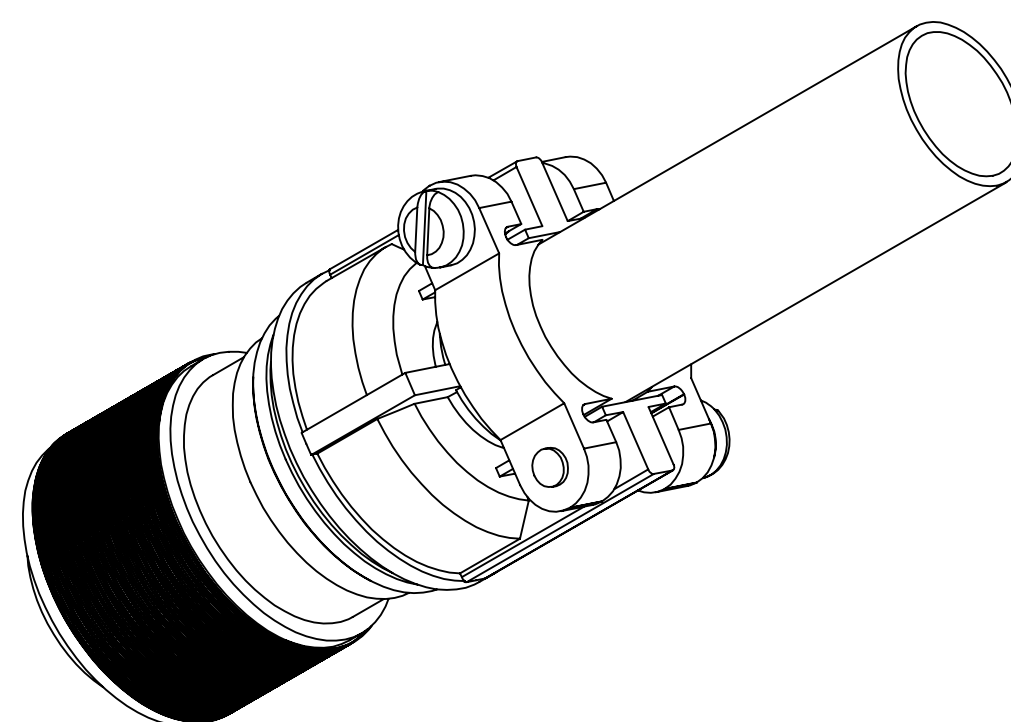

SPECIFICATIONS:
 1. TEMPERATURE RATING: UP TO 125 °C

MS Series Air-side Connector, 2 Pins, 12000 Volts, 7.5 Amps per Pin, Accepts 0.040" Dia Pins

UNLESS OTHERWISE SPECIFIED:		QUOTATION #		N/A	
DIMENSIONS ARE IN INCHES		NAME	DATE	MPF PRODUCTS INC. TITLE: MS CIRCULAR CONNECTOR, 12KV, 7.5A, 2 PIN	
TOLERANCES:		DRAWN	9/11/2015		
ANGULAR: MACH ± 1/2°		CHECKED	9/11/2015		
TWO PLACE DECIMAL ± .030		ENG APPR.	9/11/2015		
THREE PLACE DECIMAL ± .015		THIRD ANGLE:		DOWNLOAD FROM MPFPI.COM DWG. NO. A4213-1-CN REV	
MATERIAL					
		APPLICATION			
		NEXT ASSY	USED ON		
FINISH		SURFACE FINISH: 63/ OR BETTER			
PLATING		UNLESS OTHERWISE SPECIFIED:			
		ALL DIAMETERS CONCENTRIC WITHIN .005. REMOVE ALL BURRS AND SHARP EDGES		Thursday, February 14, 2019 8:13:17 AM	