

MPF PRODUCTS INC.

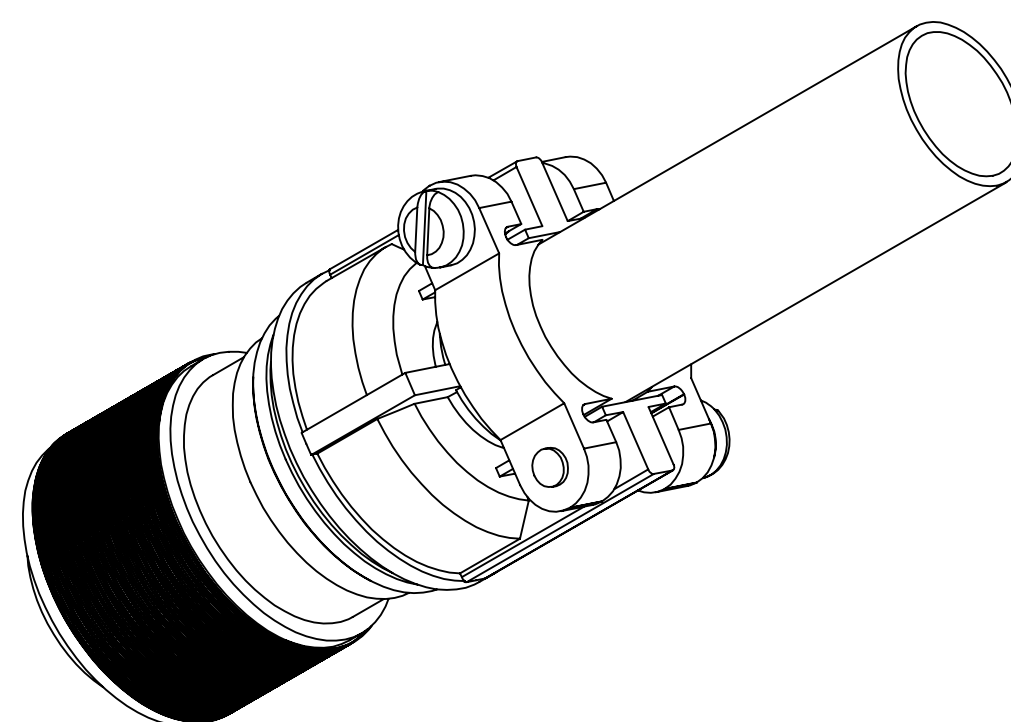

SPECIFICATIONS:
1. TEMPERATURE RATING: UP TO 125 °C

MS Series Air-side Connector, 4 Pins, 12000 Volts, 7.5 Amps per Pin, Accepts 0.040" Dia Pins

UNLESS OTHERWISE SPECIFIED:	QUOTATION #		N/A
DIMENSIONS ARE IN INCHES TOLERANCES:	NAME	DATE	MPF PRODUCTS INC.
ANGULAR: MACH ± 1/2°	DRAWN	9/11/2015	
TWO PLACE DECIMAL ± .030	CHECKED	9/11/2015	
THREE PLACE DECIMAL ± .015	ENG APPR.	9/11/2015	
MATERIAL	THIRD ANGLE:		TITLE: MS CIRCULAR CONNECTOR, 12KV, 7.5A, 4 PIN
	APPLICATION		DOWNLOADED FROM MPFPI.COM
	NEXT ASSY	USED ON	
FINISH	SURFACE FINISH: 63/ OR BETTER		DWG. NO.
PLATING	UNLESS OTHERWISE SPECIFIED: ALL DIAMETERS CONCENTRIC WITHIN .005. REMOVE ALL BURRS AND SHARP EDGES		A4214-1-CN
	Thursday, February 14, 2019 8:13:57 AM		REV