

MPF PRODUCTS INC.

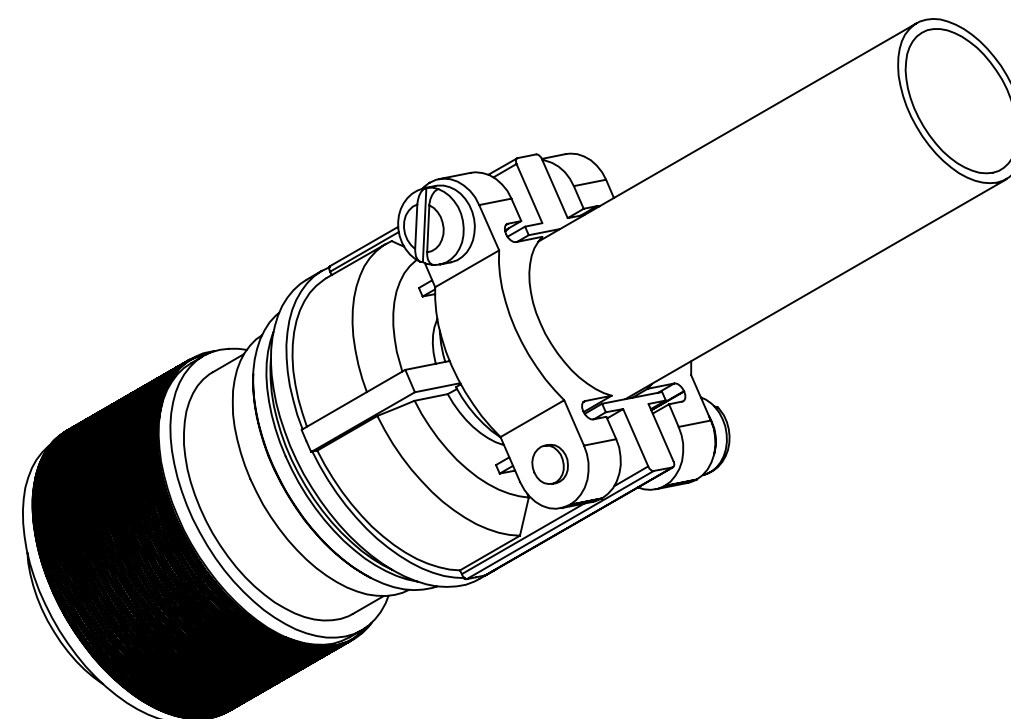

SPECIFICATIONS:
 1. TEMPERATURE RATING: UP TO 125 °C

MS Series Air-side Connector, 7 Pins, 12000 Volts, 7.5 Amps per Pin, Accepts 0.040" Dia Pins

UNLESS OTHERWISE SPECIFIED:		QUOTATION #		N/A	
DIMENSIONS ARE IN INCHES TOLERANCES:		NAME	DATE	MPF PRODUCTS INC. TITLE: MS CIRCULAR CONNECTOR, 12KV, 7.5A, 7 PINS	
ANGULAR: MACH ± 1/2°		DRAWN	9/11/2015		
TWO PLACE DECIMAL ± .030		CHECKED	9/11/2015		
THREE PLACE DECIMAL ± .015		ENG APPR.	9/11/2015		
MATERIAL		THIRD ANGLE:		DOWNLOADED FROM MPFPI.COM	
		APPLICATION			
		NEXT ASSY	USED ON	DWG. NO.	
FINISH		SURFACE FINISH: 63/ OR BETTER		A4220-1-CN	
PLATING		UNLESS OTHERWISE SPECIFIED: ALL DIAMETERS CONCENTRIC WITHIN .005. REMOVE ALL BURRS AND SHARP EDGES		REV	
				Thursday, February 14, 2019 8:19:42 AM	