

MPF PRODUCTS INC.

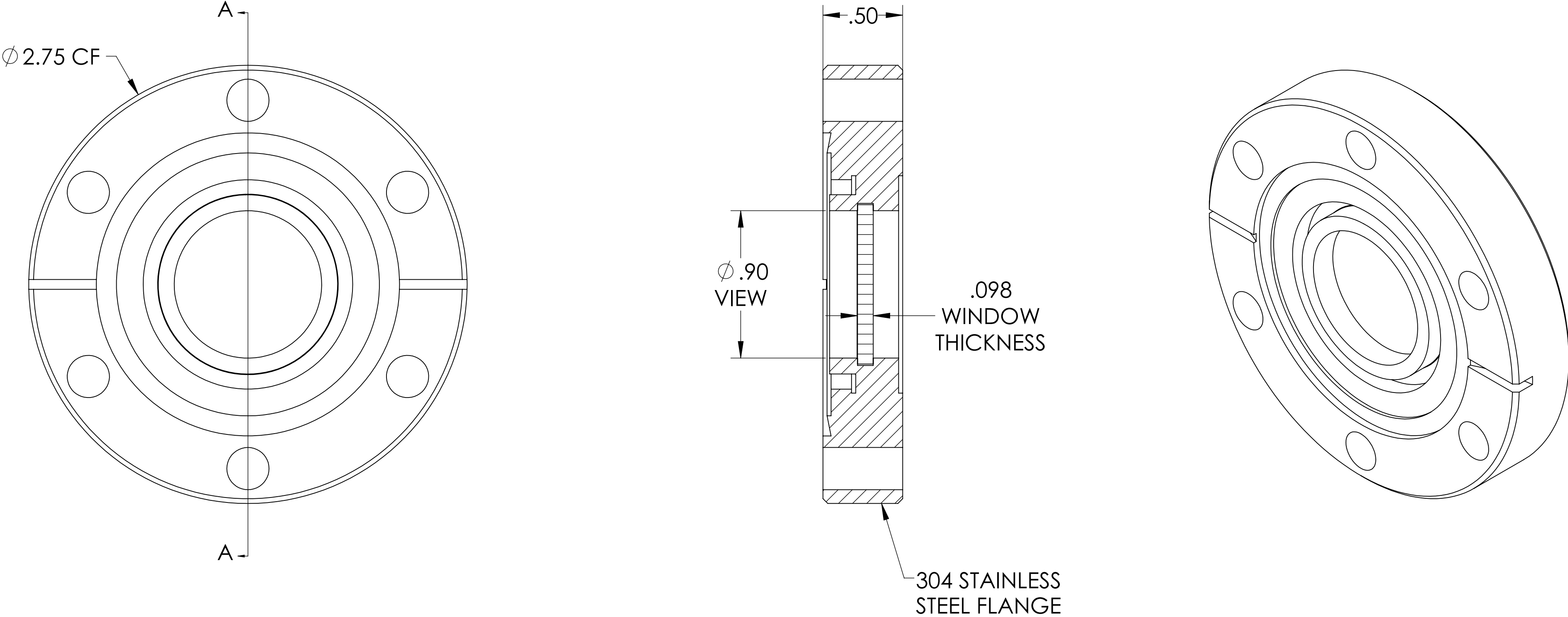

- SPECIFICATIONS:
- 1. MATERIAL: SINGLE CRYSTAL, CALCIUM FLUORIDE
  - 2. FLATNESS < λ/4 @ 632NM (PEAK TO VALLEY)
  - 3. PARALLELISM < 3 ARC MINUTES
  - 4. SURFACE FINISH: 20/10 SCRATCH-DIG
  - 5. THERMAL RANGE: -100°C TO 200°C
  - 6. LEAK RATE < 1 X 10-9 ATM/CC SEC HE

Calcium Fluoride (CaF2) Viewport, UHV Rated Vacuum-Optics, 0.90" View Dia, 2.75" Conflat Flange

|   |  |                             |    |   |           |
|---|--|-----------------------------|----|---|-----------|
| UNLESS OTHERWISE SPECIFIED:   |  | QUOTATION #                 |    | N/A   |           |
| DIMENSIONS ARE IN INCHES<br>TOLERANCES:<br><br>ANGULAR: MACH ± 1/2°<br>TWO PLACE DECIMAL ± .030<br>THREE PLACE DECIMAL ± .015<br><br>MATERIAL |  | DRAWN                       | WJ | DATE  | 9/11/2015 |
|   |  | CHECKED                     |    |   | 9/11/2015 |
|   |  | ENG APPR.                   | WJ |   | 9/11/2015 |
|   |  | THIRD ANGLE:                |    |   |           |
| FINISH  |  | SURFACE FINISH:             |    | 63/ OR BETTER   |           |
| PLATING   |  | UNLESS OTHERWISE SPECIFIED: |    | ALL DIAMETERS CONCENTRIC WITHIN .005.<br>REMOVE ALL BURRS AND SHARP EDGES |           |
|   |  | APPLICATION                 |    | NEXT ASSY   |           |
|   |  | USED ON                     |    |   |           |
|   |  | TITLE:                      |    | VIEWPORT, CAF2 VAC-<br>OPTICS, 1" VIEW, 275CF                             |           |
|   |  | DWG. NO.                    |    | A4531-1-CF  |           |
|   |  | REV                         |    |   |           |
|   |  | DOWNLOADED FROM MPFPI.COM   |    | Thursday, January 24, 2019 11:11:08 AM                                    |           |