

MPF PRODUCTS INC.

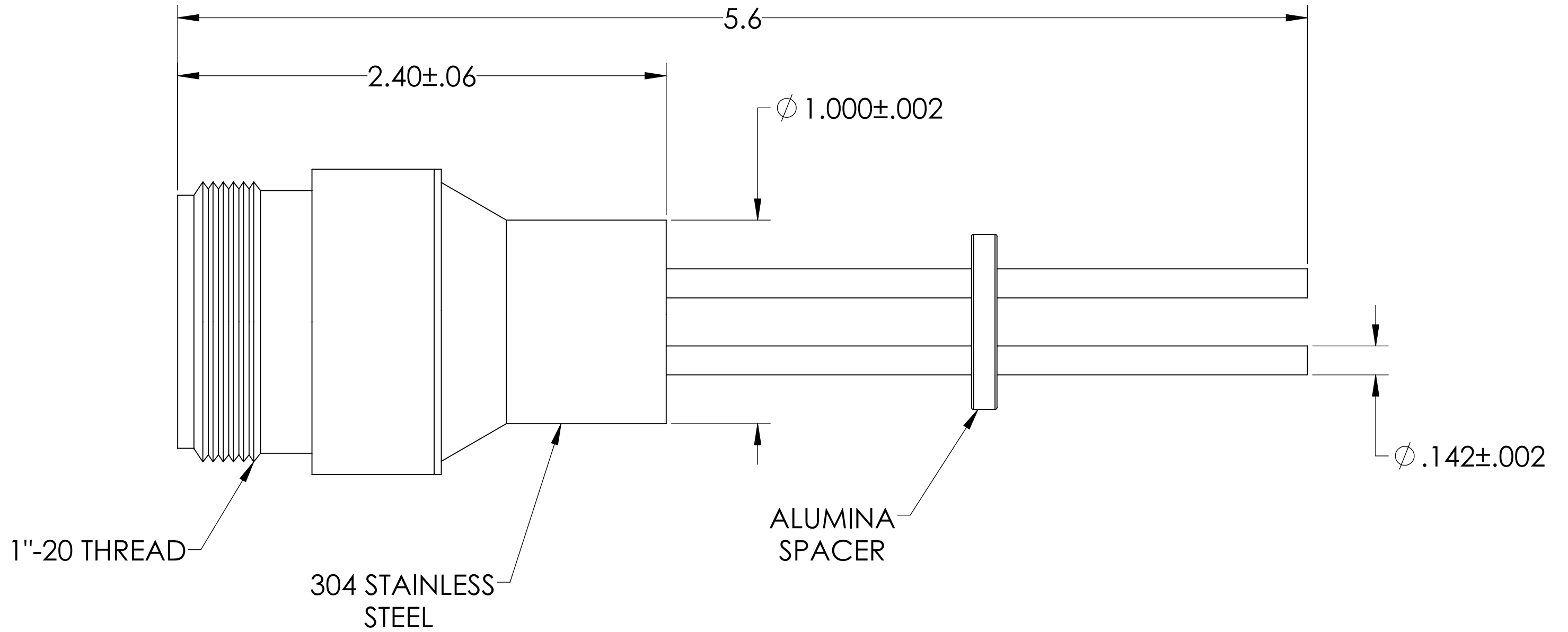

PART #	CONDUCTOR MATERIAL	CURRENT RATING PER PIN
A4748-1-W	MOLYBDENUM	40 AMPS
A4748-3-W	NICKEL 200	25 AMPS

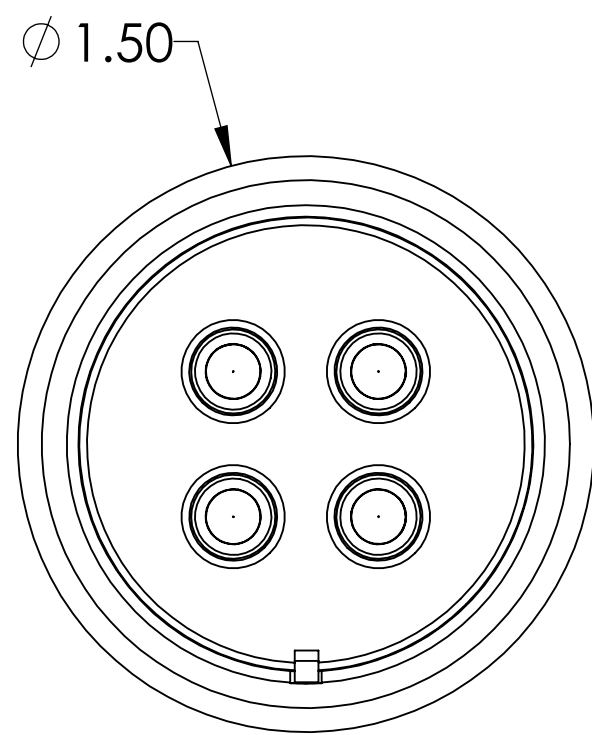
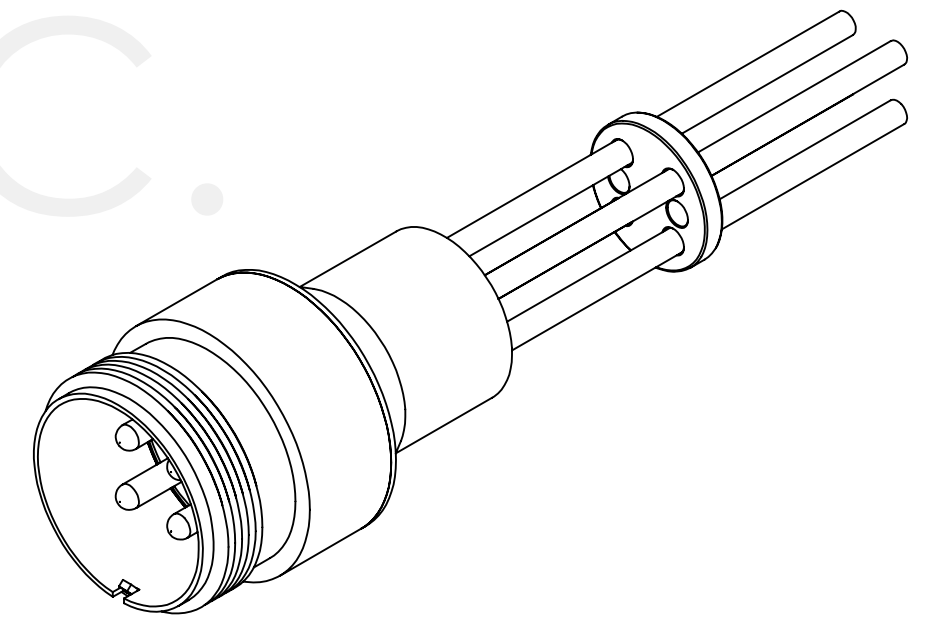
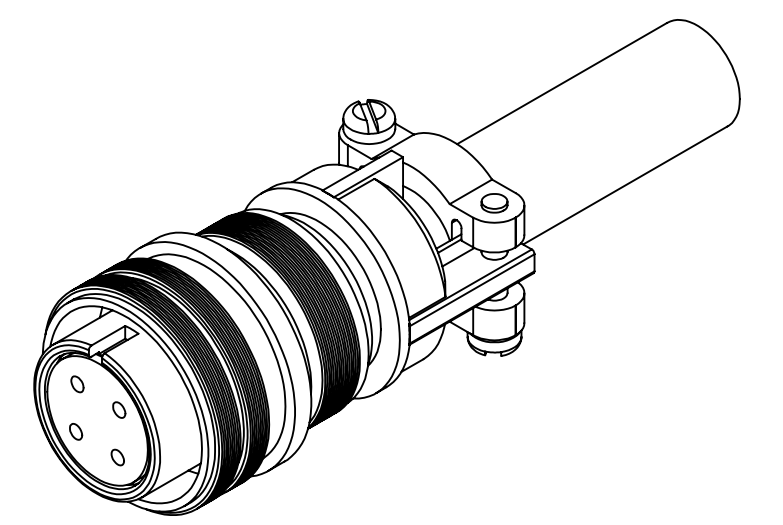

SPECIFICATIONS:

- VOLTAGE: 700 VOLTS DC
- CURRENT: SEE TABLE
- TEMPERATURE RATING: -100 TO 450°C WITHOUT CONNECTOR
- LEAK RATE < 1X10-9 ATM CC/SEC HE

MS Series, Multipin Feedthrough w/ Air-side Connector, 4 Pins, 700 Volts, 0.142" Conductors, 1.00" Weld Adapter

UNLESS OTHERWISE SPECIFIED:	QUOTATION #	N/A
DIMENSIONS ARE IN INCHES TOLERANCES:	NAME	DATE
ANGULAR: MACH ± 1/2°	DRAWN	9/11/2015
TWO PLACE DECIMAL ± .030	CHECKED	9/11/2015
THREE PLACE DECIMAL ± .015	ENG APPR.	WJ 9/11/2015
MATERIAL	THIRD ANGLE:	TITLE:
		MULTIPIN, 4 PINS, 700V, 1.000" WELD ADAPTER
FINISH	APPLICATION	DOWNLOADED FROM MPFPI.COM
PLATING	SURFACE FINISH: 63/ OR BETTER	DWG. NO. A4748
	UNLESS OTHERWISE SPECIFIED:	REV
	ALL DIAMETERS CONCENTRIC WITHIN .005. REMOVE ALL BURRS AND SHARP EDGES	Tuesday, January 29, 2019 8:30:57 AM