

MPF PRODUCTS INC.

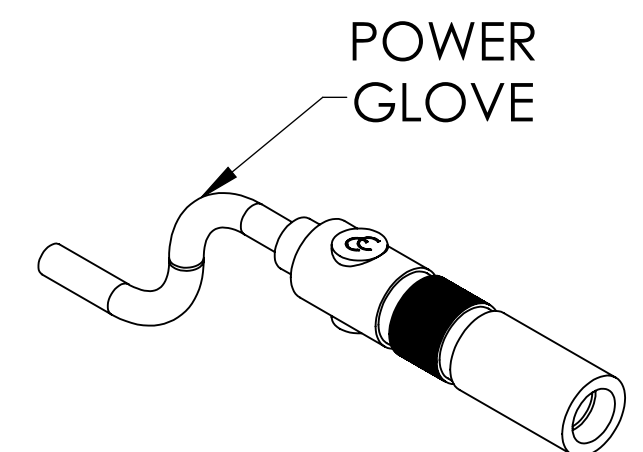
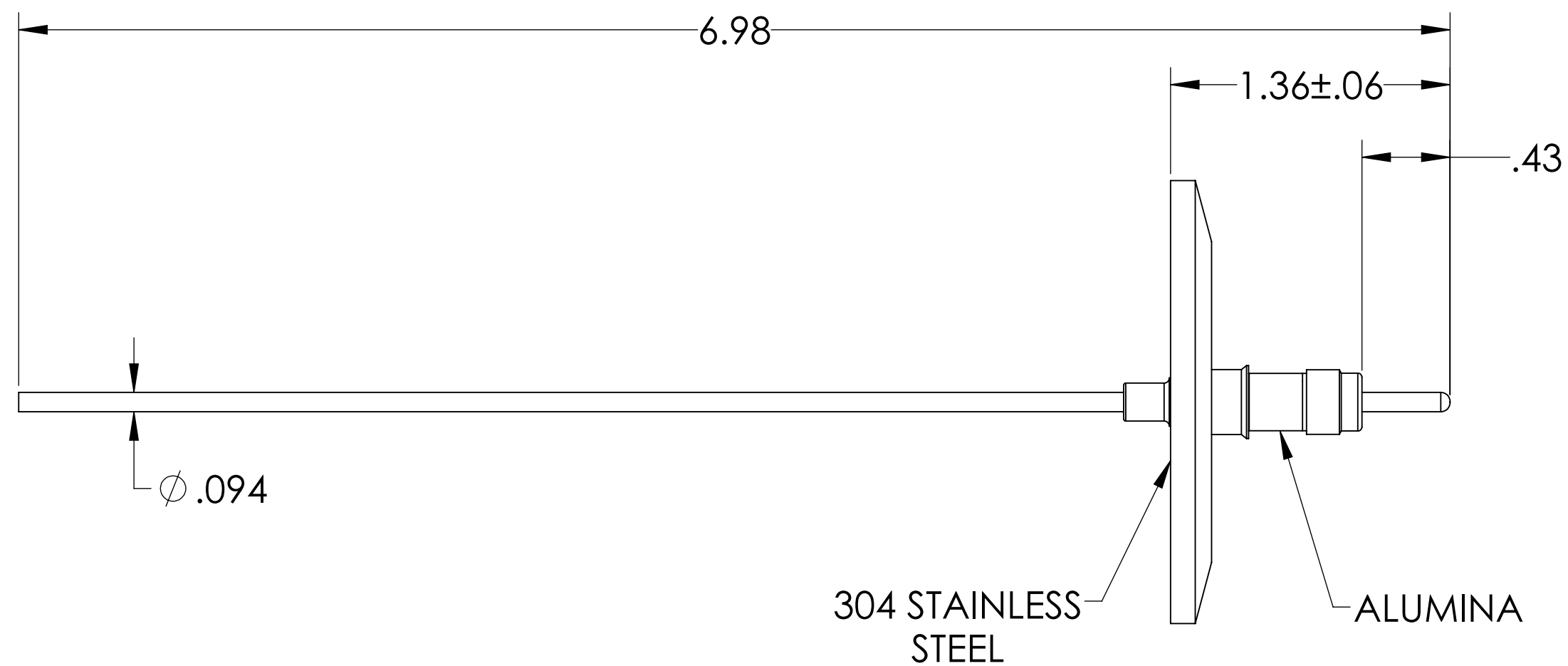
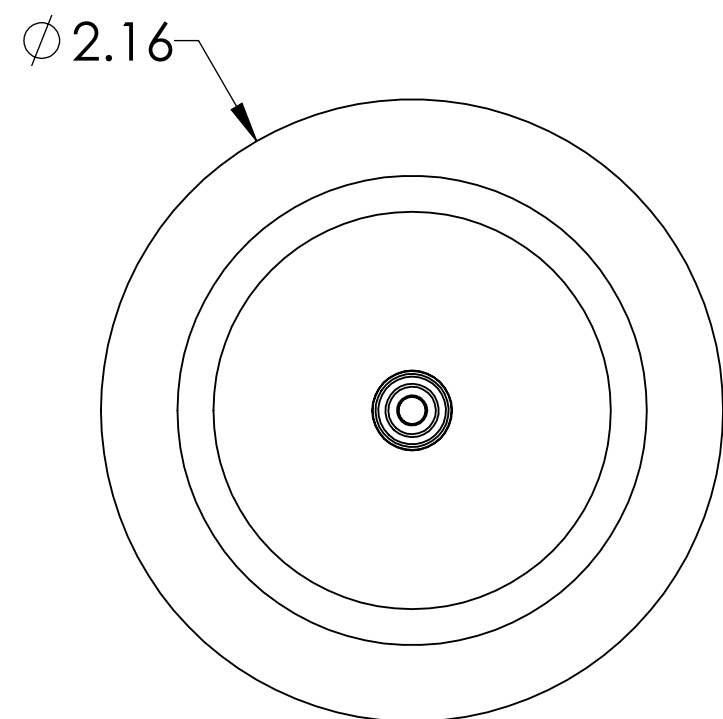
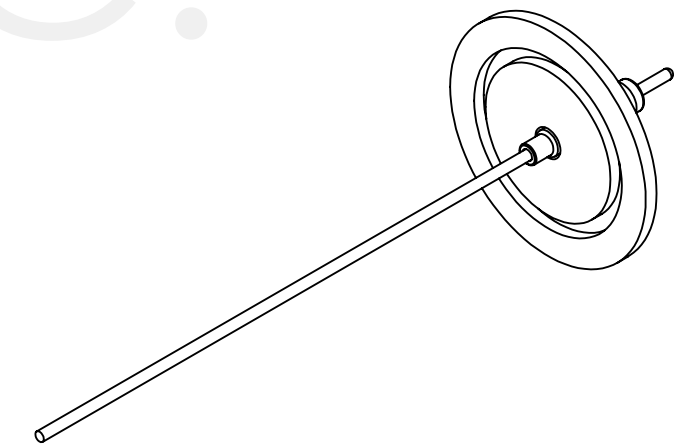

NOTE:

1. VOLTAGE: 5,000 VOLTS DC
2. CURRENT: 30 AMPS
3. TEMPERATURE RATING: -100 TO 450°C

Power Feedthrough W/ Power Glove, 5,000 Volts, 1 Pin, 0.094" Copper Conductors, 2.16" QF/KF, UHV Rated, Bakeable to 450°C

UNLESS OTHERWISE SPECIFIED:	QUOTATION #		N/A	
DIMENSIONS ARE IN INCHES	NAME	DATE	MPF PRODUCTS INC.	
TOLERANCES:	DRAWN	WJ		9/11/2015
ANGULAR: MACH ± 1/2°	CHECKED	WJ		9/11/2015
TWO PLACE DECIMAL ± .030	ENG APPR.	WJ		9/11/2015
THREE PLACE DECIMAL ± .015	THIRD ANGLE:		TITLE: POWER GLOVE, 5000 VOLTS, 1 PIN, 2.16" QF/KF	
MATERIAL				
FINISH	APPLICATION	NEXT ASSY	USED ON	
PLATING	SURFACE FINISH:	63 OR BETTER UNLESS OTHERWISE SPECIFIED: ALL DIAMETERS CONCENTRIC WITHIN .005. REMOVE ALL BURRS AND SHARP EDGES		
DOWNLOADED FROM MPFPI.COM DWG. NO. A5970-1-QF		REV		
Tuesday, January 22, 2019 11:54:48 AM				