

MPF PRODUCTS INC.

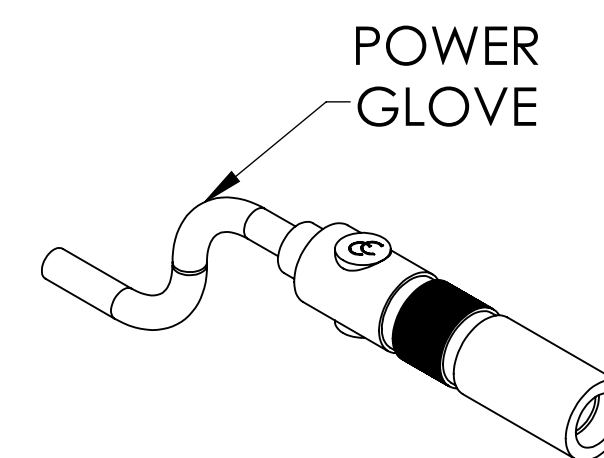
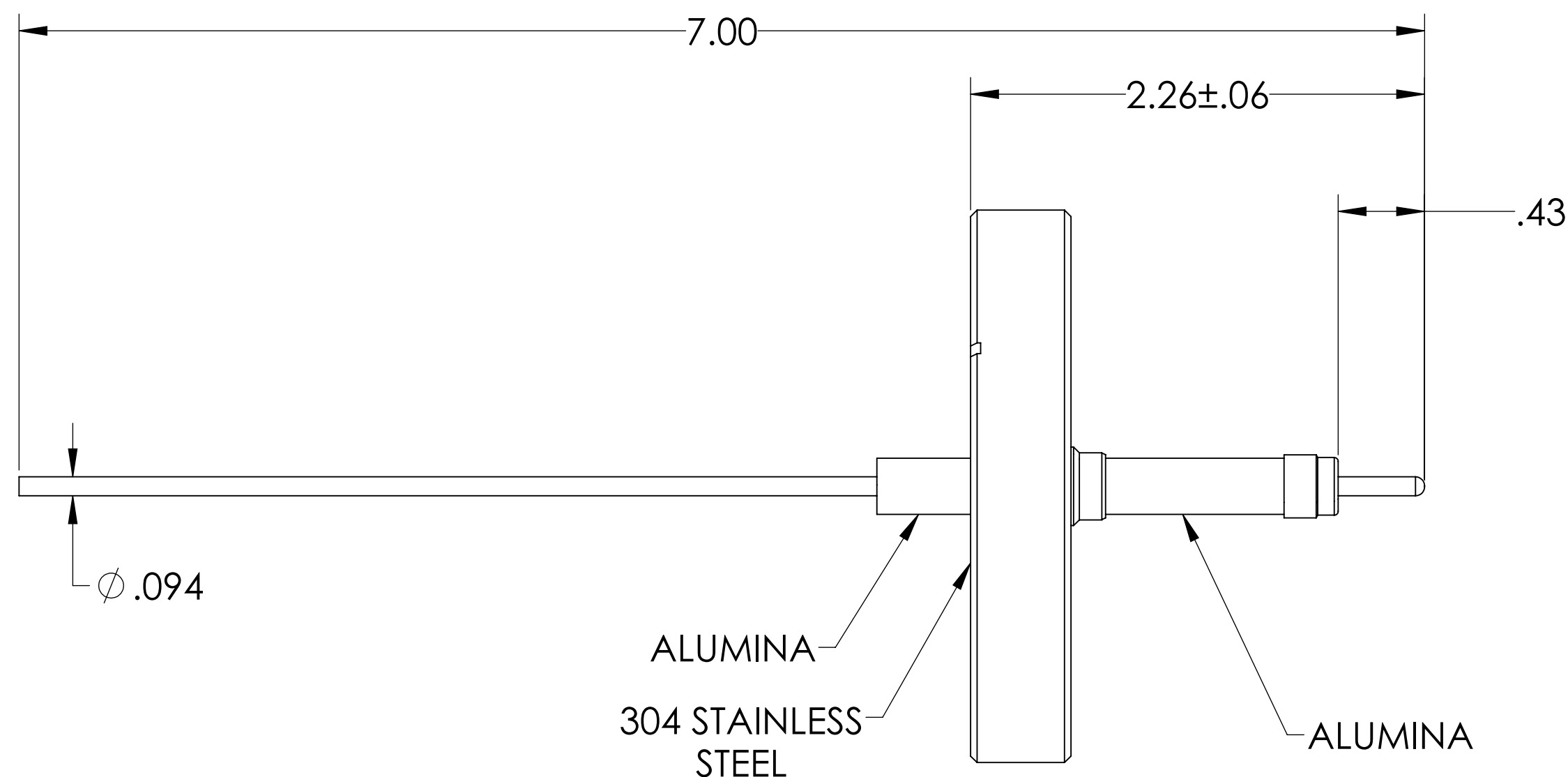
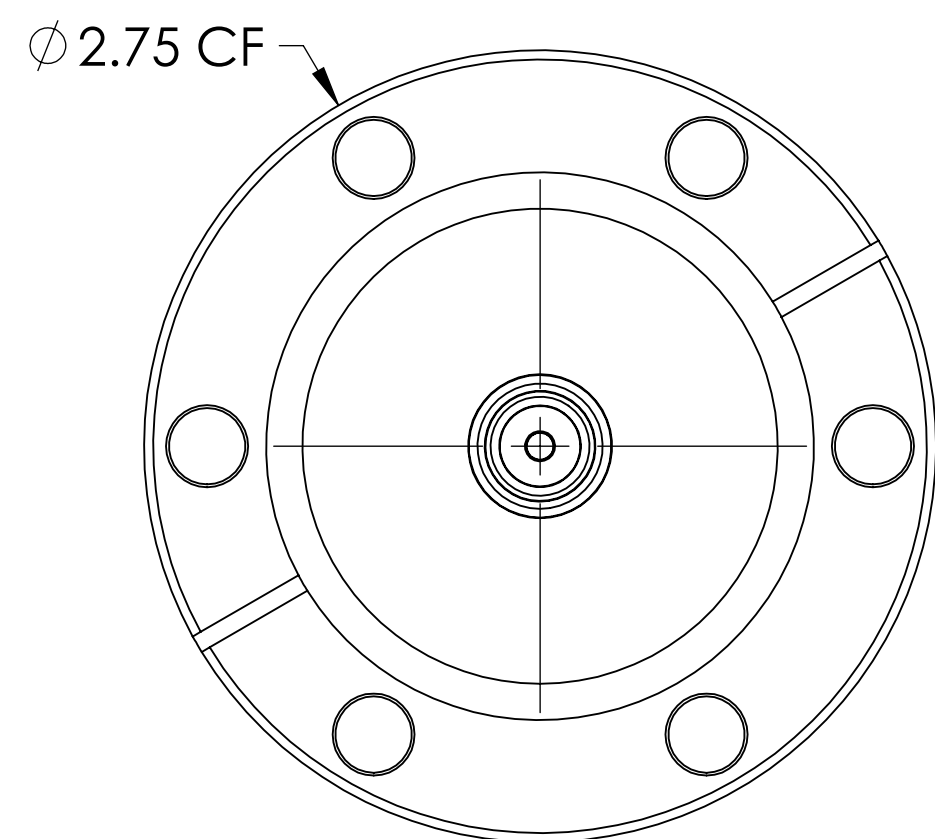
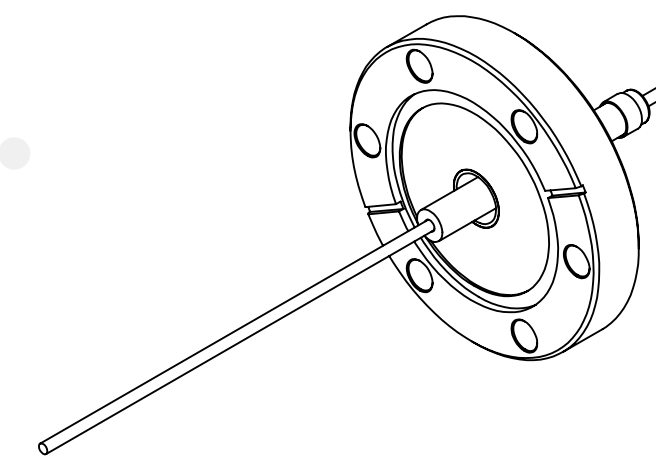

NOTE:

1. VOLTAGE: 20,000 VOLTS DC
2. CURRENT: 30 AMPS
3. TEMPERATURE RATING: -100 TO 450°C

Power Feedthrough W/ Power Glove, 20 KV, 1 Pin, 0.094" Copper Conductors, 2.75" Conflat Flange, UHV Rated, Bakeable to 450°C

UNLESS OTHERWISE SPECIFIED:	QUOTATION #		N/A
DIMENSIONS ARE IN INCHES TOLERANCES:	NAME	DATE	MPF PRODUCTS INC.
ANGULAR: MACH ± 1/2°	DRAWN	9/11/2015	
TWO PLACE DECIMAL ± .030	CHECKED	9/11/2015	
THREE PLACE DECIMAL ± .015	ENG APPR.	WJ 9/11/2015	
MATERIAL	THIRD ANGLE:		TITLE: POWER GLOVE, 20 KV, 1 PIN, 2.75" CONFLAT FLANGE
FINISH	APPLICATION		DWG. NO. A5980-1-CF
PLATING	NEXT ASSY	USED ON	
	SURFACE FINISH: 63/ OR BETTER		REV
	UNLESS OTHERWISE SPECIFIED:		Downloaded from MPFPI.COM
	ALL DIAMETERS CONCENTRIC WITHIN .005. REMOVE ALL BURRS AND SHARP EDGES		Tuesday, January 22, 2019 12:43:46 PM