

MPF PRODUCTS INC.

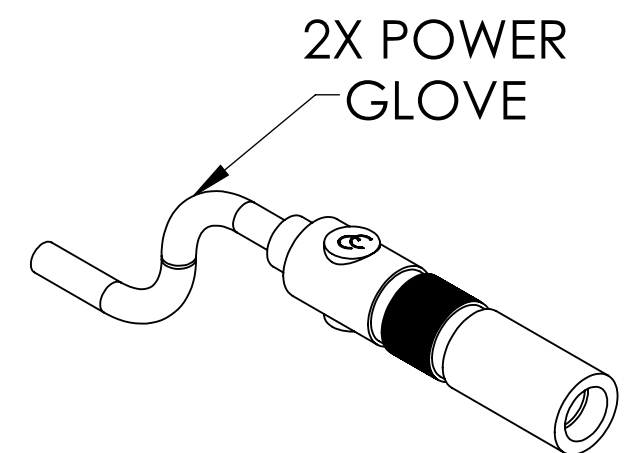
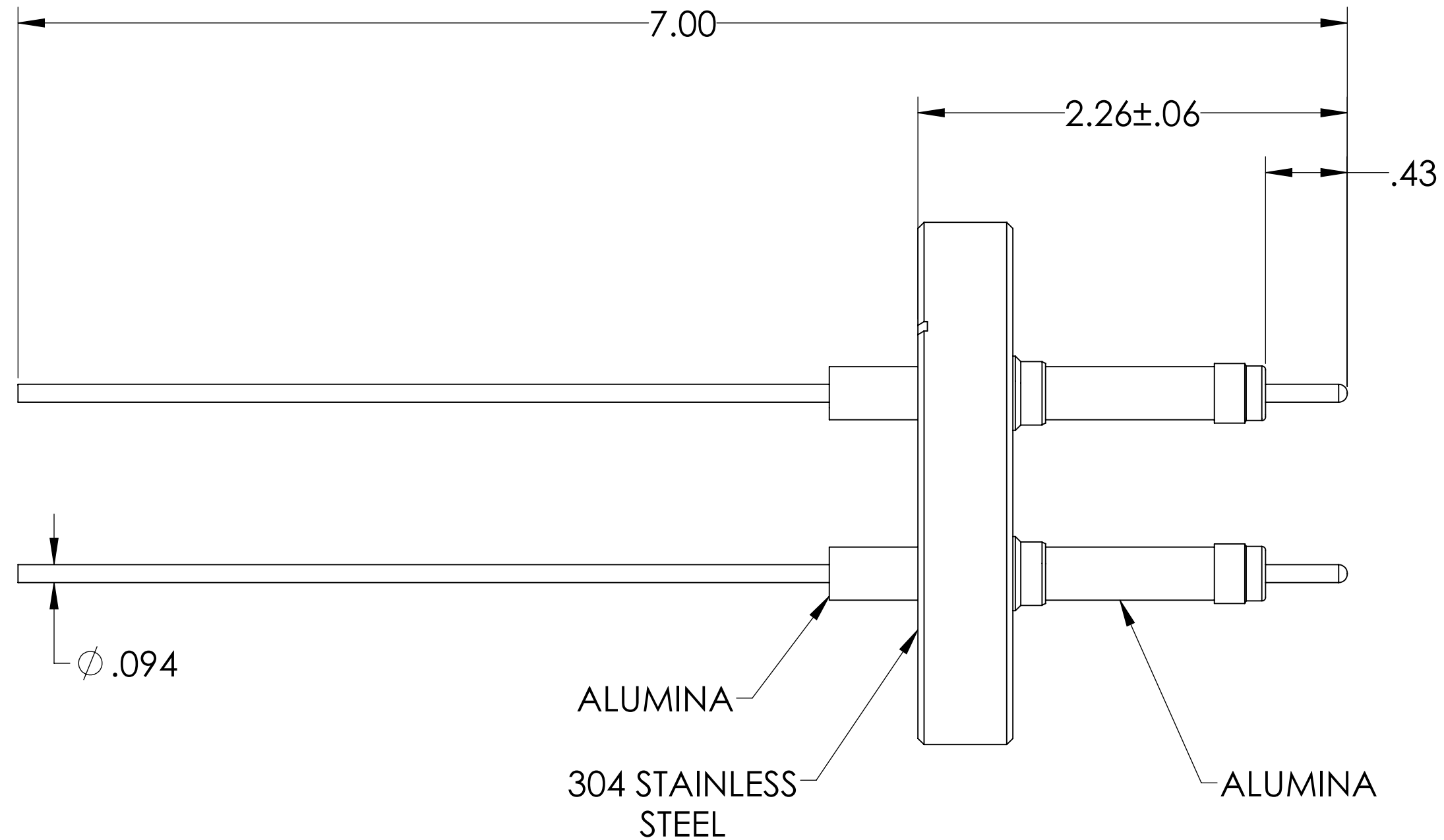
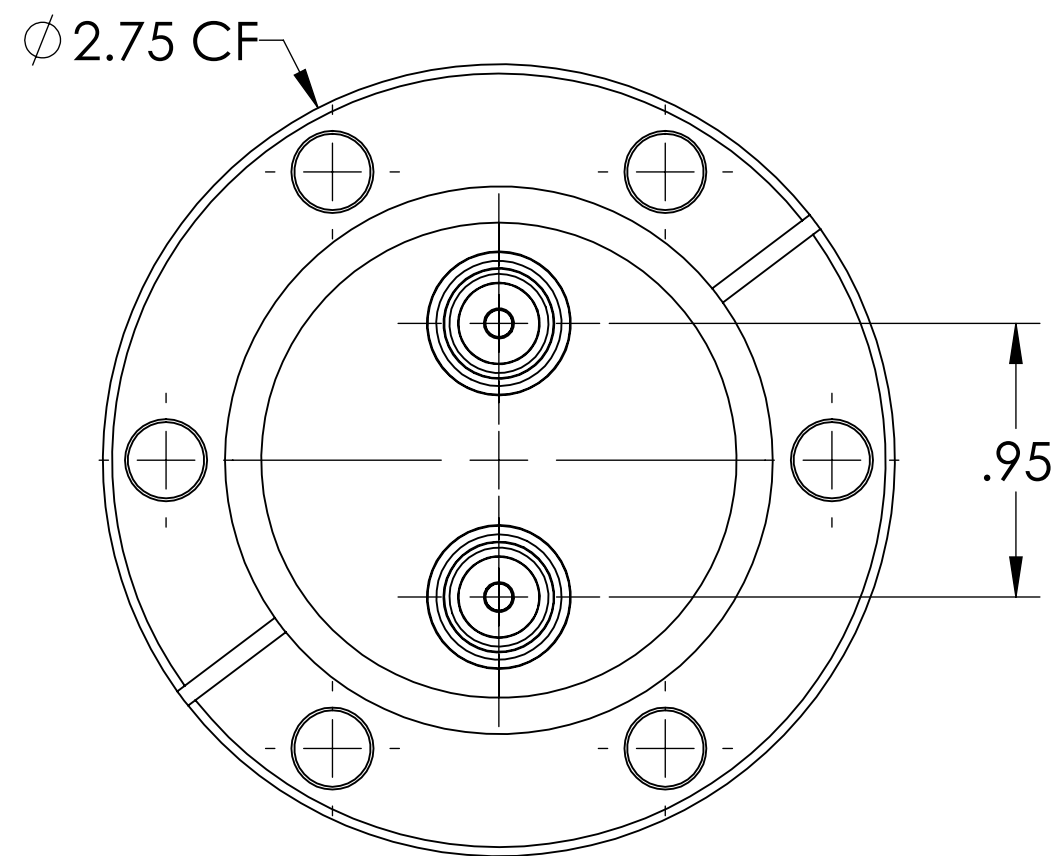
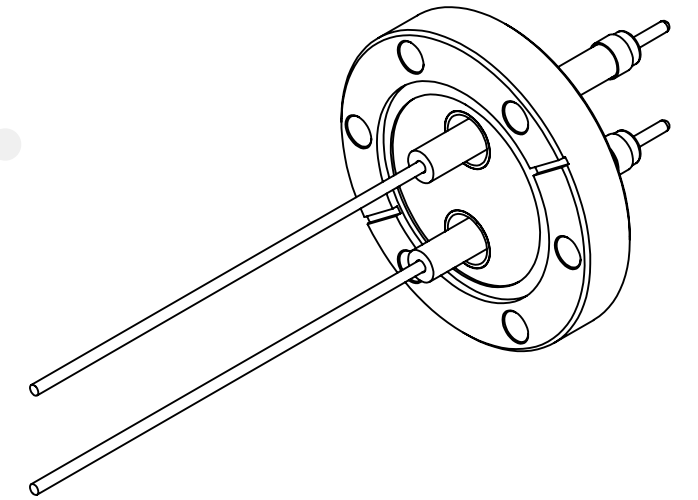

- NOTE:
1. VOLTAGE: 20,000 VOLTS DC
  2. CURRENT: 30 AMPS
  3. TEMPERATURE RATING: -100 TO 450°C

Power Feedthrough W/ Power Gloves, 20 KV, 2 Pins, 0.094" Copper Conductors, 2.75" Conflat Flange, UHV Rated, Bakeable to 450°C

UNLESS OTHERWISE SPECIFIED:	QUOTATION #		N/A
DIMENSIONS ARE IN INCHES TOLERANCES:			MPF PRODUCTS INC.
ANGULAR: MACH ± 1/2°	DRAWN	NAME	
TWO PLACE DECIMAL ± .030	CHECKED	DATE	
THREE PLACE DECIMAL ± .015	ENG APPR.	WJ	
MATERIAL	THIRD ANGLE:		TITLE:  POWER GLOVES, 20 KV, 2 PINS, 2.75" CONFLAT FLANGE
	APPLICATION		
	NEXT ASSY USED ON		
FINISH	SURFACE FINISH: 63 OR BETTER		DOWNLOADED FROM MPFPI.COM
PLATING	UNLESS OTHERWISE SPECIFIED:		DWG. NO.
	ALL DIAMETERS CONCENTRIC WITHIN .005. REMOVE ALL BURRS AND SHARP EDGES		A5981-1-CF
			Tuesday, January 22, 2019 12:45:26 PM