

MPF PRODUCTS INC.

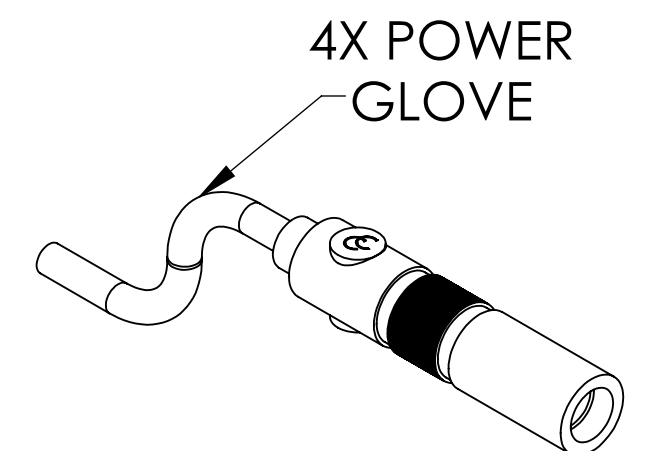
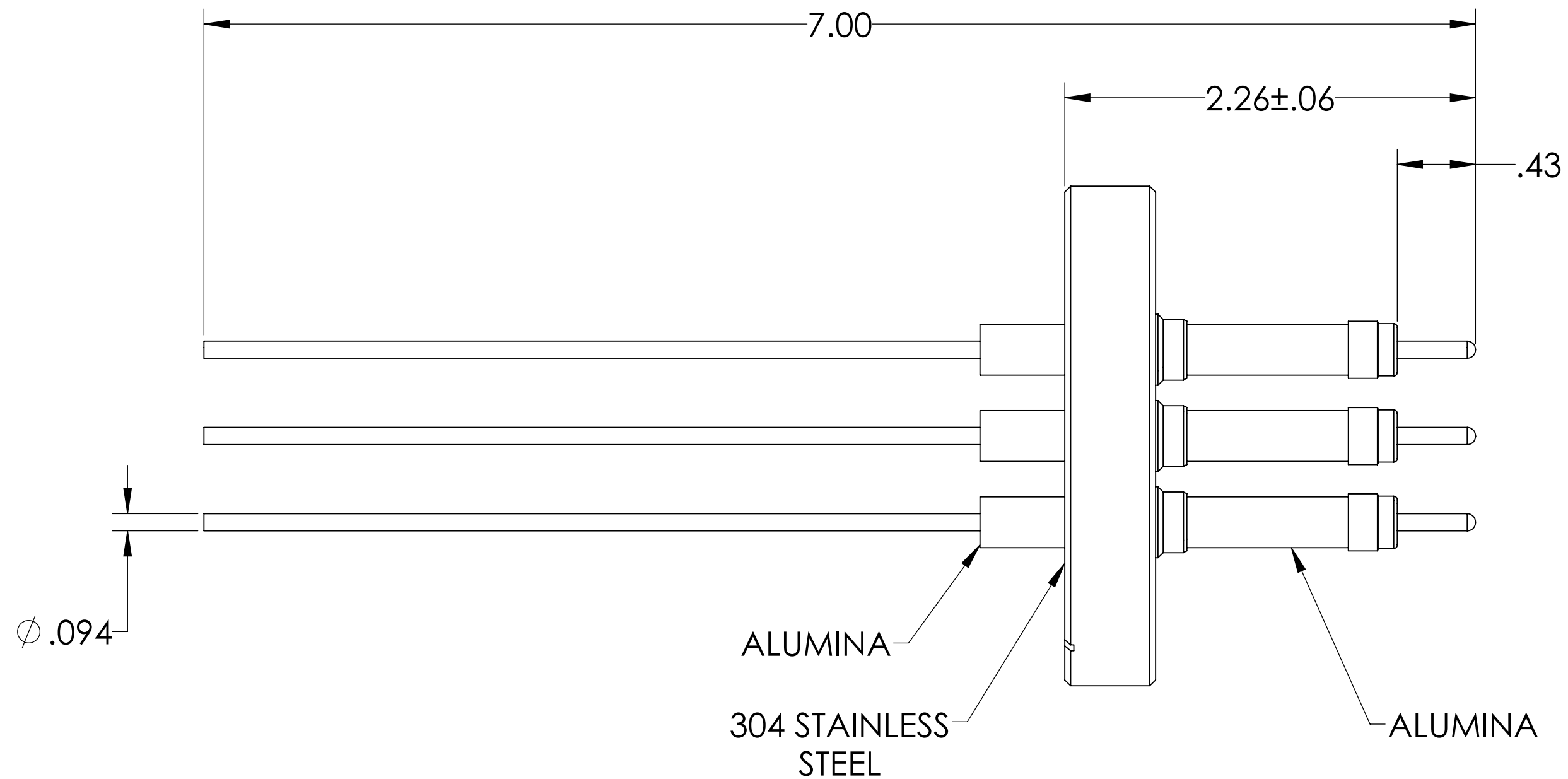
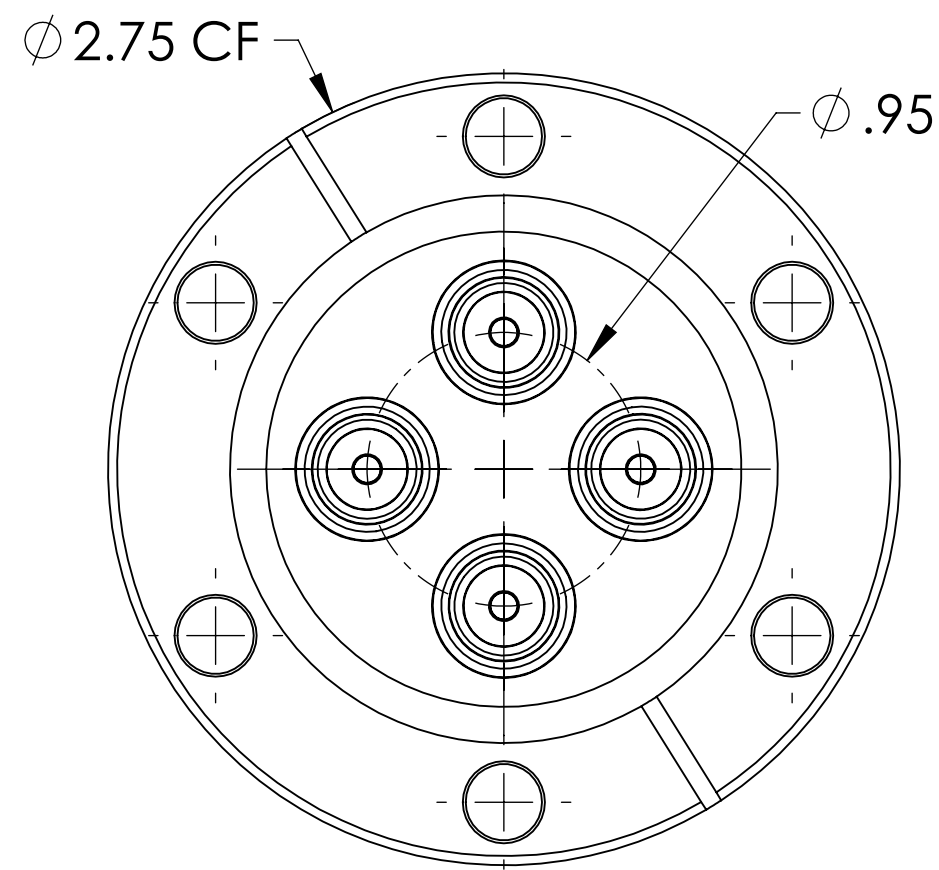
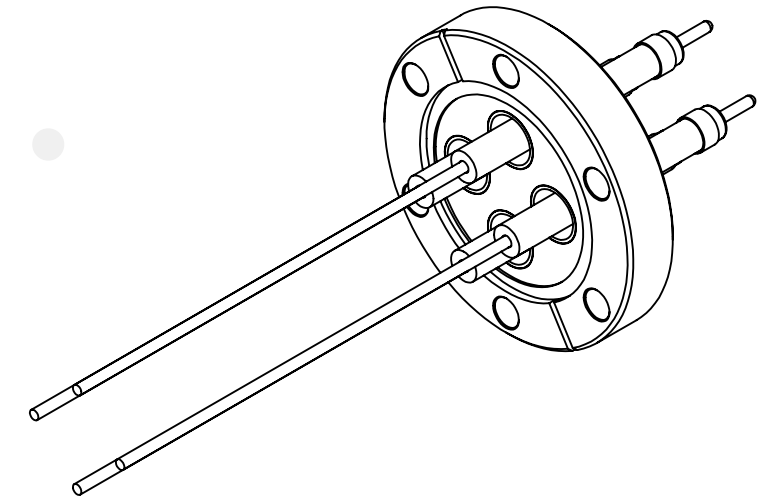

- NOTE:**
1. VOLTAGE: 20,000 VOLTS DC
 2. CURRENT: 30 AMPS
 3. TEMPERATURE RATING: -100 TO 450°C

Power Feedthrough W/ Power Gloves, 20 KV, 4 Pins, 0.094" Copper Conductors, 2.75" Conflat Flange, UHV Rated, Bakeable to 450°C

UNLESS OTHERWISE SPECIFIED:	QUOTATION #		N/A
DIMENSIONS ARE IN INCHES TOLERANCES:	NAME	DATE	MPF PRODUCTS INC.
ANGULAR: MACH ± 1/2°	DRAWN	9/11/2015	
TWO PLACE DECIMAL ± .030	CHECKED	9/11/2015	
THREE PLACE DECIMAL ± .015	ENG APPR.	WJ 9/11/2015	
MATERIAL	THIRD ANGLE:		TITLE: POWER GLOVES, 20 KV, 4 PINS, 2.75" CONFLAT FLANGE
FINISH	APPLICATION	NEXT ASSY	USED ON
PLATING	SURFACE FINISH:	63/ OR BETTER UNLESS OTHERWISE SPECIFIED: ALL DIAMETERS CONCENTRIC WITHIN .005. REMOVE ALL BURRS AND SHARP EDGES	
DOWNLOADED FROM MPFPI.COM			REV
DWG. NO. A5982-1-CF			Tuesday, January 22, 2019 12:46:36 PM