

# MPF PRODUCTS INC.

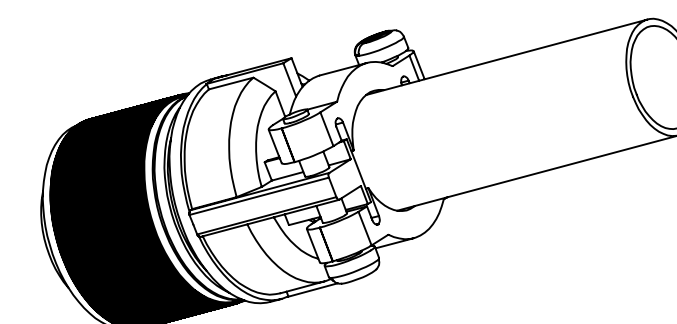
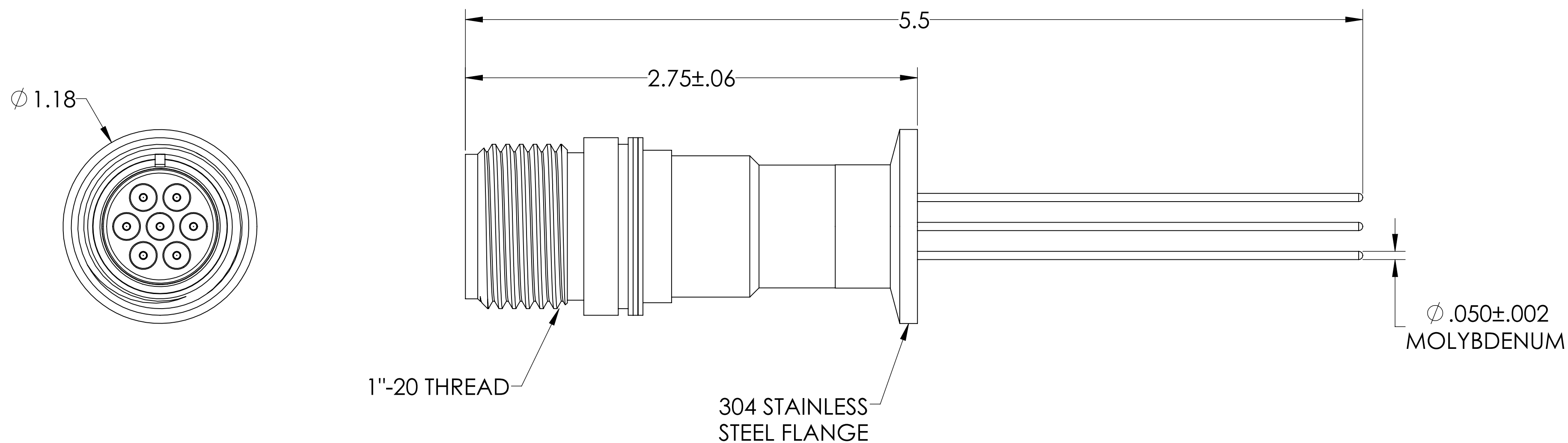
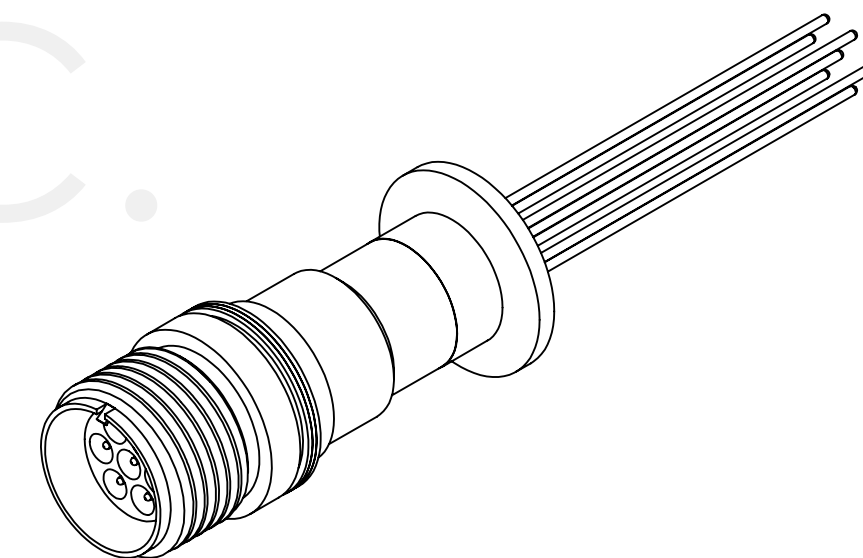

**SPECIFICATIONS:**

1. VOLTAGE: 12,000 VOLTS DC
2. CURRENT: 7.5 AMPS PER PIN
3. TEMPERATURE RATING: -100 TO 450°C WITHOUT CONNECTOR
4. LEAK RATE <math> < 1 \times 10^{-9}</math> ATM CC/SEC HE

MS Series, Multipin Feedthrough w/ Air-side Connector, 7 Pins, 12KV, 7.5 Amps per Pin, 0.05" Moly Conductors, 1.18" QF/KF

UNLESS OTHERWISE SPECIFIED:	QUOTATION #		N/A
DIMENSIONS ARE IN INCHES TOLERANCES:	NAME	DATE	MPF PRODUCTS INC.
ANGULAR: MACH $\pm 1/2^\circ$	DRAWN	9/11/2015	
TWO PLACE DECIMAL $\pm .030$	CHECKED	9/11/2015	
THREE PLACE DECIMAL $\pm .015$	ENG APPR.	WJ 9/11/2015	
MATERIAL	THIRD ANGLE:		TITLE:  MULTIPIN, 7 PINS, 12KV, 7.5 A, .118" QF/KF
FINISH	APPLICATION		DWG. NO. A6081-1-QF
PLATING	NEXT ASSY USED ON		
	SURFACE FINISH: $\sqrt{63}$ OR BETTER		REV
	UNLESS OTHERWISE SPECIFIED:		DOWNLOADED FROM MPFPI.COM
	ALL DIAMETERS CONCENTRIC WITHIN .005. REMOVE ALL BURRS AND SHARP EDGES		Thursday, February 7, 2019 8:58:42 AM