

# MPF PRODUCTS INC.

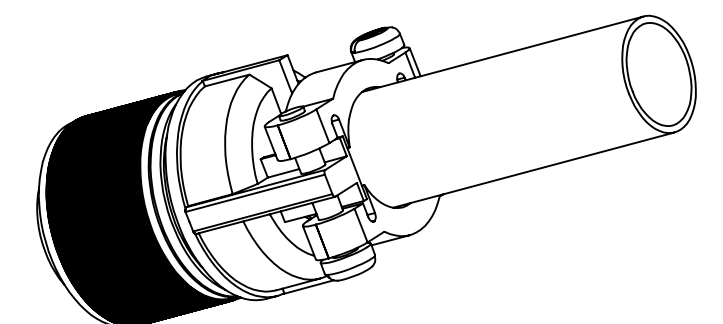
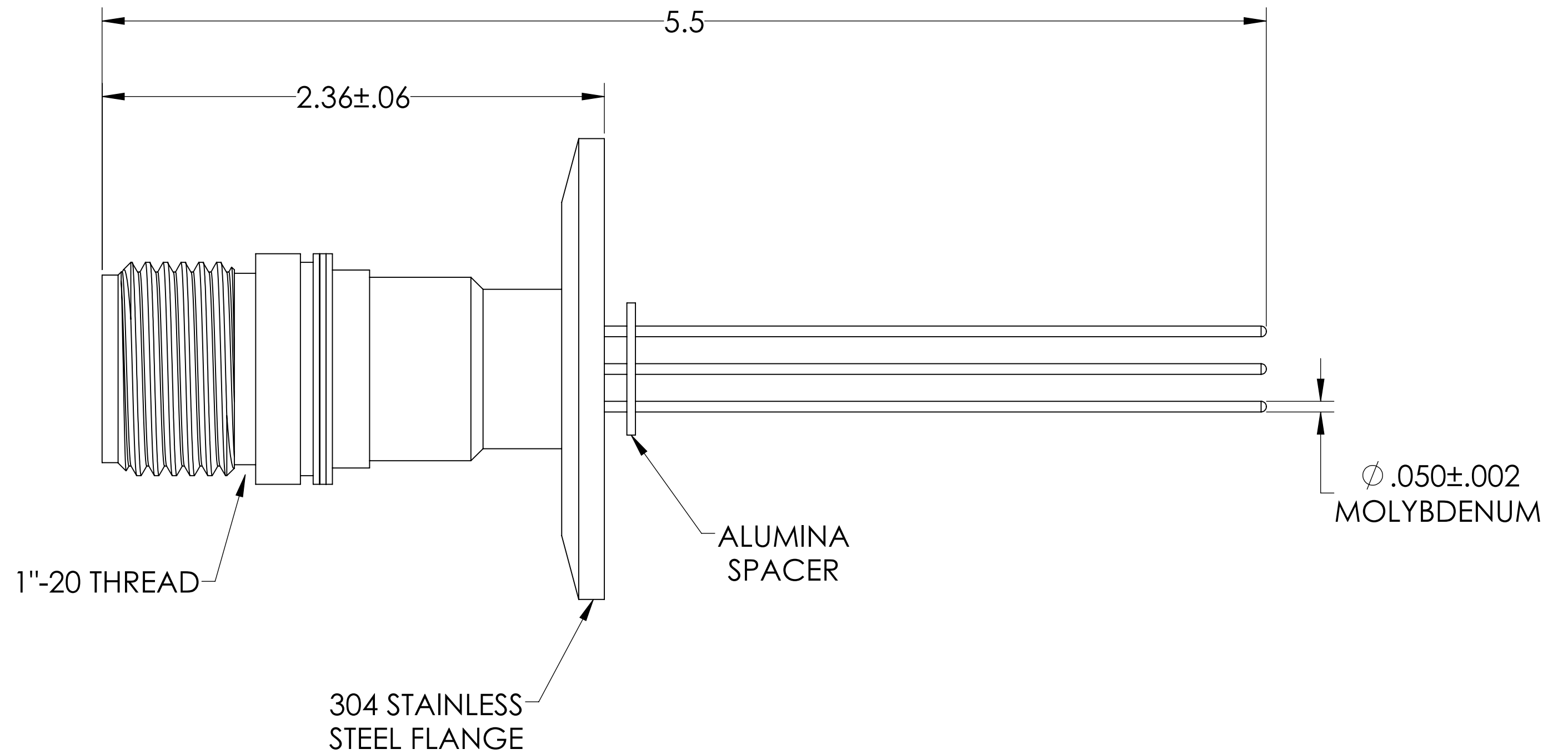
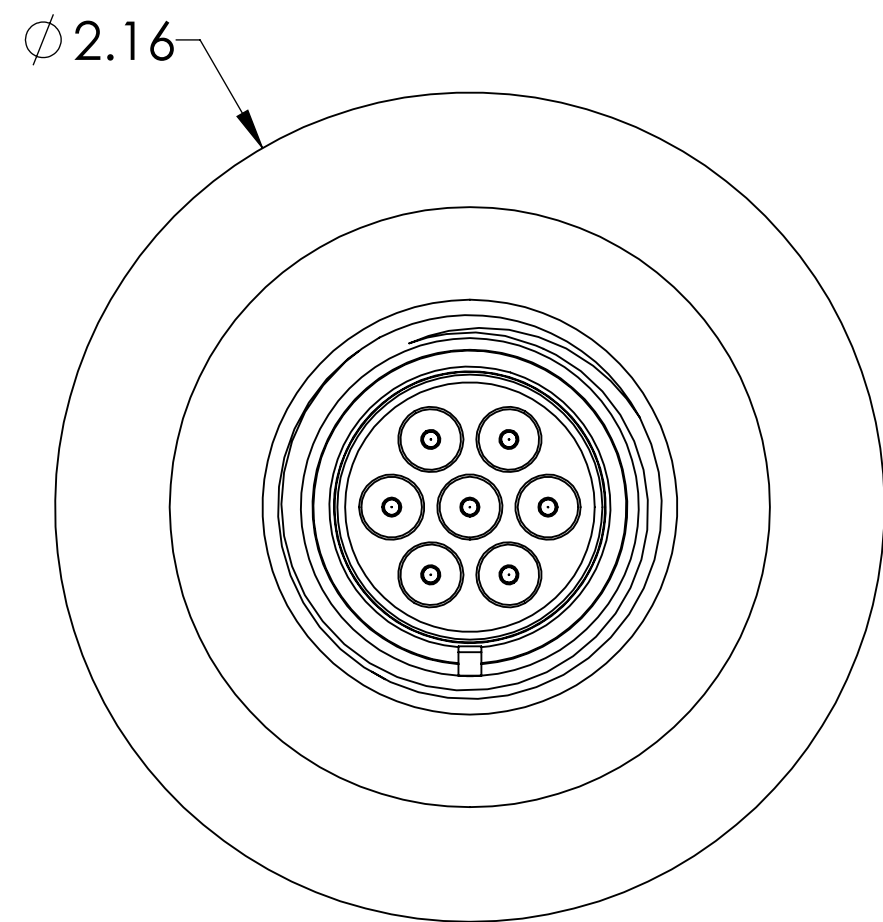
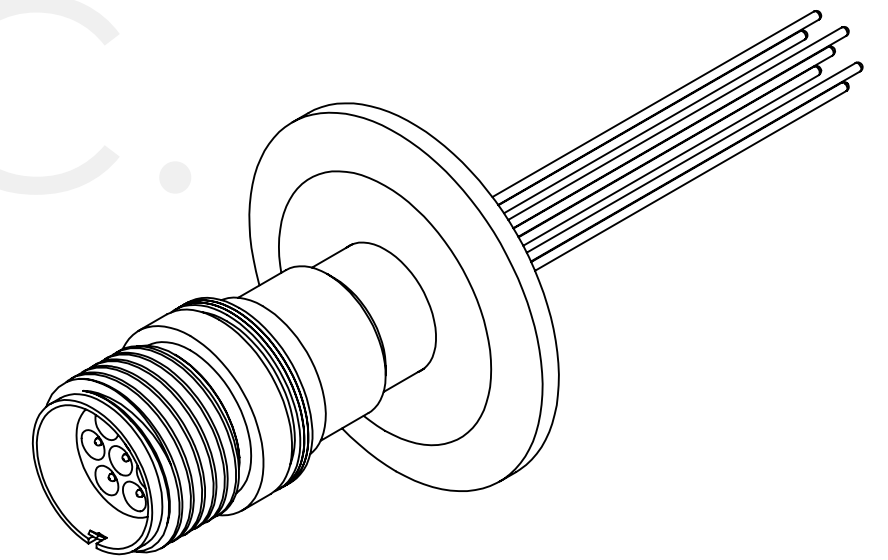

**SPECIFICATIONS:**

1. VOLTAGE: 12,000 VOLTS DC
2. CURRENT: 7.5 AMPS PER PIN
3. TEMPERATURE RATING: -100 TO 450°C WITHOUT CONNECTOR
4. LEAK RATE < 1X10-9 ATM CC/SEC HE

MS Series, Multipin Feedthrough w/ Air-side Connector, 7 Pins, 12KV, 7.5 Amps per Pin, 0.05" Moly Conductors, 2.16" QF/KF

UNLESS OTHERWISE SPECIFIED:		QUOTATION #		N/A	
DIMENSIONS ARE IN INCHES TOLERANCES:		NAME	DATE	MPF PRODUCTS INC.	
ANGULAR: MACH ± 1/2°		DRAWN	9/11/2015		
TWO PLACE DECIMAL ± .030		CHECKED	9/11/2015		
THREE PLACE DECIMAL ± .015		ENG APPR.	WJ 9/11/2015		
MATERIAL		THIRD ANGLE:		TITLE:  MULTIPIN, 7 PINS, 12KV, 7.5 A, .216" QF/KF  DOWNLOADED FROM MPFPI.COM	
FINISH					
PLATING		APPLICATION NEXT ASSY      USED ON			
		SURFACE FINISH: 63/ OR BETTER			
		UNLESS OTHERWISE SPECIFIED:		DWG. NO.      REV	
		ALL DIAMETERS CONCENTRIC WITHIN .005. REMOVE ALL BURRS AND SHARP EDGES		A6082-1-QF	
		Thursday, February 7, 2019 8:58:29 AM			