

MPF PRODUCTS INC.

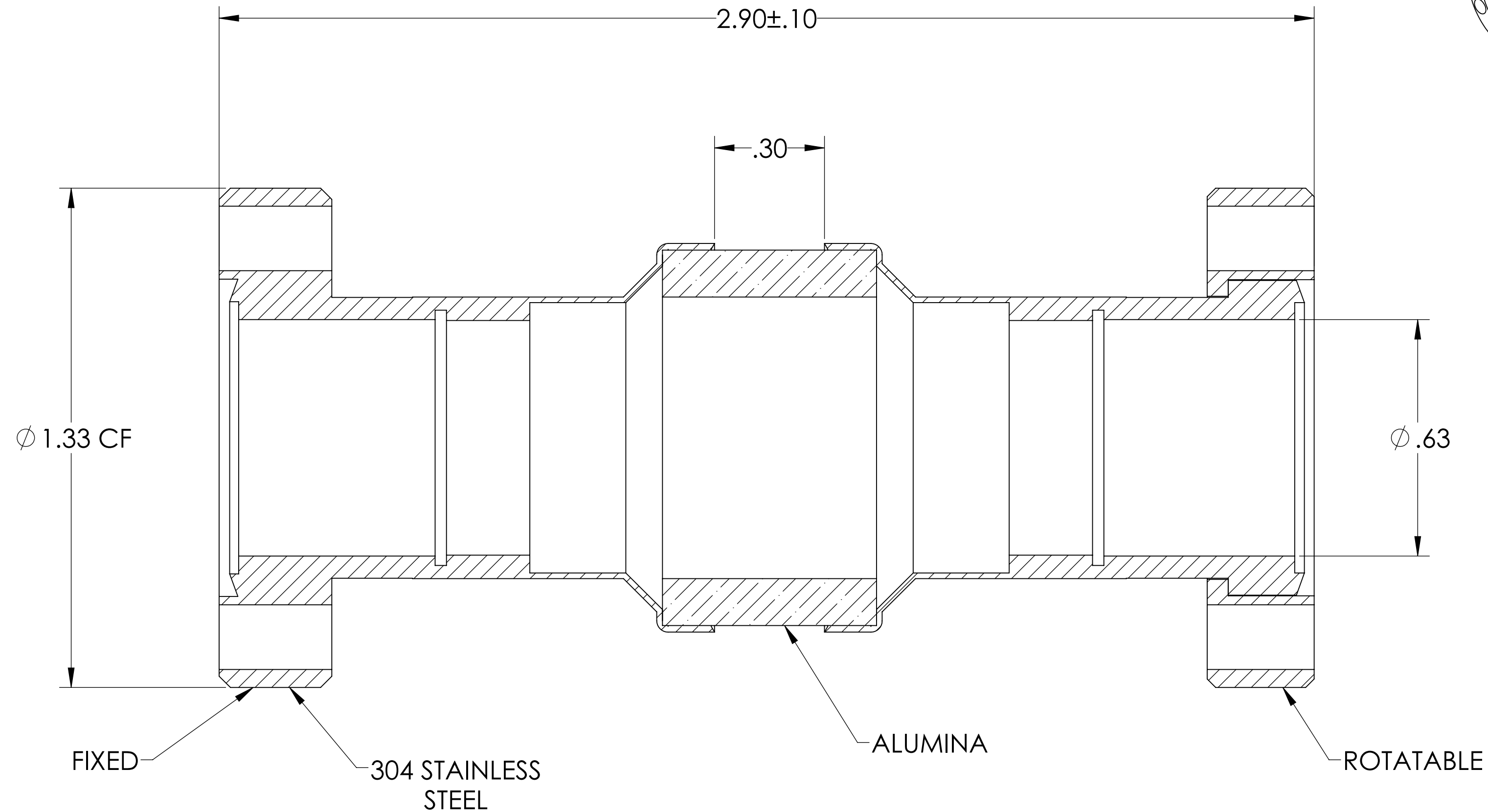
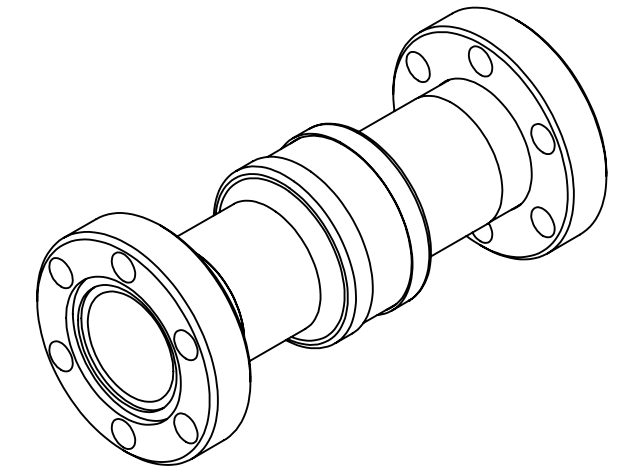

SPECIFICATIONS:

1. VOLTAGE: 5KV
2. TEMPERATURE: -200°C TO 450°C
3. LEAK RATE < 1X10⁻⁹ ATM CC/SEC HE

Break, 5KV Isolation, 0.63" Inner Dia, 1.33" Conflat Flange, High Voltage Isolation, Thermal Isolation, Rotatable Conflat Flange, UHV Compatible

UNLESS OTHERWISE SPECIFIED:		QUOTATION #		N/A	
DIMENSIONS ARE IN INCHES		NAME	DATE	MPF PRODUCTS INC.	
TOLERANCES:		DRAWN	9/11/2015		
ANGULAR: MACH ± 1/2°		CHECKED	9/11/2015		
TWO PLACE DECIMAL ± .030		ENG APPR.	9/11/2015		
THREE PLACE DECIMAL ± .015		THIRD ANGLE:		TITLE: BREAK, 5KV ISOLATION, 0.63" INNER DIA, 1.33" CONFLAT FLANGE DOWNLOAD FROM MPFPI.COM	
MATERIAL					
FINISH		APPLICATION NEXT ASSY USED ON			
PLATING		SURFACE FINISH: 63/ OR BETTER		DWG. NO. A7535-1-CF	
UNLESS OTHERWISE SPECIFIED:		ALL DIAMETERS CONCENTRIC WITHIN .005. REMOVE ALL BURRS AND SHARP EDGES		REV	
				Thursday, January 24, 2019 9:16:05 AM	