

# MPF PRODUCTS INC.

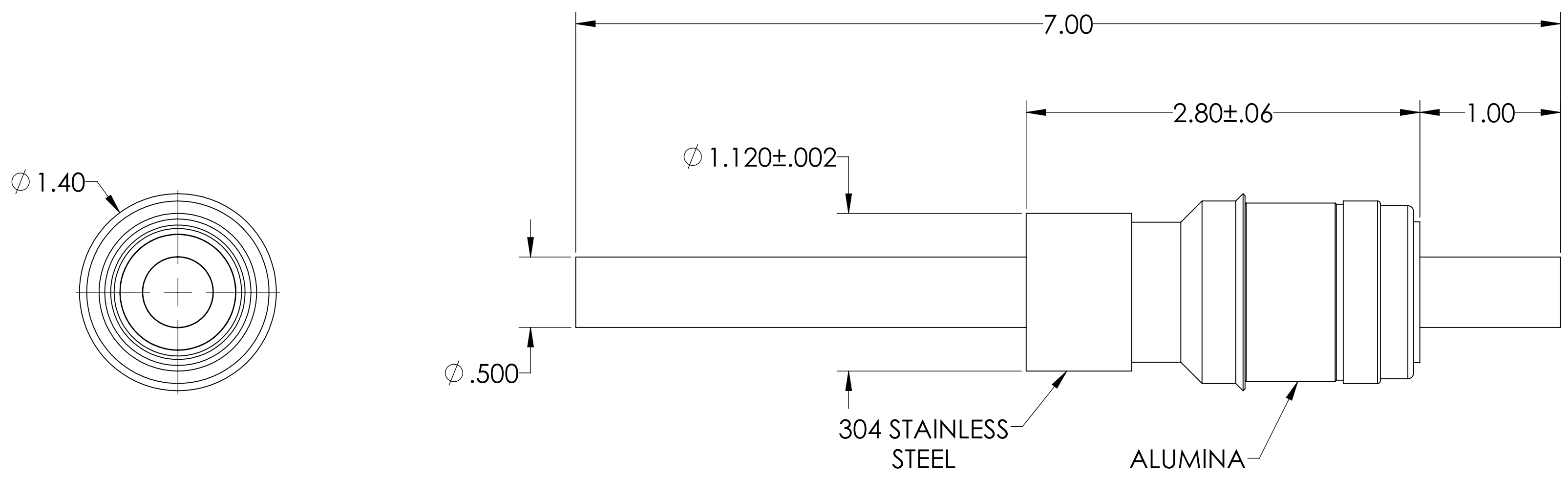
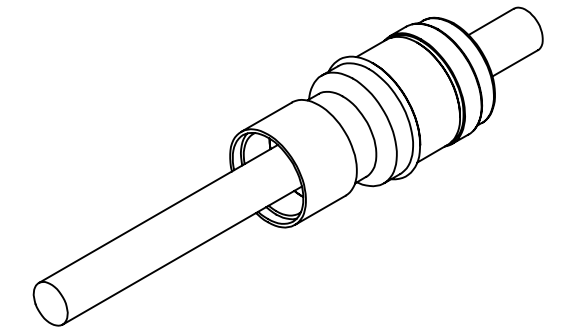

PART #	CONDUCTOR TYPE	CONDUCTOR MATERIAL	CURRENT RATING
A8205-1-W	TUBE ( .032 WALL )	304 STN STL	N/A
A8205-2-W	TUBE ( .032 WALL )	OFHC COPPER	N/A
A8205-3-W	ROD	304 STN STL	30 AMPS
A8205-4-W	ROD	NICKEL 200	140 AMPS
A8205-5-W	ROD	OFHC COPPER	450 AMPS

**NOTE:**

1. VOLTAGE: 8000 VOLTS DC
2. CURRENT: SEE TABLE
3. TEMPERATURE RATING: -100 TO 450°C

Power Feedthrough, 8000 Volts, 1 Pin, 0.500" Conductor, 1.120" Dia Stainless Steel Weld Adapter, UHV Rated, Bakeable to 450°C

UNLESS OTHERWISE SPECIFIED:		QUOTATION #		N/A		
DIMENSIONS ARE IN INCHES		NAME	DATE	<b>MPF PRODUCTS INC.</b> TITLE: POWER FEEDTHROUGH, 8000 VOLTS, 1 PIN, 1.120" WELD ADAPTER  DWG. NO. <b>A8205</b>		
TOLERANCES:		DRAWN	WJ			9/11/2015
ANGULAR: MACH ± 1/2°		CHECKED				9/11/2015
TWO PLACE DECIMAL ± .030		ENG APPR.	WJ			9/11/2015
THREE PLACE DECIMAL ± .015		THIRD ANGLE:		DOWNLOAD FROM MPFPI.COM Wednesday, December 12, 2018 9:20:01 AM		
MATERIAL						
FINISH		SURFACE FINISH: 63/ OR BETTER				
PLATING		UNLESS OTHERWISE SPECIFIED:		REV		
		ALL DIAMETERS CONCENTRIC WITHIN .005. REMOVE ALL BURRS AND SHARP EDGES				