

MPF PRODUCTS INC.

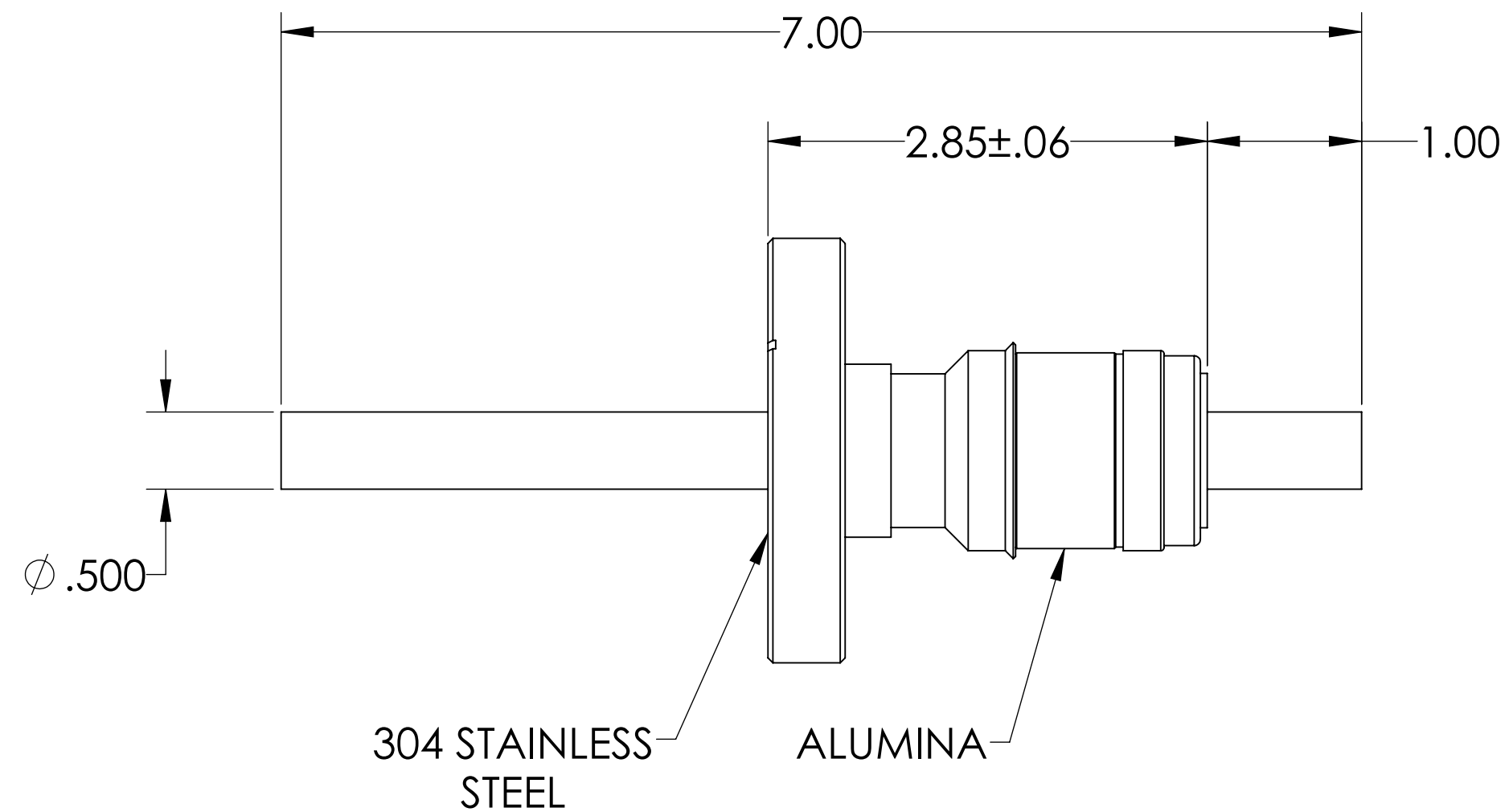
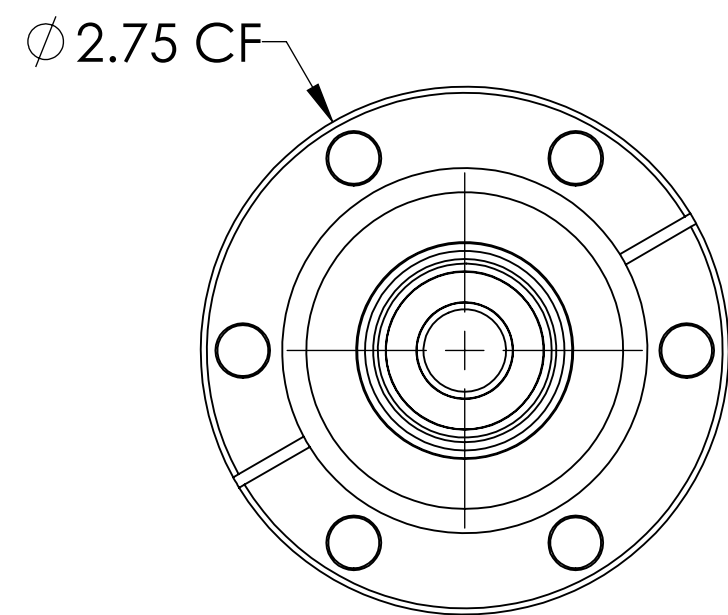
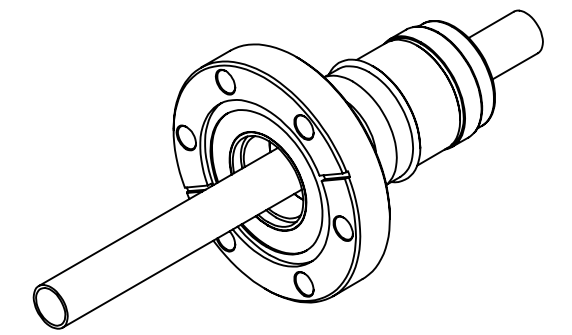

PART #	CONDUCTOR TYPE	CONDUCTOR MATERIAL	CURRENT RATING
A8206-1-CF	TUBE (.032 WALL)	304 STN STL	N/A
A8206-2-CF	TUBE (.032 WALL)	OFHC COPPER	N/A
A8206-3-CF	ROD	304 STN STL	30 AMPS
A8206-4-CF	ROD	NICKEL 200	140 AMPS
A8206-5-CF	ROD	OFHC COPPER	450 AMPS

NOTE:

1. VOLTAGE: 8000 VOLTS DC
2. CURRENT: SEE TABLE
3. TEMPERATURE RATING: -100 TO 450°C

Power Feedthrough, 8000 Volts, 1 Pin, 0.500" Conductor, 2.75" Conflat Flange, UHV Rated, Bakeable to 450°C

UNLESS OTHERWISE SPECIFIED:		QUOTATION #		N/A		
DIMENSIONS ARE IN INCHES		NAME	DATE	MPF PRODUCTS INC.		
TOLERANCES:		DRAWN	WJ			9/11/2015
ANGULAR: MACH ± 1/2°		CHECKED	WJ			9/11/2015
TWO PLACE DECIMAL ± .030		ENG APPR.	WJ			9/11/2015
THREE PLACE DECIMAL ± .015		THIRD ANGLE:		POWER FEEDTHROUGH, 8000 VOLTS, 1 PIN, 2.75" CONFLAT FLANGE		
MATERIAL		APPLICATION				
FINISH		NEXT ASSY	USED ON			
PLATING		SURFACE FINISH: 63/ OR BETTER		DOWNLOADED FROM MPFPI.COM		
		UNLESS OTHERWISE SPECIFIED:		DWG. NO. A8206		
		ALL DIAMETERS CONCENTRIC WITHIN .005. REMOVE ALL BURRS AND SHARP EDGES		REV		
				Thursday, October 3, 2019 10:17:41 AM		