

# MPF PRODUCTS INC.

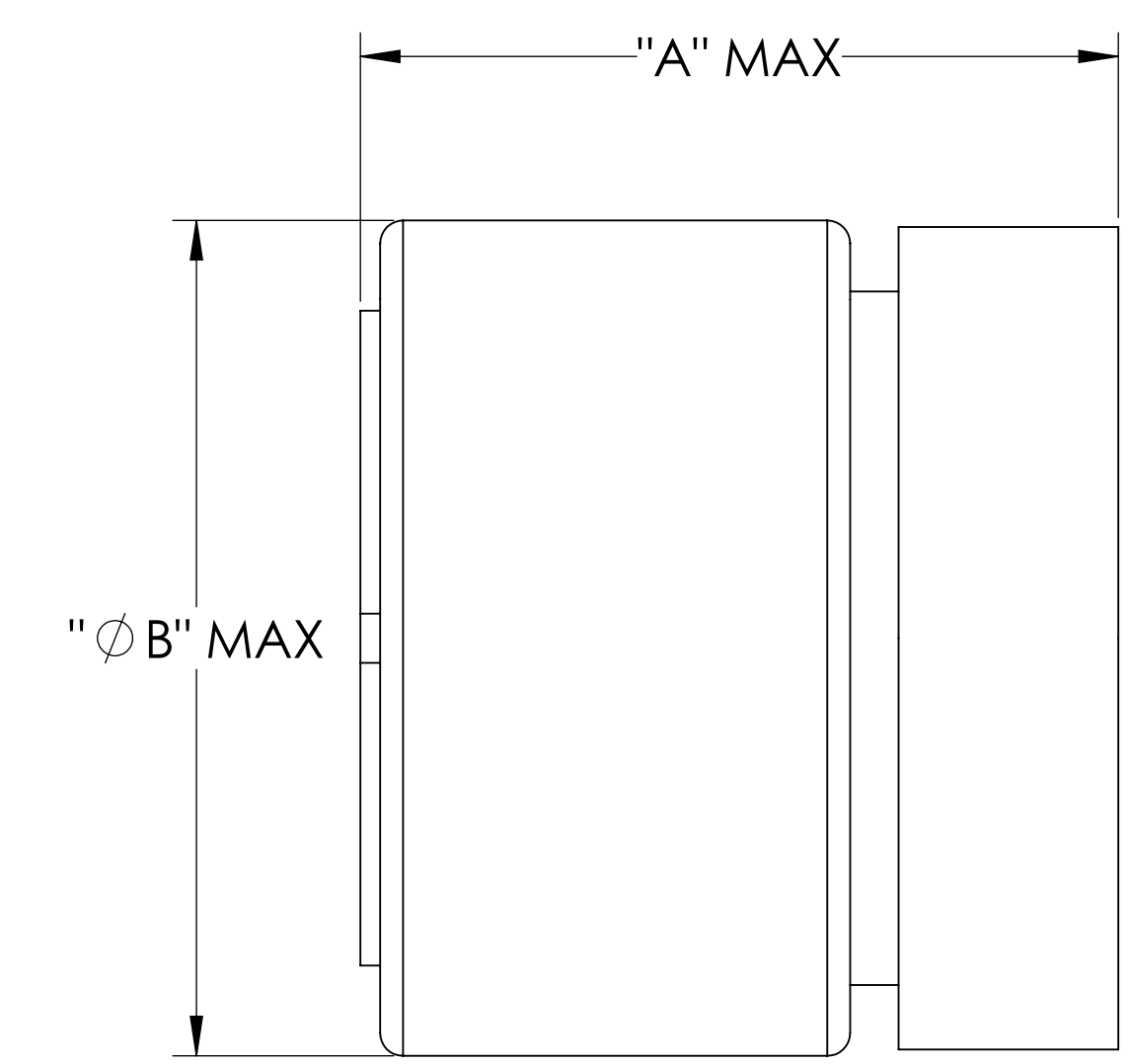
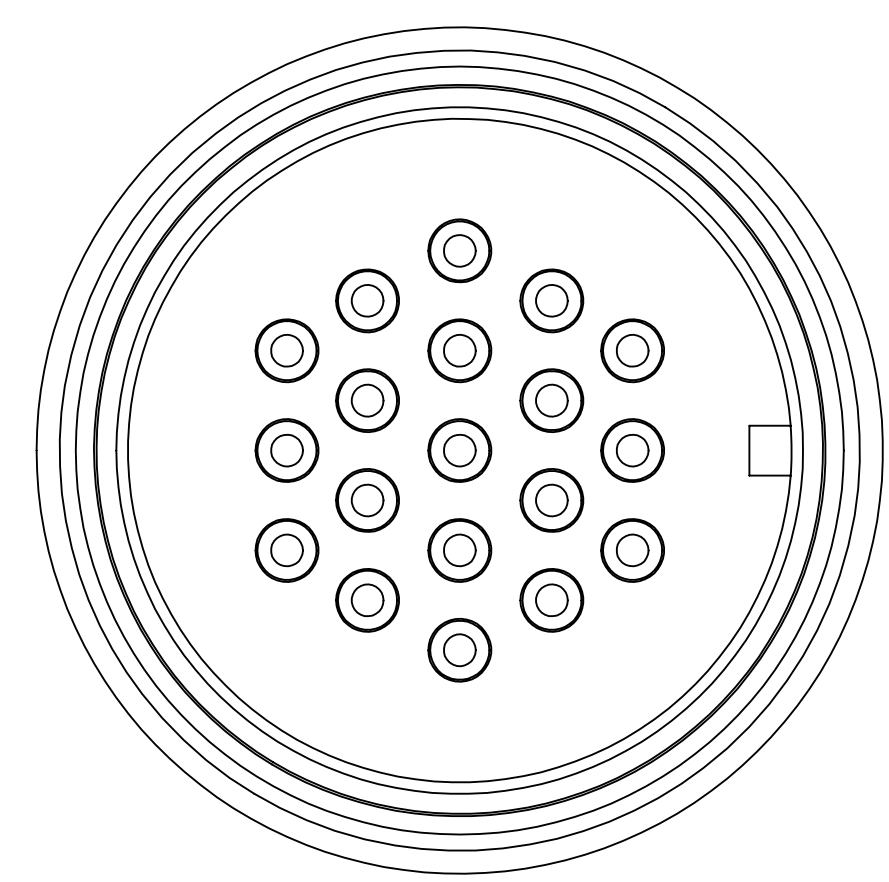
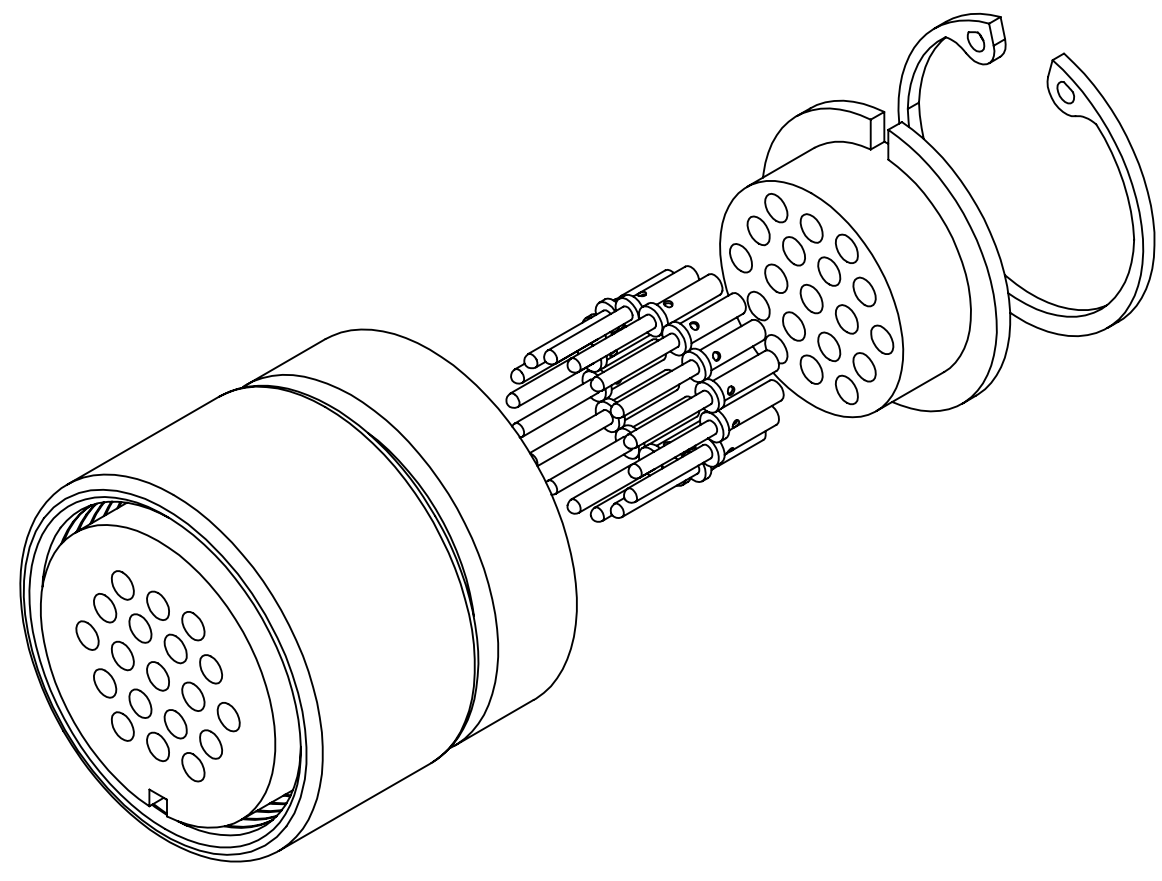

PART NUMBER	"A" DIM	"B" DIM	NUMBER OF CONTACTS	CURRENT RATING (PER PIN)
A8276-1-CN	1.0	0.8	3	5 AMPS
A8276-2-CN	1.0	0.9	6	5 AMPS
A8276-3-CN	1.0	1.0	10	5 AMPS
A8276-4-CN	1.2	1.1	19	3 AMPS
A8276-5-CN	1.4	1.4	32	3 AMPS
A8276-6-CN	1.5	1.5	41	3 AMPS

**SPECIFICATIONS:**  
 1. TEMPERATURE RATING: UP TO 125 °C

**MS Series Vacuum-side Connector, 1000 Volts**

UNLESS OTHERWISE SPECIFIED:		QUOTATION #		N/A	
DIMENSIONS ARE IN INCHES TOLERANCES:		NAME	DATE	<b>MPF PRODUCTS INC.</b>	
ANGULAR: MACH ± 1/2"		DRAWN	9/11/2015		
TWO PLACE DECIMAL ± .030		CHECKED	9/11/2015		
THREE PLACE DECIMAL ± .015		ENG APPR.	9/11/2015		
MATERIAL		THIRD ANGLE:		TITLE: <b>MS CIRCULAR CONNECTOR, 1000V</b>	
FINISH		APPLICATION		DOWNLOADED FROM MPFPI.COM	
PLATING		NEXT ASSY USED ON		DWG. NO.	
		SURFACE FINISH: 63 OR BETTER		REV	
		UNLESS OTHERWISE SPECIFIED:		A8276	
		ALL DIAMETERS CONCENTRIC WITHIN .005. REMOVE ALL BURRS AND SHARP EDGES		Friday, May 17, 2019 10:54:42 AM	