

MS Style Connector Assembly Instructions

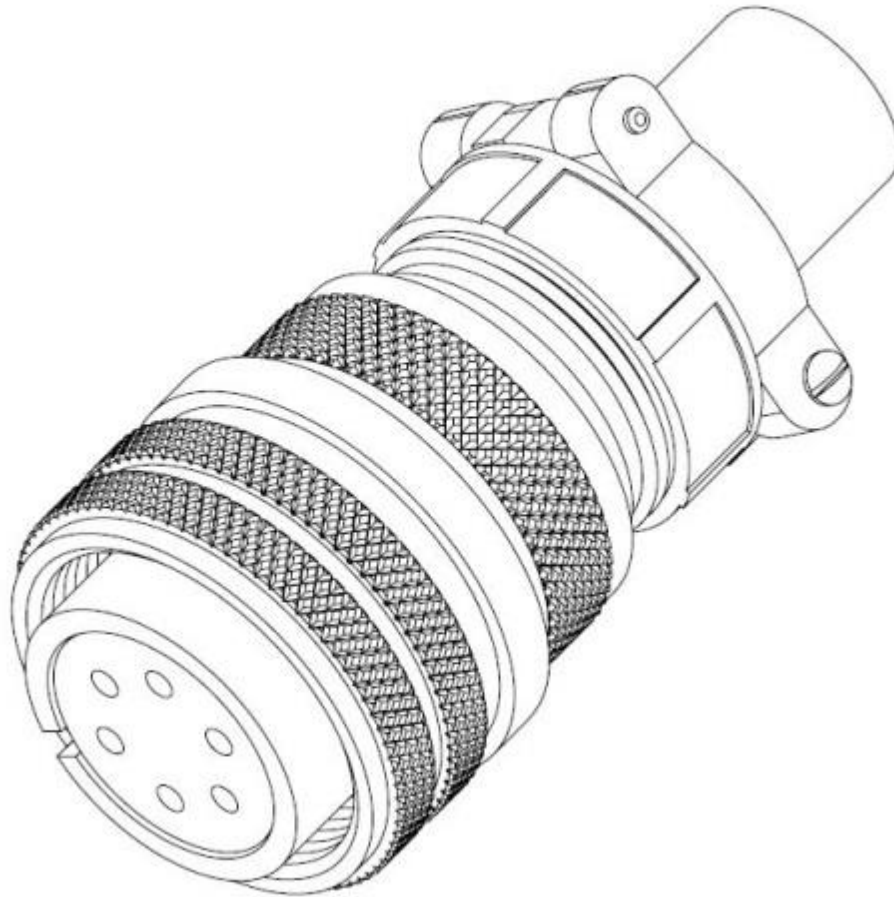

Released: August 21, 2015

Components:

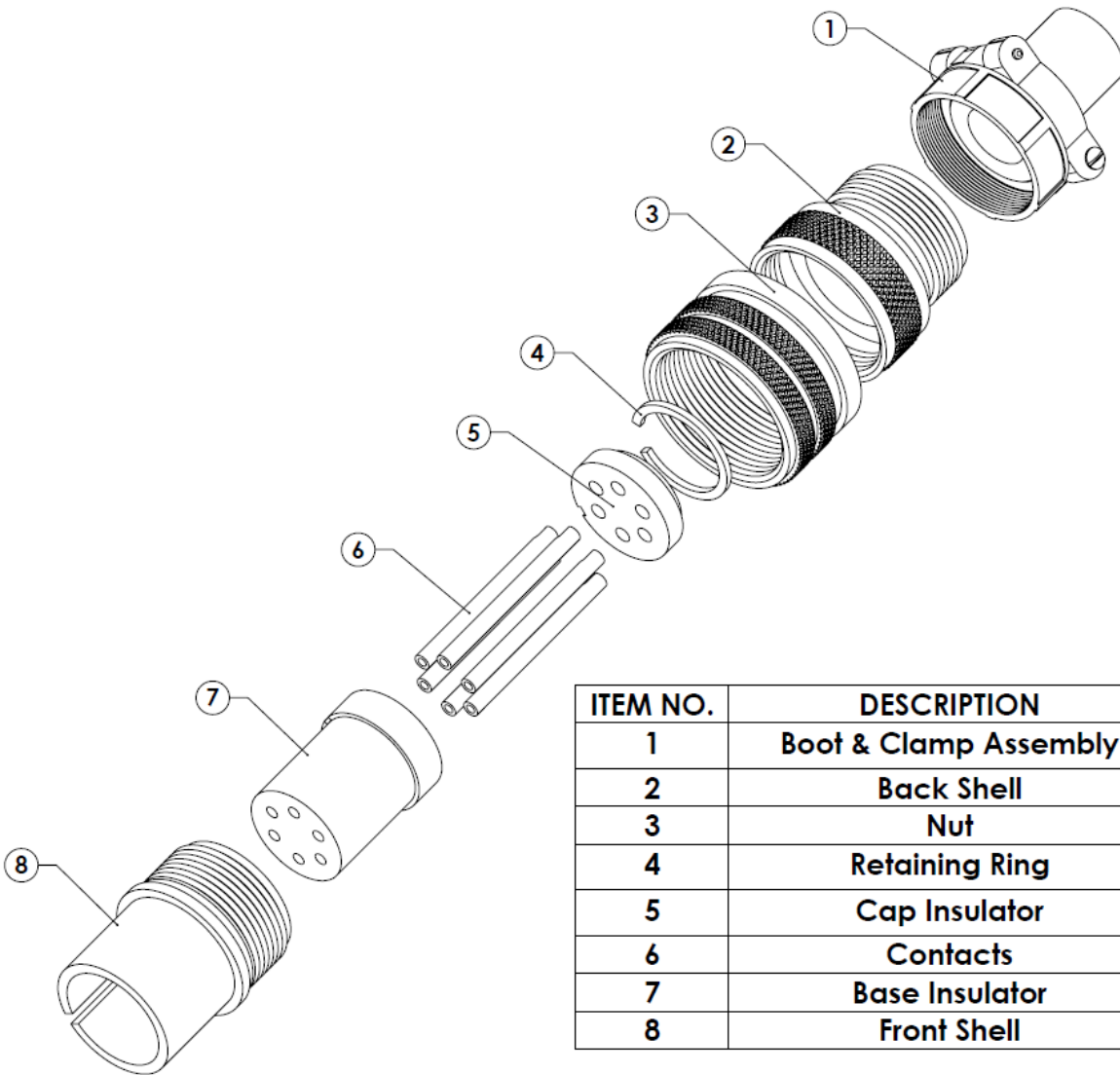

ITEM NO.	DESCRIPTION
1	Boot & Clamp Assembly
2	Back Shell
3	Nut
4	Retaining Ring
5	Cap Insulator
6	Contacts
7	Base Insulator
8	Front Shell

Tools Required:

1. Flathead Screwdriver
2. Crimp Tool or Soldering Iron
3. Hook or Pick Tool

Assembly Steps:

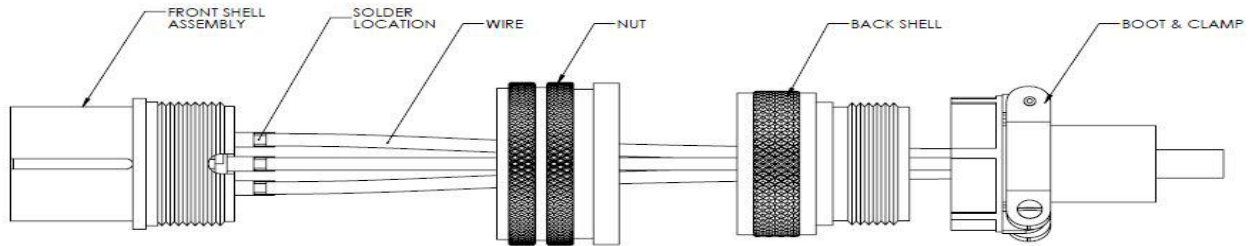

1. Unscrew the Boot & Clamp Assembly (1) from the Back Shell (2)
2. Unscrew the Back Shell (2) from the Front Shell (8) and remove the Nut (3)
3. Small sized contacts may be soldered without disassembling the Front Shell Assembly. For larger sized contacts and crimp connections, it is necessary to remove contacts before connecting wires.
4. To remove contacts:
 - a. Remove the Retaining Ring (4) using a small screwdriver or pick
 - b. Remove the Front Shell (8)
 - c. Separate Contacts (6) from the Base Insulator (7) and Cap Insulator (5)
5. Feed wires through the Boot & Clamp Assembly (1), Back Shell (2), Nut (3), and Cap Insulator (5). Double check that parts are in the correct orientation as shown.
6. Crimp or solder contact to wire. Solder cups may be pre-soldered before soldering wire.
7. Re-assemble components:
 - a. Insert wire connected Contact (6) into Base Insulator (7)
 - b. Insert Insulator assembly into the Front Shell (8)
 - c. Re-install Retaining Ring (4)
 - d. Slide Nut (3) over the Front Shell (8)
 - e. Screw the Back Shell (2) and Boot & Clamp Assembly (1)
 - f. Tighten strain relief using a flathead screwdriver

