

MPF PRODUCTS INC.

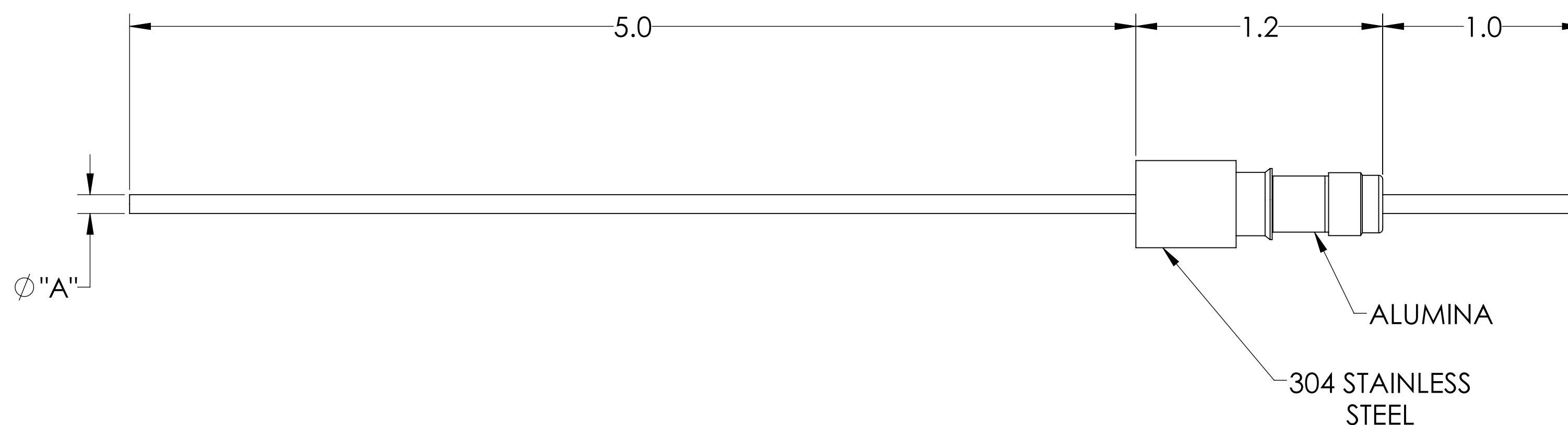
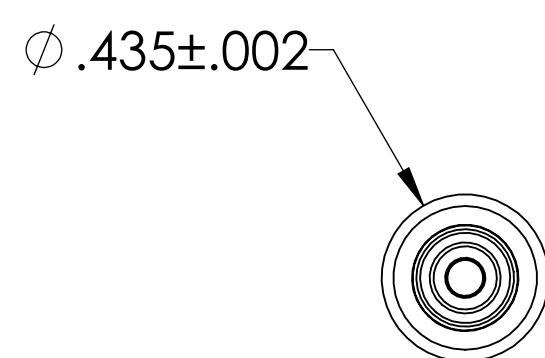
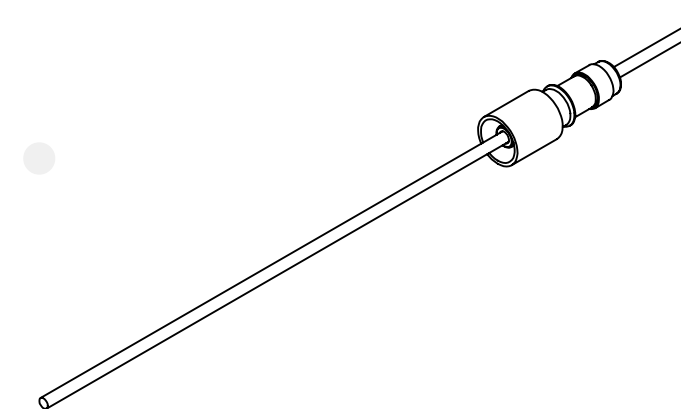

PART #	Ø"A"	CONDUCTOR MATERIAL	CURRENT RATING
A0069-1-W	.094	304 STN STL	3 AMPS
A0069-2-W	.050	304 STN STL	1 AMP
A0069-3-W	.092	NICKEL 200	15 AMPS
A0069-4-W	.050	NICKEL 200	8 AMPS
A0069-5-W	.094	OFHC COPPER	50 AMPS
A0069-6-W	.050	OFHC COPPER	25 AMPS

NOTE:

- VOLTAGE: 5000 VOLTS DC
- CURRENT: SEE TABLE
- TEMPERATURE RATING: -100 TO 450°C

Power Feedthrough, 5000 Volts, 1 Pin, 0.435" Dia Stainless Steel Weld Adapter, UHV Rated, Bakeable to 450°C

UNLESS OTHERWISE SPECIFIED:		QUOTATION #	
DIMENSIONS ARE IN INCHES TOLERANCES:		N/A	
ANGULAR: MACH ± 1/2"		NAME	DATE
TWO PLACE DECIMAL ± .030		WJ	9/11/2015
THREE PLACE DECIMAL ± .015		CHECKED	9/11/2015
		ENG APPR.	WJ 9/11/2015
MATERIAL		THIRD ANGLE:	
FINISH		APPLICATION	
PLATING		NEXT ASSY	USED ON
		SURFACE FINISH: 63 OR BETTER	
		UNLESS OTHERWISE SPECIFIED:	
		ALL DIAMETERS CONCENTRIC WITHIN .005. REMOVE ALL BURRS AND SHARP EDGES	
		TITLE:	
		POWER FEEDTHROUGH, 5000 VOLTS, 1 PIN, 0.435" WELD ADAPTER	
		DOWNLOADED FROM MPFPI.COM	
		DWG. NO.	REV
		A0069	
		Friday, January 18, 2019 11:24:21 AM	