

# MPF PRODUCTS INC.

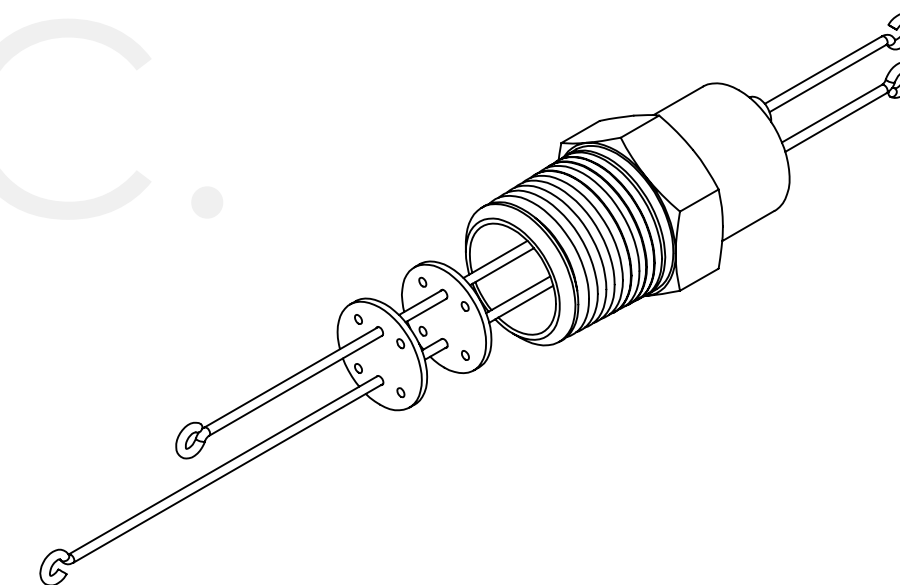

**NOTES:**

- \* TYPE T:  
CONSTANTAN CONDUCTORS HAVE A NEGATIVE POLARITY ( NON - MAGNETIC ) AND THE VACUUM SIDE ENDS ARE LONGER.  
OFHC COPPER CONDUCTORS HAVE A POSITIVE POLARITY ( NON - MAGNETIC ) AND THE VACUUM SIDE ENDS ARE SHORTER.
- \* TYPE N:  
NI-SI-MG CONDUCTORS HAVE A NEGATIVE POLARITY ( NON - MAGNETIC ) AND THE VACUUM SIDE ENDS ARE LONGER.  
NI-CR-SI CONDUCTORS HAVE A POSITIVE POLARITY ( NON - MAGNETIC ) AND THE VACUUM SIDE ENDS ARE SHORTER.
- \* TYPE R-S:  
ALLOY 11 CONDUCTORS HAVE A NEGATIVE POLARITY ( NON - MAGNETIC ) AND THE VACUUM SIDE ENDS ARE LONGER.  
OFHC COPPER CONDUCTORS HAVE A POSITIVE POLARITY ( NON - MAGNETIC ) AND THE VACUUM SIDE ENDS ARE SHORTER.

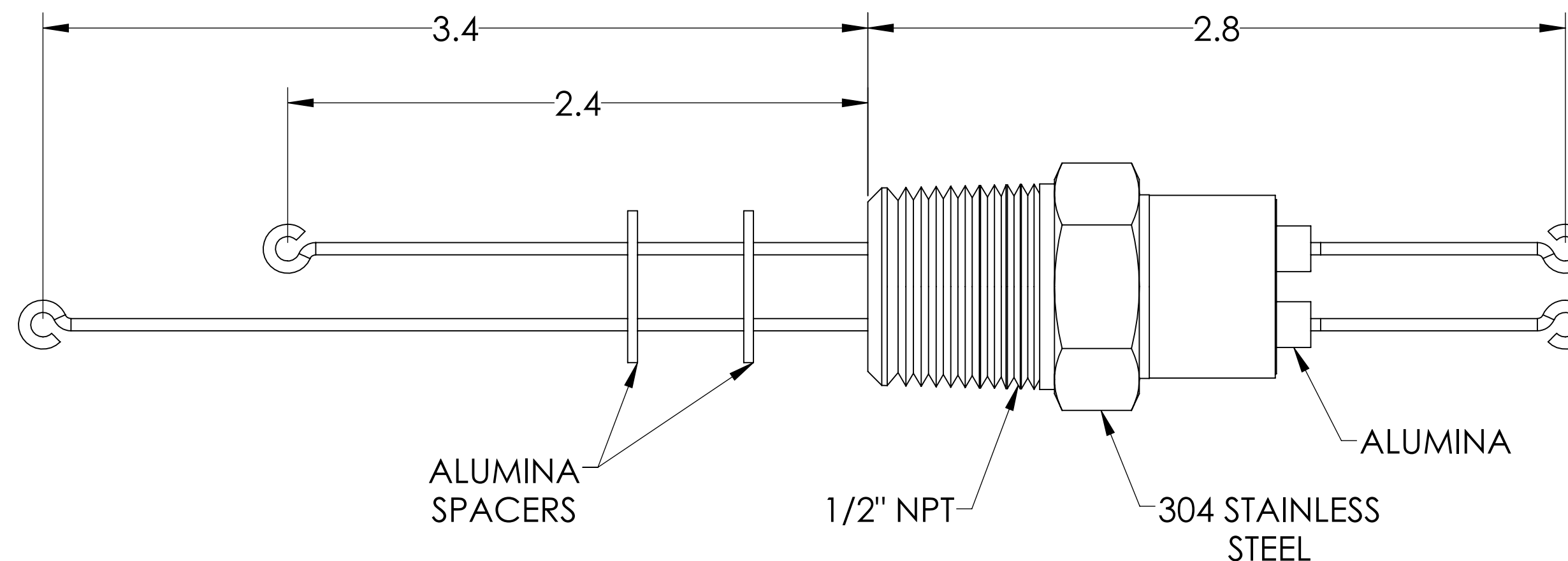
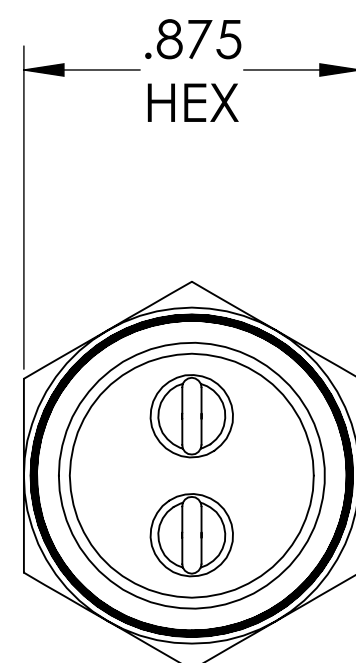

PART #	T/C TYPE
A0401-1-NPT	T
A0401-2-NPT	R-S
A0401-3-NPT	N

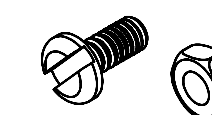

**SPECIFICATIONS:**

1. TEMPERATURE RATING: -100 TO 450°C
2. LEAK RATE < 1X10-9 ATM CC/SEC HE

Thermocouple Feedthrough, 1 Pair, Screw-type Connector, 0.5" NPT

UNLESS OTHERWISE SPECIFIED:		QUOTATION #		N/A	
DIMENSIONS ARE IN INCHES TOLERANCES:		NAME	DATE	<b>MPF PRODUCTS INC.</b>	
ANGULAR: MACH ± 1/2°		DRAWN	9/11/2015		
TWO PLACE DECIMAL ± .030		CHECKED	9/11/2015		
THREE PLACE DECIMAL ± .015		ENG APPR.	WJ 9/11/2015		
MATERIAL		THIRD ANGLE:		THERMOCOUPLE, 1 PAIR, SCREW-TYPE, 1/2" NPT	
FINISH		APPLICATION			
PLATING		NEXT ASSY USED ON			
SURFACE FINISH: 63 OR BETTER		UNLESS OTHERWISE SPECIFIED:		DOWNLOADED FROM MPFPI.COM	
ALL DIAMETERS CONCENTRIC WITHIN .005. REMOVE ALL BURRS AND SHARP EDGES		DWG. NO.		REV	
		A0401			
		Tuesday, March 26, 2019 10:22:57 AM			