

MPF PRODUCTS INC.

NOTES:

- * TYPE T:
CONSTANTAN CONDUCTORS HAVE A NEGATIVE POLARITY (NON - MAGNETIC) AND THE VACUUM SIDE ENDS ARE LONGER.
OFHC COPPER CONDUCTORS HAVE A POSITIVE POLARITY (NON - MAGNETIC) AND THE VACUUM SIDE ENDS ARE SHORTER.
- * TYPE N:
NI-SI-MG CONDUCTORS HAVE A NEGATIVE POLARITY (NON - MAGNETIC) AND THE VACUUM SIDE ENDS ARE LONGER.
NI-CR-SI CONDUCTORS HAVE A POSITIVE POLARITY (NON - MAGNETIC) AND THE VACUUM SIDE ENDS ARE SHORTER.
- * TYPE R-S:
ALLOY 11 CONDUCTORS HAVE A NEGATIVE POLARITY (NON - MAGNETIC) AND THE VACUUM SIDE ENDS ARE LONGER.
OFHC COPPER CONDUCTORS HAVE A POSITIVE POLARITY (NON - MAGNETIC) AND THE VACUUM SIDE ENDS ARE SHORTER.

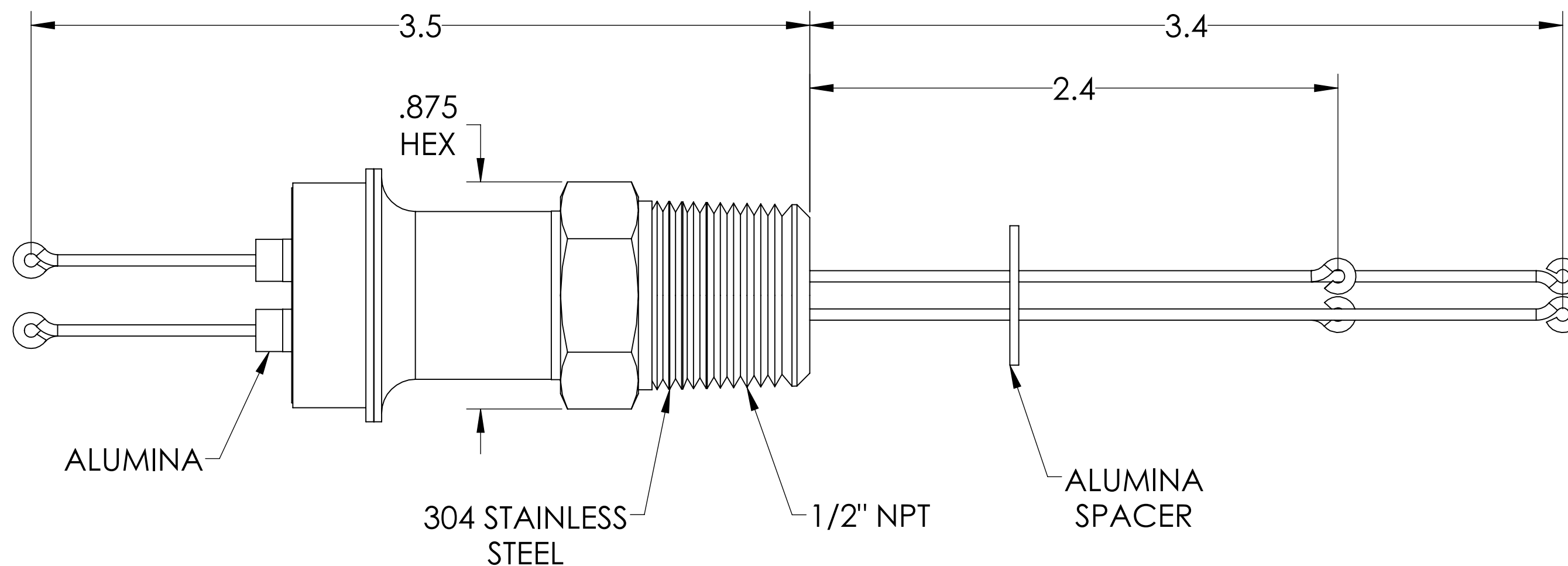
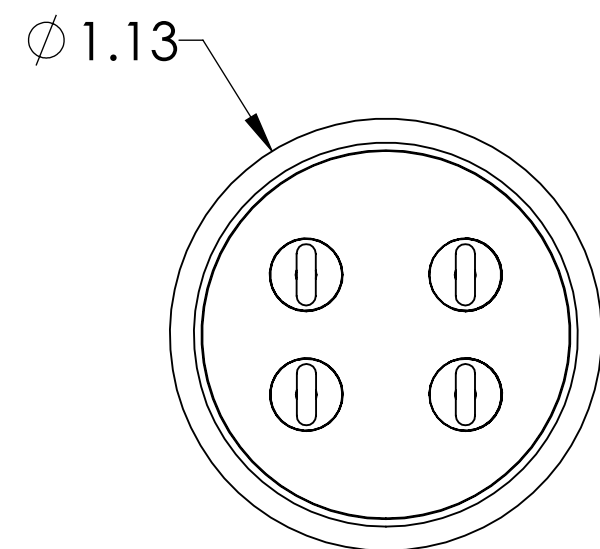
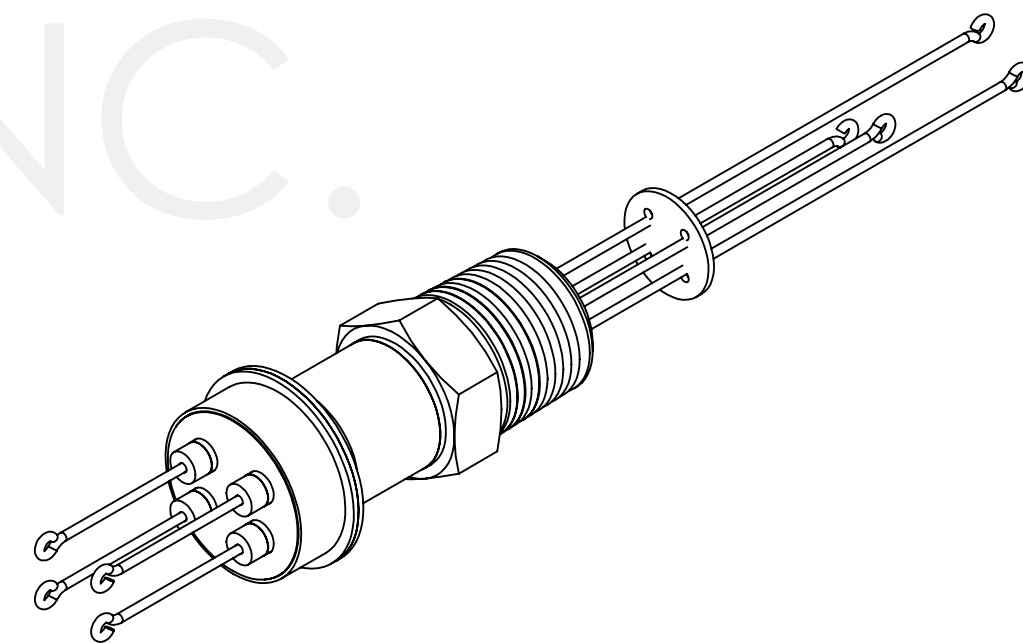

PART #	T/C TYPE
A0414-1-NPT	T
A0414-2-NPT	R-S
A0414-3-NPT	N

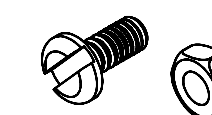

SPECIFICATIONS:

1. TEMPERATURE RATING: -100 TO 450°C
2. LEAK RATE <math>< 1 \times 10^{-9}</math> ATM CC/SEC HE

Thermocouple Feedthrough, 2 Pairs, Screw-type Connector, 0.5" NPT Fitting

UNLESS OTHERWISE SPECIFIED:		QUOTATION #		N/A		
DIMENSIONS ARE IN INCHES TOLERANCES:		NAME	DATE	MPF PRODUCTS INC. TITLE: THERMOCOUPLE, 2 PAIRS, SCREW-TYPE, 1/2" NPT		
ANGULAR: MACH $\pm 1/2^\circ$		DRAWN	WJ			9/11/2015
TWO PLACE DECIMAL $\pm .030$		CHECKED	WJ			9/11/2015
THREE PLACE DECIMAL $\pm .015$		ENG APPR.	WJ			9/11/2015
MATERIAL		THIRD ANGLE:		APPLICATION		
FINISH		SURFACE FINISH: $\sqrt{63}$ OR BETTER		NEXT ASSY		
PLATING		UNLESS OTHERWISE SPECIFIED:		USED ON		
		ALL DIAMETERS CONCENTRIC WITHIN .005. REMOVE ALL BURRS AND SHARP EDGES		DWG. NO.		
				A0414		
				REV		
				Monday, August 5, 2019 10:19:53 AM		