

MPF PRODUCTS INC.

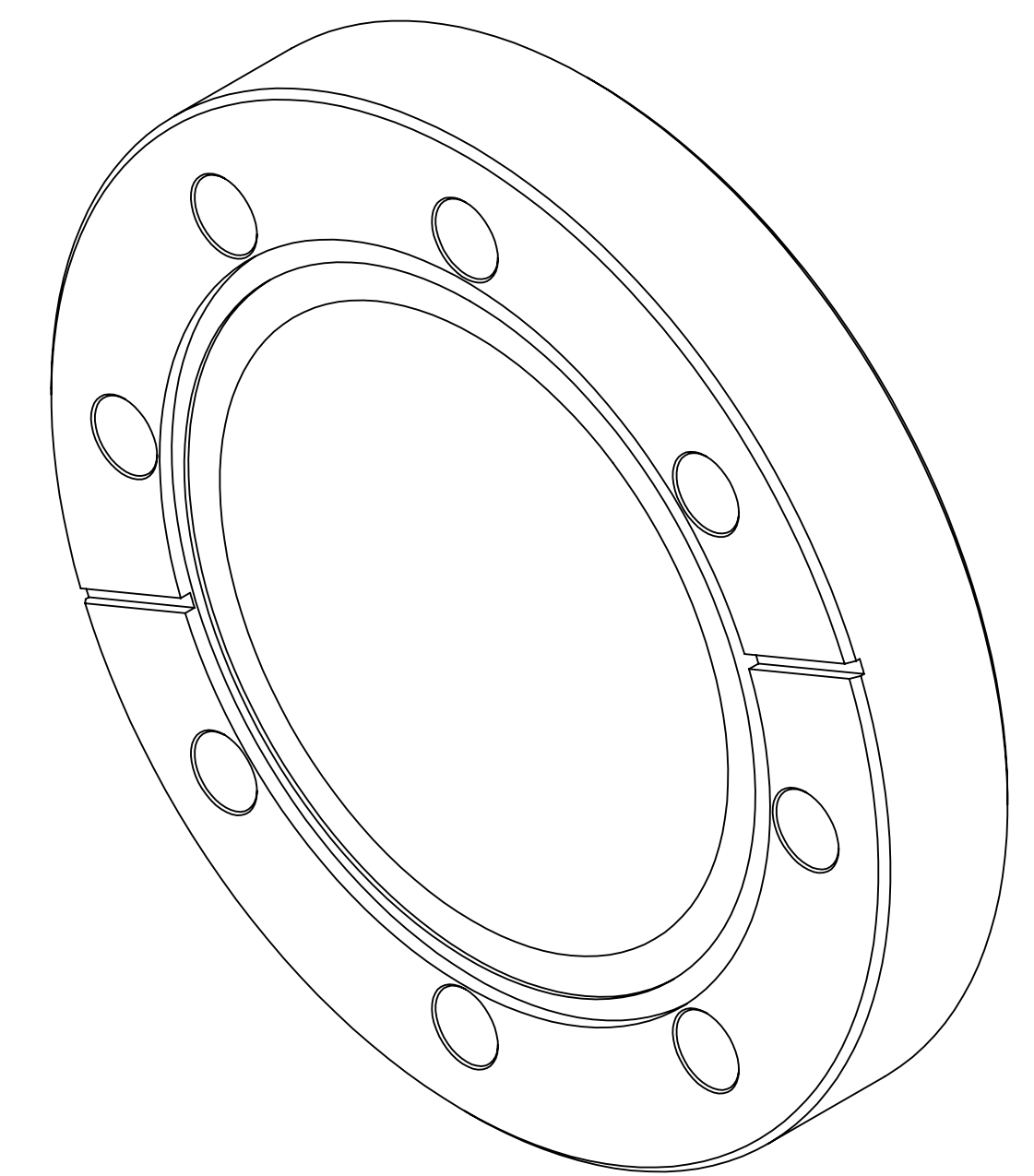
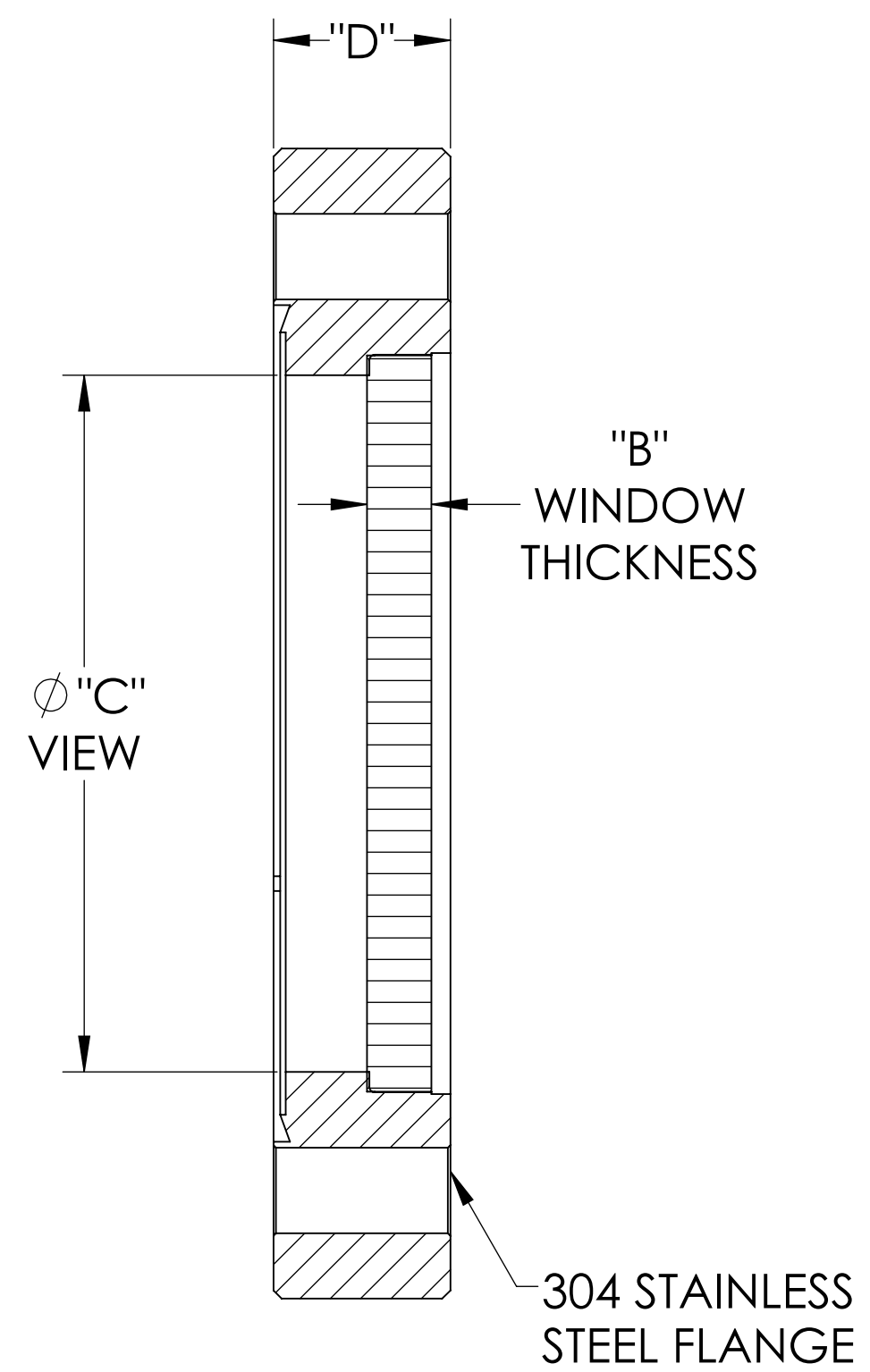
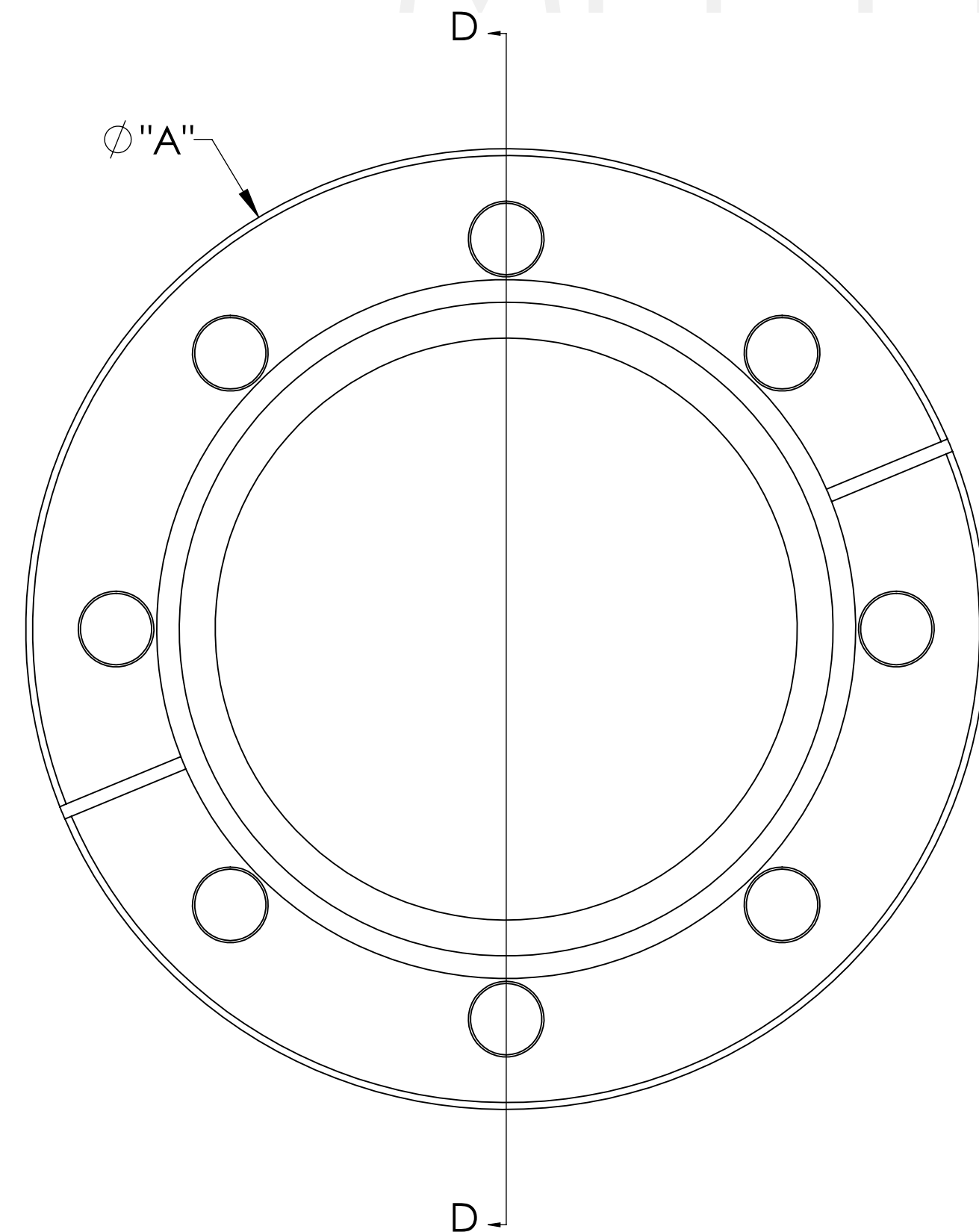

PART#	"A"	"B"	Ø"C" VIEW	"D"	SUB-ASSEMBLY	FLANGE
A20048-1	2.75	.125	1.40	.50	A0648-16	A0649-1
A20048-3	4.47	.250	2.69	.68	A0648-17	A0649-3
A20048-5	6.00	.250	3.88	.78	A0648-18	A0649-5

SPECIFICATIONS:

1. MATERIAL: CORNING 8655, LOW OH
2. TWD < 10λ @ 632NM (PEAK TO VALLEY)
3. PARALLELISM < 30 ARC MINUTES
4. SURFACE FINISH: 40/20 SCRATCH-DIG
5. THERMAL RANGE: -100 °C TO 200 °C
6. HOMOGENEITY GRADE: A
7. INCLUSION CLASS: 0
8. LEAK RATE < 1 X 10-9 ATM-CC/SEC HE

IR Grade Low OH Fused Silica Viewport, Zero Length Profile, 1.40", 2.69", 3.88" View Dia, Conflat Flange

UNLESS OTHERWISE SPECIFIED:	QUOTATION #	N/A		
DIMENSIONS ARE IN INCHES TOLERANCES:	NAME	DATE	MPF PRODUCTS INC.	
ANGULAR: MACH ± 1/2°	DRAWN	WJ		9/11/2015
TWO PLACE DECIMAL ± .030	CHECKED	WJ		9/11/2015
THREE PLACE DECIMAL ± .015	ENG APPR.	WJ		9/11/2015
MATERIAL	THIRD ANGLE:			
FINISH	APPLICATION	NEXT ASSY USED ON		
PLATING	SURFACE FINISH:	63/ OR BETTER		
	UNLESS OTHERWISE SPECIFIED:	ALL DIAMETERS CONCENTRIC WITHIN .005. REMOVE ALL BURRS AND SHARP EDGES		
	TITLE:	VIEWPORT, FUSED SILICA, LOW OH, IR GRADE CONFLAT FLANGE		
	DOWNLOADED FROM MPFPI.COM			
	DWG. NO.	A20048		
	REV			
	Friday, October 9, 2020 10:19:08 AM			