

MPF PRODUCTS INC.

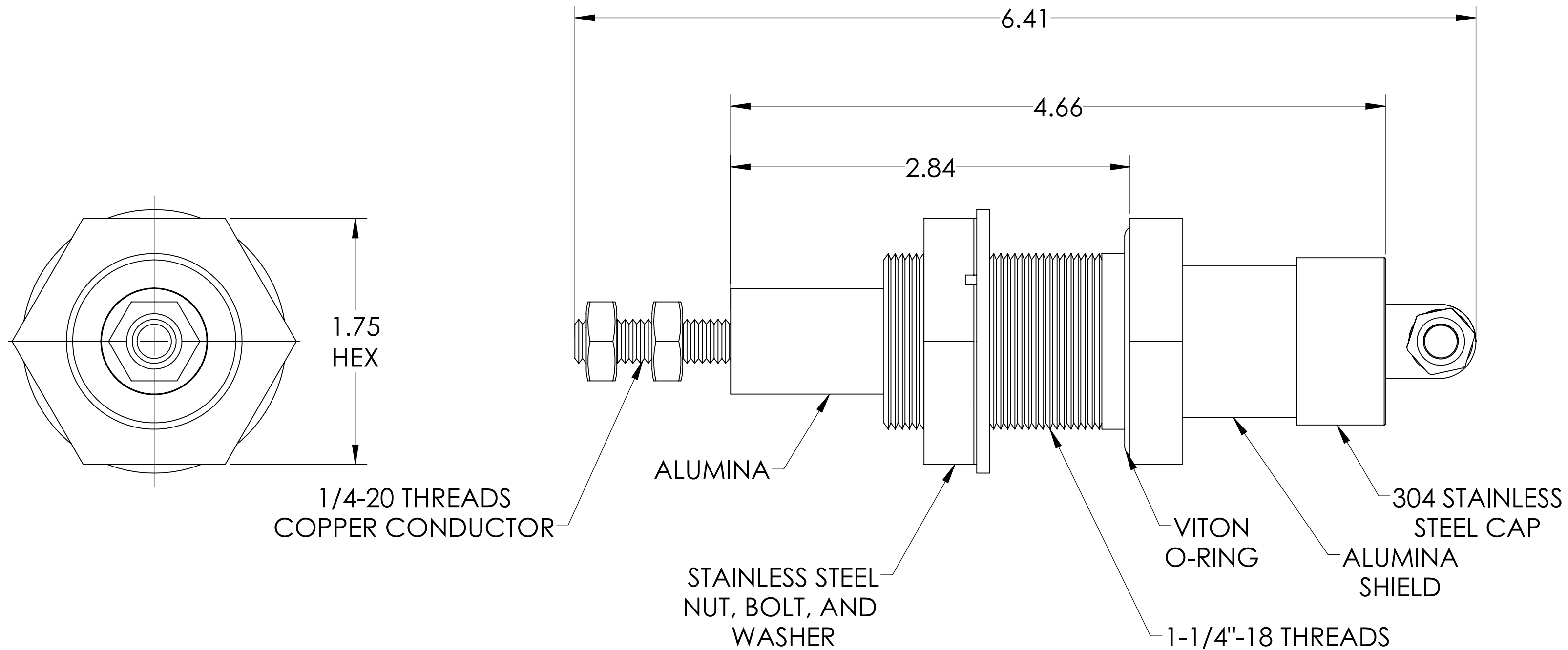
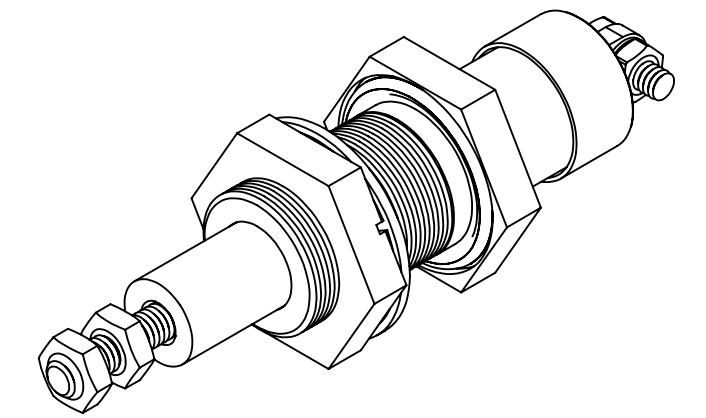

- NOTE:**
1. VOLTAGE: 12KV DC IN VACUUM
 2. CURRENT: 150 AMPS
 3. TEMPERATURE RATING: -100 TO 450°C

E-Beam Power Feedthrough, 12,000 Volts, 1 Pin, 1.25" Baseplate Bolt, UHV Rated, Bakeable to 450°C

UNLESS OTHERWISE SPECIFIED:		QUOTATION #		N/A		
DIMENSIONS ARE IN INCHES		NAME	DATE	MPF PRODUCTS INC.		
TOLERANCES:		DRAWN	WJ			9/11/2015
ANGULAR: MACH ± 1/2°		CHECKED	WJ			9/11/2015
TWO PLACE DECIMAL ± .030		ENG APPR.	WJ			9/11/2015
THREE PLACE DECIMAL ± .015		THIRD ANGLE:		TITLE: E-BEAM POWER FEEDTHROUGH, 12KV, 150A, 1 PIN, 1.25" BASEPLATE WITH SPUTTER SHIELDS DOWNLOADED FROM MPFPI.COM		
MATERIAL						
FINISH		APPLICATION NEXT ASSY USED ON				
PLATING		SURFACE FINISH: 63/ OR BETTER		DWG. NO. REV		
		UNLESS OTHERWISE SPECIFIED:		A5018-1-BP		
		ALL DIAMETERS CONCENTRIC WITHIN .005. REMOVE ALL BURRS AND SHARP EDGES		Tuesday, June 11, 2019 8:18:13 AM		