

MPF PRODUCTS INC.

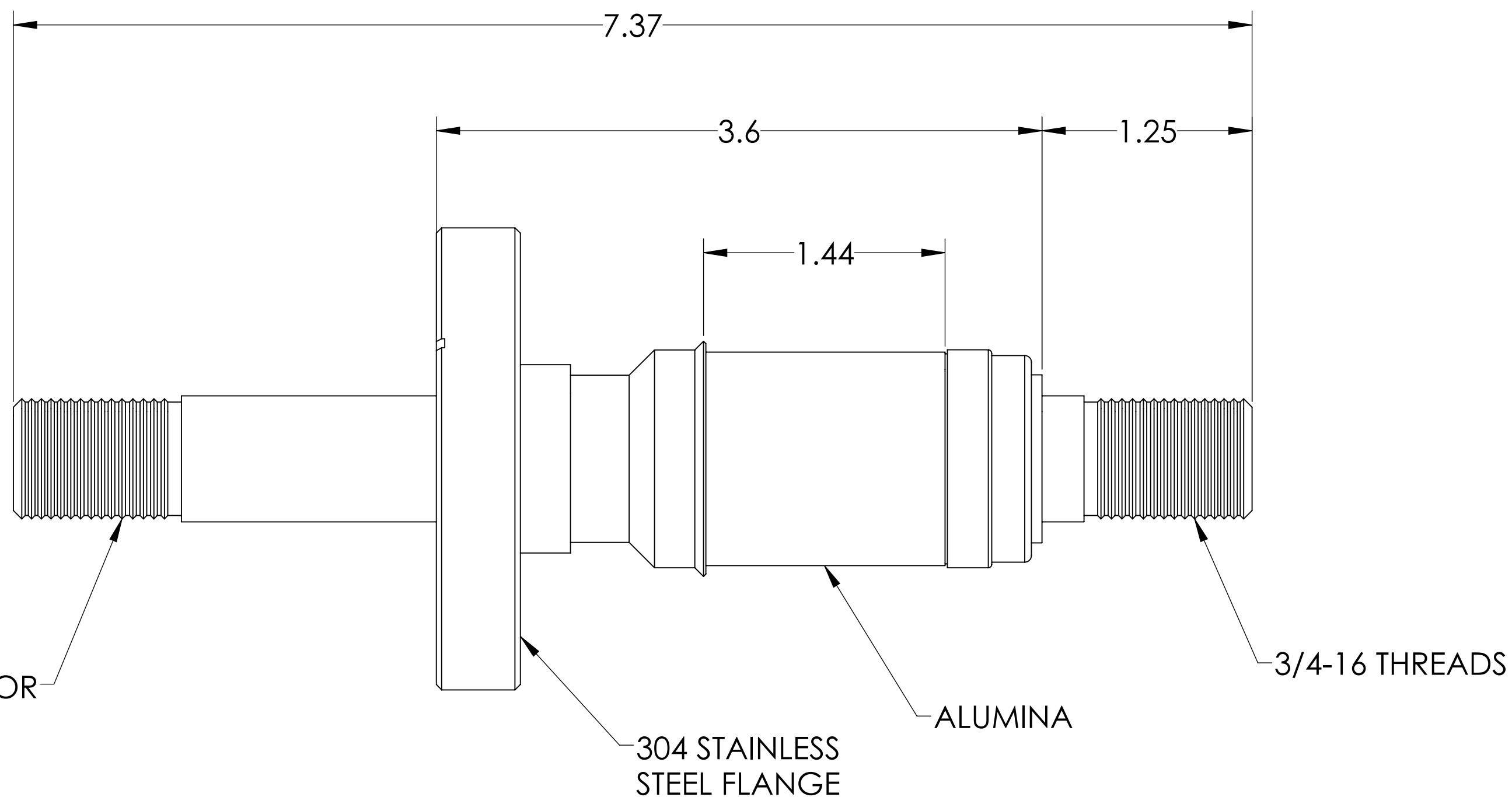
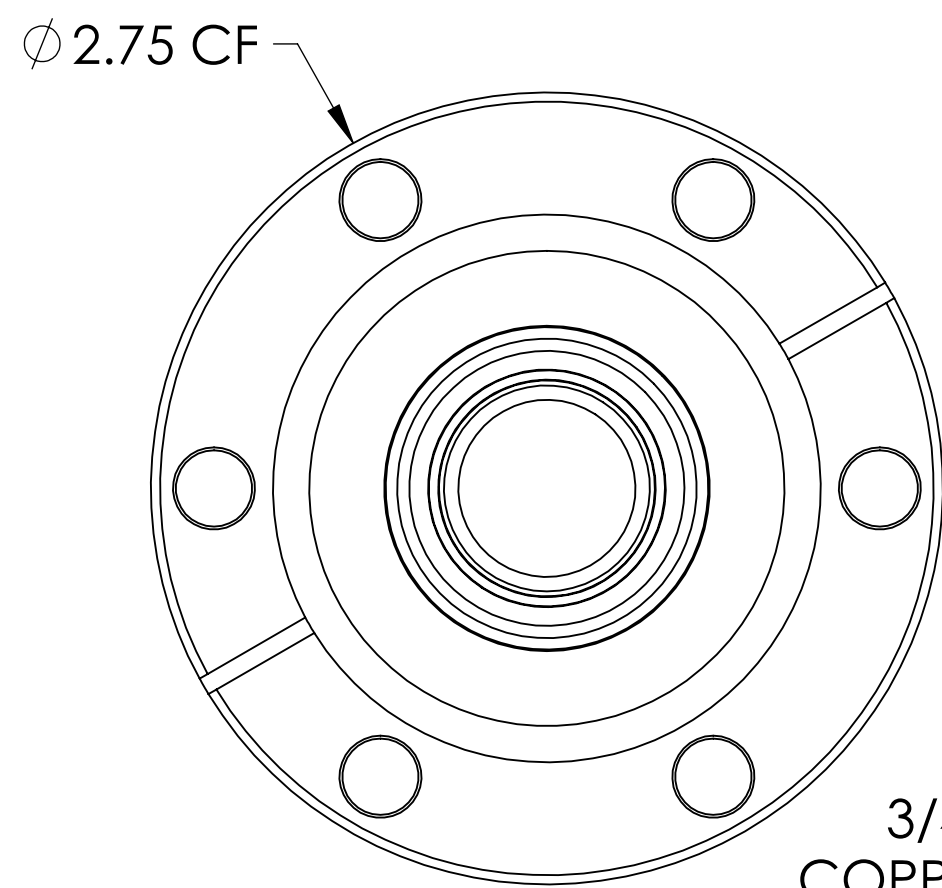
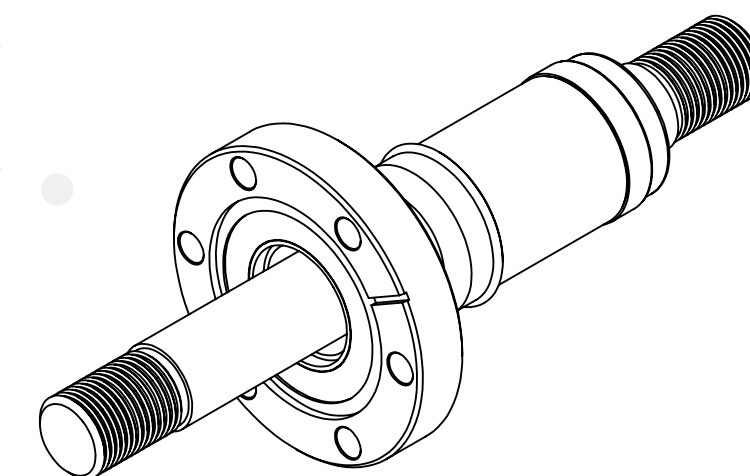

NOTE:

1. VOLTAGE: 20KV DC IN VACUUM
2. CURRENT: 750 (800) AMPS
3. TEMPERATURE RATING: -100 TO 450°C

E-Beam Power Feedthrough, 20,000 Volts, 1 Pin, O-ring Sealed, Bakeable to 450°C

UNLESS OTHERWISE SPECIFIED:		QUOTATION #		N/A	
DIMENSIONS ARE IN INCHES TOLERANCES:		NAME	DATE	MPF PRODUCTS INC.	
ANGULAR: MACH ± 1/2°		DRAWN	9/11/2015		
TWO PLACE DECIMAL ± .030		CHECKED	9/11/2015		
THREE PLACE DECIMAL ± .015		ENG APPR.	WJ 9/11/2015		
MATERIAL		THIRD ANGLE:		E-BEAM POWER FEEDTHROUGH, 20KV, 750A, 1 PIN, 2.75" CONFLAT FLANGE	
FINISH					
PLATING		APPLICATION NEXT ASSY USED ON			
SURFACE FINISH:		63/ OR BETTER		DOWNLOADED FROM MPFPI.COM	
UNLESS OTHERWISE SPECIFIED:		ALL DIAMETERS CONCENTRIC WITHIN .005. REMOVE ALL BURRS AND SHARP EDGES		DWG. NO.	REV
				A6151-1-CF	
				Tuesday, June 11, 2019 8:04:46 AM	